



4, Hythe Lane
Cambridge, CB25 0EH
£120,000

4, Hythe Lane, Cambridge, CB25 0EH

A rare opportunity to purchase a piece of land with planning permission (24/00104/FUL) for a detached property around 72 square meters and superbly located in the heart of this ever requested and highly sought after village.

Full planning permission has been approved: 24/00104/FUL



EXISTING SITE PLAN



PROPOSED SITE PLAN

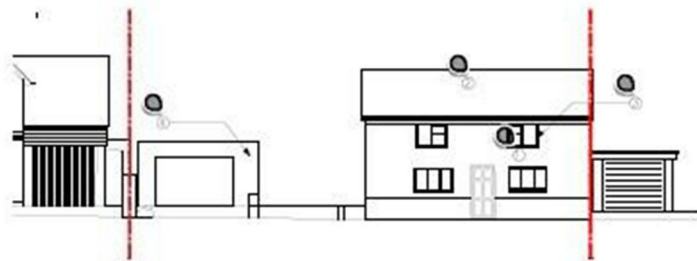

EXISTING STREET ELEVATION

KEY

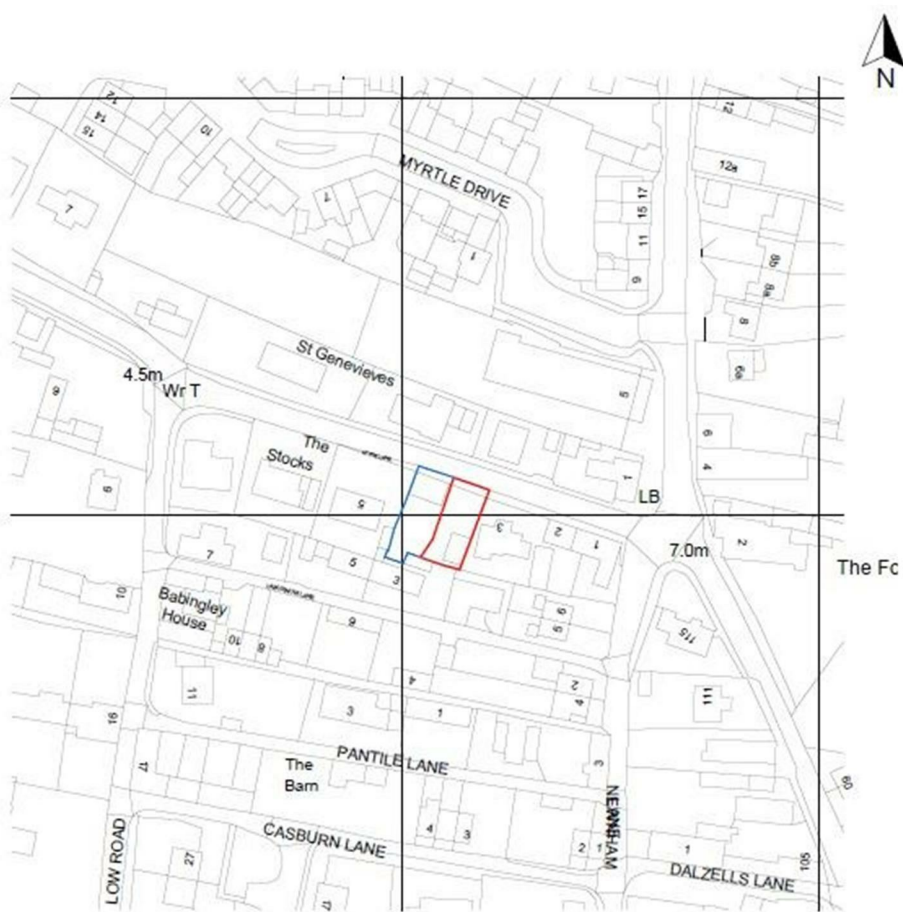

Crown Copyright and database rights 2019. OS 100031961 National Map Centre. Purchased 24/07/2019 1 year licence.



 <p>David Cousans Chartered Architect 68 High Street, Bassingbourn, Royston. SG8 5LF Tel (01763) 249738 Fax (01763) 245101</p>		
Project :	Proposed development of 2 dwellings at 4 Hythe Lane, Burwell.	Drawing : Location Plan (Plot 2)
Scale :	1:1250 @ A4	Date : Feb 2024
		Drwg No : 554 01

<p>David Cousans Chartered Architect 68 High Street, Bassingbourn, Royston. SG8 5LF Tel (01763) 249738 Fax (01763) 245101</p>	
Sheet :	Proposed development of 2 dwellings at 4 Hythe Lane, Burwell.
Drawn :	Proposed Plans, Section and Elevations (Plot 2)
Date :	1:100 & 1:250 @ A4 10th Feb 2024
Drwg No :	554 01

This document and any marketing relating to the property has been prepared in good faith to give a fair overall view of the property and must not be relied upon as statements or representations of fact. It is suggested that undertake enquiries by inspections, survey or other investigation to ascertain the viability of any purchase. Any areas, measurements or distances referred to are given as a guide only and are not precise and no liability can be accepted for errors arising from them. Photographs are not necessarily comprehensive nor current; no assumption should be made that any contents shown are included in the sale. Morris Armitage have not tested any services or equipment and nothing in these particulars should be deemed to be a statement that they are in good working order nor that the property is in good structural condition.

