

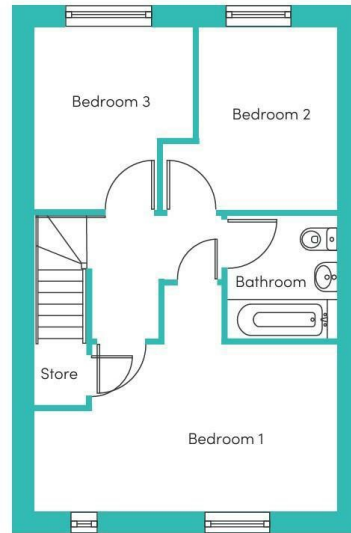

Lapwing Way | Whiteley | Fareham | PO15 7RN

**£1,575 Per Month**





Energy Efficiency Rating		
	Current	Potential
Very energy efficient - lower running costs		
(92 plus) <b>A</b>	97	97
(81-91) <b>B</b>		
(69-80) <b>C</b>		
(55-68) <b>D</b>		
(39-54) <b>E</b>		
(21-38) <b>F</b>		
(1-20) <b>G</b>		
Not energy efficient - higher running costs		
England & Wales	EU Directive 2002/91/EC	

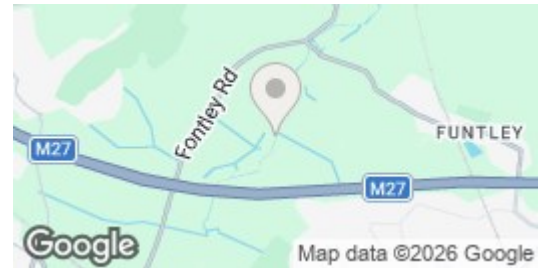

## Description

W&W are delighted to offer for rent this brand new (Rendlesham) three bedroom end of terrace house. The property boasts three bedrooms, an impressively kitchen/dining room, lounge and downstairs cloakroom, and a modern family bathroom. The property also benefits from 'in our opinion' a good sized rear garden and allocated parking. Pets are considered at this property on an individual basis.

## Key features

- Dishwasher
- Washing/Drying Machine
- Fridge/Freezer
- Security Alarm



H3 Whiteley Shopping Centre  
 Whiteley Way  
 Whiteley  
 Hants  
 PO15 7PD  
 01489 580800  
 pm@walkerwaterer.co.uk  
 www.walkerwaterer.co.uk