



## 49 Abbots Walk

Wye Ashford, TN25 5ES

Price £380,000

Enjoying fabulous views to the rear across open countryside, this spacious terraced home is offered for sale with no onward chain.

The well appointed accommodation would benefit from some modernisation and comprises an entrance hall, sitting room, dining room, kitchen, three bedrooms and bathroom/WC.

Wye mainline station is only a few minutes walk away as are convenient village shops, schools and many delightful countryside walks.

- WELL APPOINTED TERRACED HOME
- THREE BEDROOMS
- VIEWS ACROSS FIELDS TO REAR
- TWO RECEPTION ROOMS
- GENEROUS REAR GARDEN
- CENTRAL VILLAGE LOCATION
- SHORT WALK FROM MAINLINE STATION, SCHOOLS AND SHOPS
- NO ONWARD CHAIN

### Viewing

Please contact our Ashford Office on 01233 646411 if you wish to arrange a viewing appointment for this property or require further information.





Floor Plan

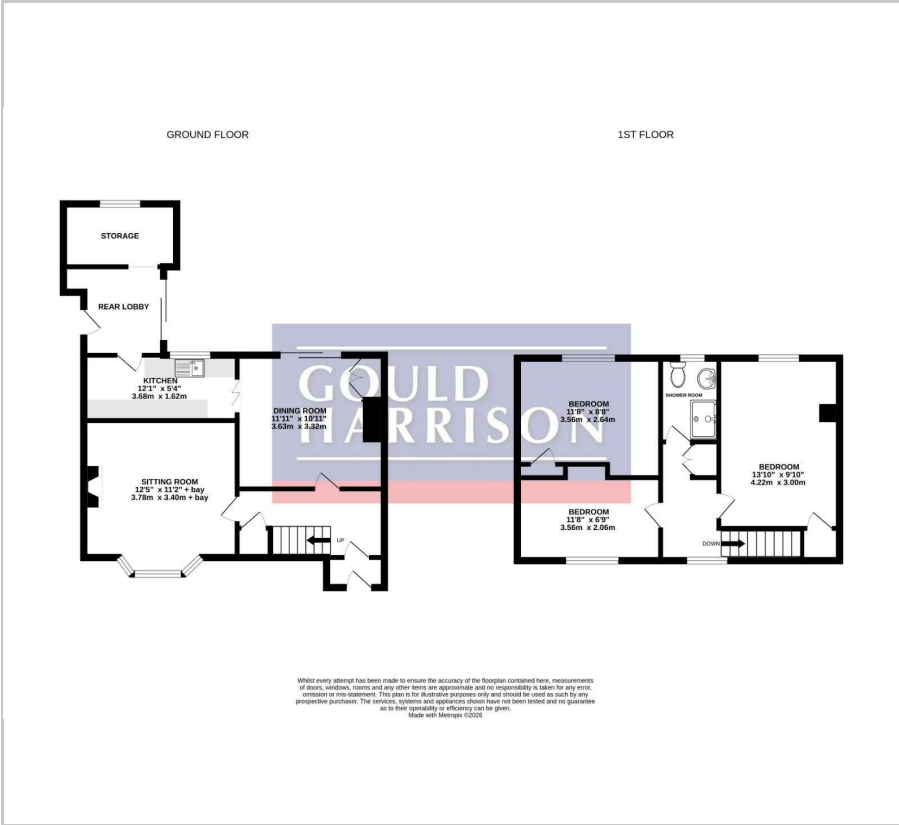

Area Map



Energy Efficiency Graph

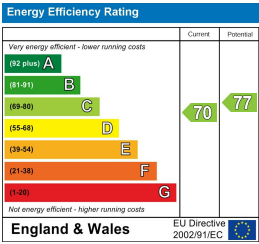

These particulars, whilst believed to be accurate are set out as a general outline only for guidance and do not constitute any part of an offer or contract. Intending purchasers should not rely on them as statements of representation of fact, but must satisfy themselves by inspection or otherwise as to their accuracy. No person in this firms employment has the authority to make or give any representation or warranty in respect of the property.