



 Steven Oates

Newland Gardens, Hertford  
**£1,800 pcm**

Steven Oates are pleased to offer this immaculate two double bedroom apartment in the popular Newland Gardens development. This modern apartment consists of two double bedrooms, two bathrooms, large and bright living room/diner, allocated underground parking and use of the residents fitness suite. Situated conveniently for the town centre, Hertford East station and the rest of Hertford's amenities. Internal viewing is highly recommended to fully appreciate the finish of this luxury apartment. Available early June 2026. Offered part-furnished





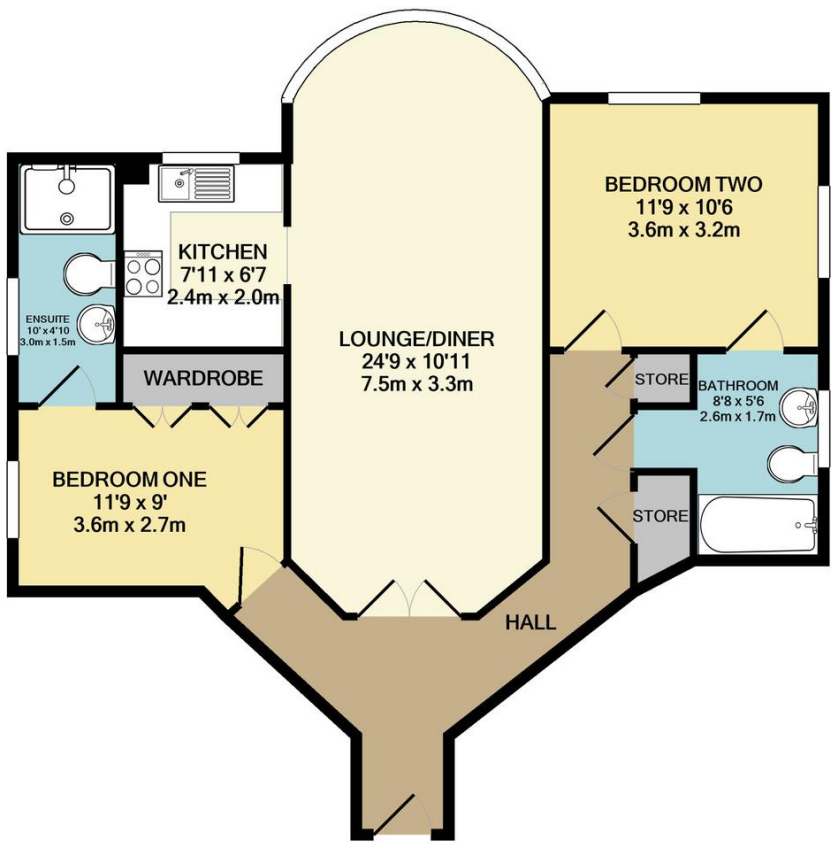

Score	Energy rating	Current	Potential
92+	A		
81-91	B		84 B
69-80	C	78 C	
55-68	D		
39-54	E		
21-38	F		
1-20	G		

Whilst every attempt has been made to ensure the accuracy of the floor plan contained here, measurements of doors, windows, rooms and any other items are approximate and no responsibility is taken for any error, omission, or mis-statement. This plan is for illustrative purposes only and should be used as such by any prospective purchaser. The services, systems and appliances shown have not been tested and no guarantee as to their operability or efficiency can be given.





Whilst we endeavour to make our sales particulars fair, accurate and reliable, they are only intended as a general guide to the property. Measurements and distances are approximate. These particulars do not form part of any offer or contract. If there are important matters that are likely to affect your decision to buy, please contact us before viewing the property. Please note that we have not tested the services, equipment or appliances in this property, accordingly, we advise prospective buyers to commission their own survey or service reports before finalising any offer to purchase.