



## Sea Fleet

Chickerell Road | Weymouth | Dorset | DT4 9TP

**£220,000**

BEAUMONT  JONES

# Sea Fleet

Chickerell Road | Weymouth

Dorset | DT4 9TP

£220,000

We are delighted to offer an immaculate and modern two bedroom terraced home boasting a large open plan living area. This perfect first time purchase is conveniently located close to local amenities and well-regarded schools. The property offers an entrance porch, spacious open plan living/kitchen/diner, two good sized bedrooms, modern bathroom and an enclosed low maintenance rear garden. This property must be viewed to be appreciated.

- Two Double Bedroom Home
- Open Plan Living Accommodation
- Close to Local Amenities and Walks Over the Fleet
- Perfect First Time Purchase
- Charming Converted Cottage
- Immaculately Presented with Spotlights Throughout

## Full Description

Entrance into this charming home is via the composite front door which opens into a welcoming porch with a storage cupboard and an opening into the open plan living area. This lovely space is split into sections with the dining area offering a front aspect double glazed window and ample space for a dining table and chairs. The living room area is a generous size with plenty of space for dining furniture as well as glass balustrades on the stair case that rises to the first



Immaculately presented throughout makes this the perfect first time purchase.



floor landing. The living room flows into the modern kitchen, comprising a range of eye and base level units with work surfaces over, integral appliances include a fridge freezer, washing machine, oven with four ring electric hob and extractor fan over. The wall mounted combination boiler is within a cupboard, double glazed double doors open onto the rear garden.



The first floor landing is a generous size with glass balustrades allowing light to flood through, access to loft via the hatch and doors lead to the remaining accommodation. The master bedroom is a good sized double with a front aspect double glazed window, wall mounted radiator and plenty of space for bedroom furniture. Bedroom two is a further good sized room with a rear aspect double glazed window, this room is currently set up with a single bed, desk and wardrobe. The bathroom has partially tiled walls, WC, vanity wash hand basin, heated towel rail, P shape bath, wall mounted mixer shower with fountain attachment over.



Outside there is an enclosed and private rear garden with patio area abutting the property creating the perfect space for a table and chairs. Raised planted borders with pretty flowers and mature shrubs, hard standing for shed and bin store. There is useful rear access leading onto Alexandra Road.





The property sits within the popular residential area of Charlestown. Good local schools including Budmouth Academy, amenities and a regular bus service are all close by making this the ideal family home/first time purchase. Viewing is a must to be appreciated.

Rating Authority: Dorset (Weymouth & Portland) Council. Council Tax Band B. Services: Mains gas, electric & drainage.

Disclaimer: - Beaumont Jones and their clients have no authority to make or give any representations or warranties in relation to the property. These particulars do not form part of any offer or contract and must not be relied upon as statements or representations of fact. Any areas, measurements or distances are approximate. The text, photographs, plans and measurements are for guidance only and are not necessarily comprehensive. It should be assumed that the property has all necessary Planning, Building Regulations or other consents, and Beaumont Jones have not tested any services, equipment or facilities. Beaumont Jones is a member of The Property Ombudsman scheme and subscribe to The Property Ombudsman Code of Practice



The property is conveniently located close to local amenities and well-regarded schools. Viewing is a must to be appreciated.



Energy Efficiency Rating		
	Current	Potential
Very energy efficient - lower running costs		
(92 plus) <b>A</b>		<b>94</b>
(81-91) <b>B</b>		
(69-80) <b>C</b>	<b>78</b>	
(55-68) <b>D</b>		
(39-54) <b>E</b>		
(21-38) <b>F</b>		
(1-20) <b>G</b>		
Not energy efficient - higher running costs		
<b>England &amp; Wales</b>	EU Directive 2002/91/EC	

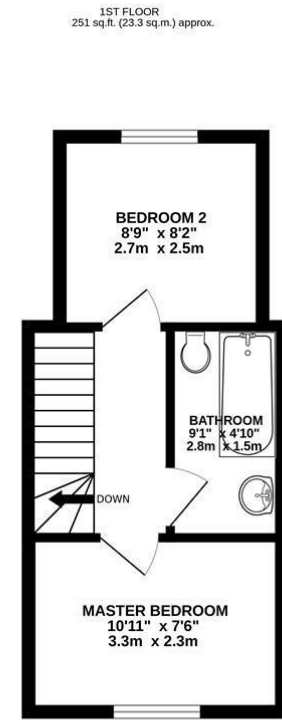
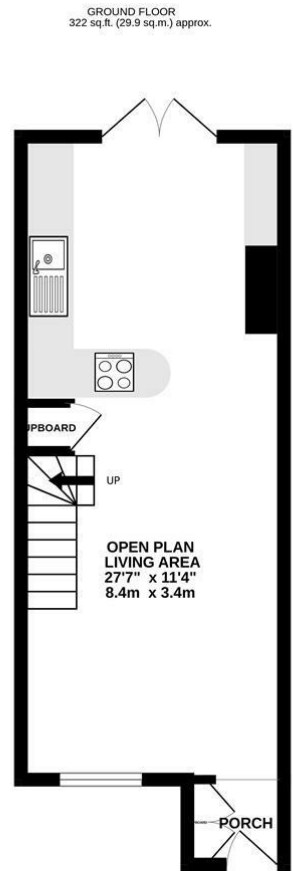

TOTAL FLOOR AREA: 573 sq.ft. (53.2 sq.m.) approx.

Whilst every attempt has been made to ensure the accuracy of the floorplan contained here, measurements of doors, windows, rooms and any other items are approximate and no responsibility is taken for any error, omission or mis-statement. This plan is for illustrative purposes only and should be used as such by any prospective purchaser. The services, systems and appliances shown have not been tested and no guarantee as to their operability or efficiency can be given.

Made with Metropix ©2026

*We value more than your property*

33 St Thomas Street  
Weymouth  
Dorset  
DT4 8EJ  
01305 787434  
sales@beaumontjones.co.uk  
www.beaumontjones.co.uk