

Russell Road, CR4

£500,000

A first floor, three double bedroom apartment with a spacious balcony and an allocated parking space. There is a high emphasis on energy efficient throughout including underfloor heating, new gas boilers and Aluminium double glazed windows. There is also a share of the freehold, long lease and no chain.

*Images may be of another flat within the same development for representative purposes *

Century House is a small boutique development of just nine apartments, all with a share of the freehold. Tucked away on Russell Road, with Wimbledon and Tooting nearby by car. The wide green open spaces of Mitcham Common is also just a short walk away with it's open grassy space, wooded areas and ponds, plus various trails for walking and running.

Features

- Three Bedrooms
- Two Bathrooms
- Allocated Parking Space
- Underfloor Heating
- Energy Efficient Boiler
- Share Of The Freehold
- Quartz Worktops
- Modern Kitchens
- Bosch Oven & Hob

Russell Road, Mitcham, CR4

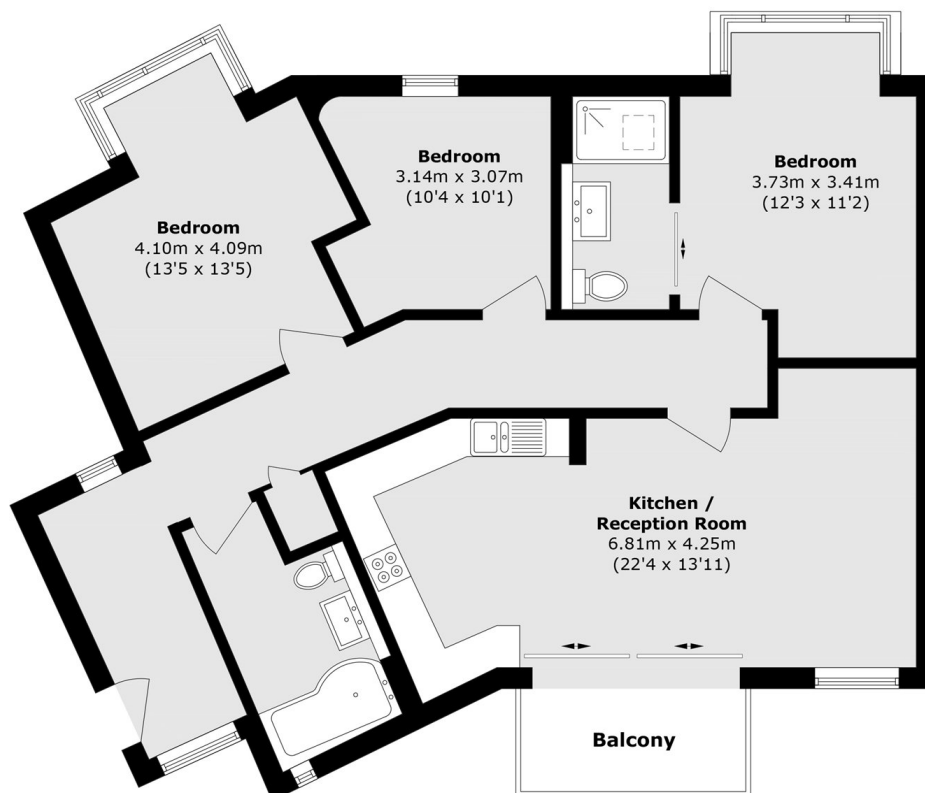

Total area (approx.): 102.7 sq. m (1105.4 sq. ft)
Balcony area (approx.): 4.7 sq. m (50.5 sq. ft)