



Coventry Close, Peterborough
£270,000 Freehold

**Sharman
Quinney**

Key Features



- Three Bedrooms
- Lounge/Diner
- Extended Kitchen/Diner
- Off Road Parking
- Enclosed Rear Garden

GROUND FLOOR

ENTRANCE HALL: UPVC Double glazed entrance door. Double glazed window to front. Radiator. Built in under stairs cupboard. Stairs to first floor.

LOUNGE/DINER: Double glazed window to front. Patio doors to rear. Two radiators. Feature fireplace with inset gas fire.

KITCHEN/DINER: Double glazed window and patio door. Fitted with a range of base and wall units. Sink and drainer with mixer tap.

FIRST FLOOR

LANDING: Loft access.



BEDROOM: Double glazed window to front.
Radiator. Fitted wardrobes.

BEDROOM: Double glazed window to rear.
Radiator.

BEDROOM: Double glazed window to front.
Radiator.

SHOWER ROOM: Double glazed frosted window
to rear. Low level WC. Wash hand basin. Walk
in shower with wall mounted electric shower.
Built in cupboard housing wall mounted boiler.

OUTSIDE

FRONT: Driveway providing off road parking.
Laid to lawn area with shrubs.

REAR GARDEN: Enclosed by hedging. Patio and
decorative gravel areas. Laid to lawn area.
Garden shed.



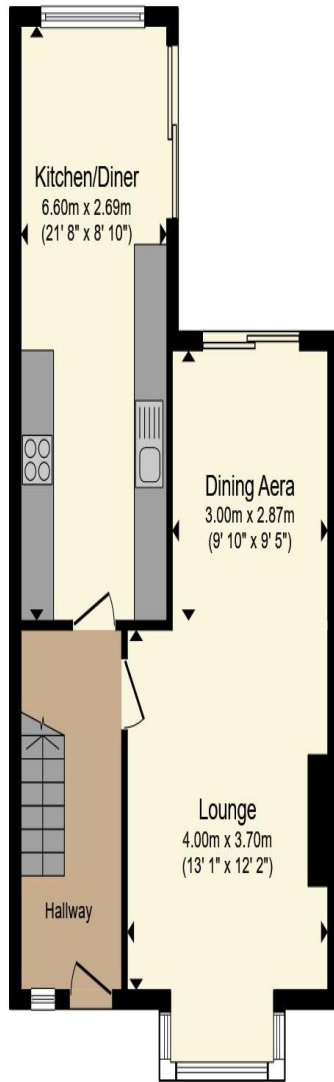

Ground Floor

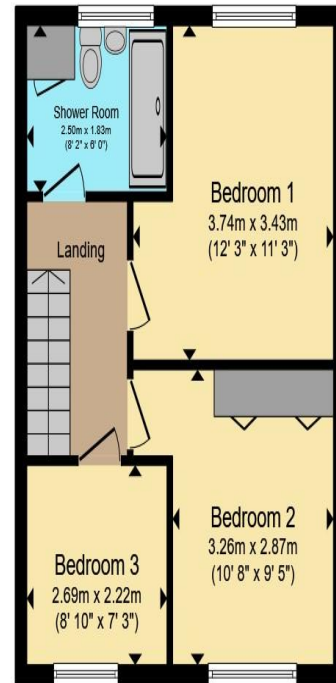

First Floor

Total floor area 91.6 m² (986 sq.ft.) approx

This floor plan is for illustrative purposes only. It is not drawn to scale. Any measurements, floor areas (including any total floor area), openings and orientation are approximate. No details are guaranteed, they cannot be relied upon for any purpose and they do not form part of any agreement. No liability is taken for any error, omission or misstatement. A party must rely upon its own inspection(s). Powered by www.propertybox.io

**Sharman
Quinney**

To view this property call Sharman Quinney on:
01733 575757

Selling your property?

Contact us to arrange a **FREE** home valuation.

 01733 575757

 Loxley Centre, Werrington, Peterborough, Cambridgeshire, PE4 5BW

 werrington@sharmanquinney.co.uk

 www.sharmanquinney.co.uk



 SCAN ME



Sharman Quinney Holdings Limited is registered in England and Wales under company number 4174227, Registered Office is Cumbria House, 16-20 Hockliffe Street, Leighton Buzzard, Bedfordshire, LU7 1GN. VAT Registration Number is 500 2481 05.

1: These particulars do not constitute part or all of an offer or contract. 2: The measurements indicated are supplied for guidance only and as such must be considered incorrect. 3: Potential buyers are advised to recheck the measurements before committing to any expense. 4: Sharman Quinney has not tested any apparatus, equipment, fixtures, fittings or services and it is the buyers interests to check the working condition of any appliances. 5: Sharman Quinney has not sought to verify the legal title of the property and buyers must obtain verification from their legal representative. 6: Intending purchasers will be asked to produce identification documentation at a later stage and we would ask your co-operation in order that there will be no delay in agreeing the sale. Ref: WER205852 - 0001

