



## Swain Street

Watchet TA23 0AE

Price £25,000



null



null



null

EPC

**Wilkie May  
& Tuckwood**

# Floorplan

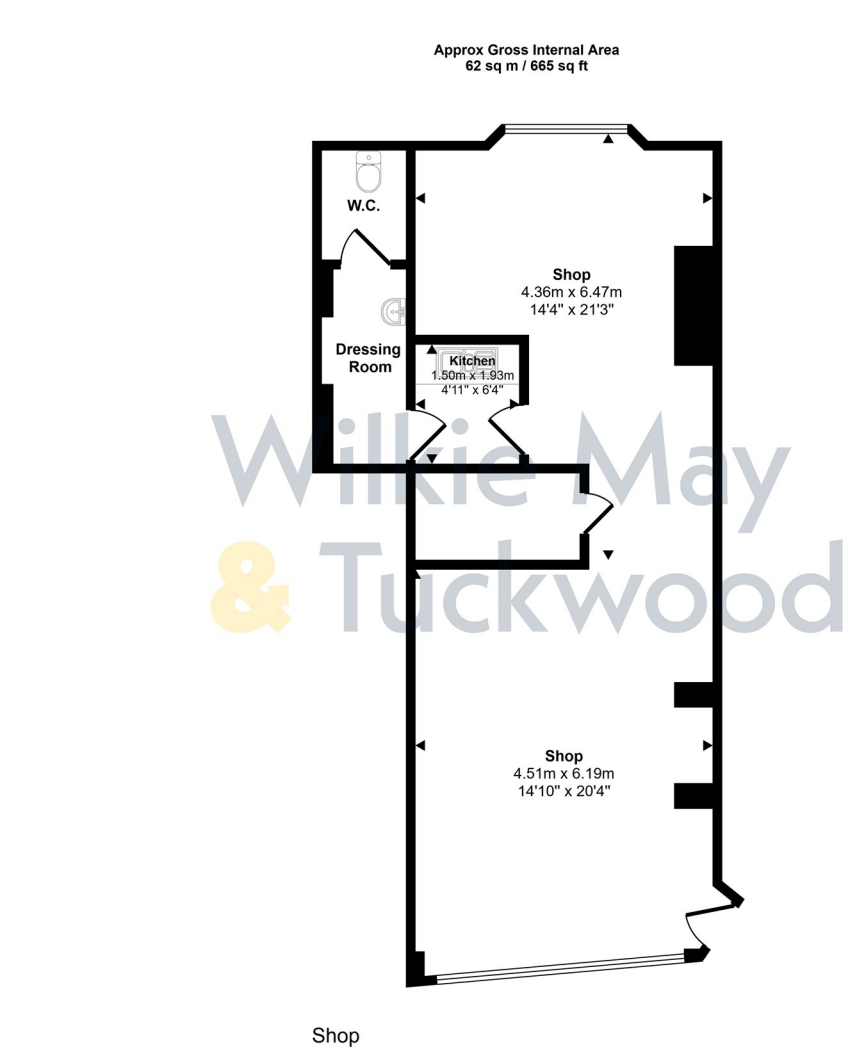

This floorplan is only for illustrative purposes and is not to scale. Measurements of rooms, doors, windows, and any items are approximate and no responsibility is taken for any error, omission or mis-statement. Icons of items such as bathroom suites are representations only and may not look like the real items. Made with Made Snappy 360.



# Description

**ESTABLISHED BUSINESS FOR SALE (NOT TO INCLUDE THE BUILDING) – An opportunity to purchase an established gifts and clothing business situated in a prominent position in the popular Harbour town of Watchet.**

- Established Business
- Town Centre Location
- Gifts, Clothing & Homeware
- New Lease to be Granted by Landlord



MATERIAL INFORMATION:

Council Tax Band: N/A

Tenure: Leasehold

Utilities: Mains water, electricity, sewage.

Parking: There is no parking with the property.

Broadband: For an indication of specific speeds and supply or coverage in the area, we would advise interested buyers to use the Ofcom checker: [checker.ofcom.org.uk/en-gb/broadband-coverage](https://checker.ofcom.org.uk/en-gb/broadband-coverage)

Mobile: For an indication of supply or coverage in the area, we would advise interested buyers to use the Ofcom checker: [checker.ofcom.org.uk/en-gb/mobile-coverage](https://checker.ofcom.org.uk/en-gb/mobile-coverage)

Flood Risk: For information relating to flood risk in the area, we would advise interested buyers to use the below



government checker: [flood-map-for-planning.service.gov.uk/location](https://flood-map-for-planning.service.gov.uk/location)

Agents Notes: Some of the photographs used by Wilkie, May & Tuckwood have been taken with a wide angled lens to show the property off to its best advantage. Please note the floorplan is for guidance only and is not architecturally accurate.

THE PROPERTY MISDESCRIPTIONS ACT 1991

The agent has not tested any apparatus, equipment, fixtures and fittings or services and so cannot verify that they are in working order or fit for the purpose. A buyer is advised to obtain verification from their Solicitor or Surveyor.

References to the Tenure of the Property are based on information supplied by the Seller. The agent has not had sight of the title documents. A Buyer is advised to obtain verification from their Solicitor.



GENERAL REMARKS AND STIPULATIONS:

Tenure:

Services:

Local Authority:

Property Location: Council Tax Band: Exempt

**Broadband and mobile coverage:** We understand that there is XXXX mobile coverage. The maximum available broadband speeds are XXX Mbps download and XXX Mbps upload. We recommend you check coverage on <https://checker.ofcom.org.uk/>.

**Flood Risk: Surface Water: XXX Rivers and the Sea: XXX risk Reservoirs: XXX Groundwater: XXX.** We recommend you check the risks on

IMPORTANT NOTICE Willie May & Tuckwood for themselves and for the vendors of the property, whose agents they are, give notice that 1. the particulars are intended to give a fair and substantially correct overall description for the guidance of intending purchasers and do not constitute part of an offer or contract. Prospective purchasers and lessees ought to seek their own professional advice. 2. All descriptions, dimensions, areas, reference to condition and necessary permissions for use and occupation and other details are given in good faith, and are believed to be correct, but any intending purchasers should not rely on them as statements or representations of fact, but must satisfy themselves by inspection or otherwise as to the correctness of each of them. 3. No person in the employment of Willie May & Tuckwood has any authority to make or give any representations or warranties in relation to this property on behalf of Willie May & Tuckwood, nor enter into any contract on behalf of the vendor. 4. No responsibility can be accepted for any expenses incurred by intending purchasers in inspecting properties which have been sold, let or withdrawn. Photographs taken and details prepared 4th February 2026. MEASUREMENTS AND OTHER INFORMATION All measurements are approximate. While we endeavour to make our sales particular accurate and reliable, if there is any point which is of particular importance to you, please contact the office and we will be pleased to check the information with you.

Code of Practice for Residential Estate Agents: Effective from 1 August 2011.

8. Financial Evaluation 8a At the time that an offer has been made and is being considered by the seller, you must take reasonable steps to find out from the prospective buyer the source and availability of his funds for buying the property and pass this information to the seller. Such information will include whether the prospective buyer needs to sell a property, requires a mortgage, claims to be a cash buyer or any combination of these. Such relevant information that is available should be included in the Memorandum of Sale having regard to the provisions of the Data Protection Act. 8b These reasonable steps must continue after acceptance of the offer until exchange of contracts (in Scotland, conclusion of missives) and must include regular monitoring of the prospective buyer's progress in achieving the funds required, and reporting such progress to the seller.

The agent has not tested any apparatus, equipment, fixtures and fittings or services and so cannot verify that they are in working order or fit for their purpose. A Buyer is advised to obtain verification from their solicitor or surveyor. References to the tenure of the property are based on information supplied by the Seller. The agent has not had sight of the title documents. A Buyer is advised to obtain verification from their solicitor.

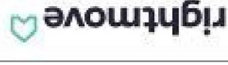

Wilkie May & Tuckwood 35 Swain Street, Watchet, Somerset, TA23

Tel: 01984 634793

