

N A I S H
E S T A T E A G E N T S



Y O R K
E S T . 1 9 3 9



36 Whernside Avenue
York, YO31 0PY

Semi-Detached home located in the heart of Burnholme, offering local amenities including shops, local sports centre and primary school. The city centre is within easy reach and York University is just over a mile away.

£220,000

36 Whernside Avenue

, York, YO31 0PY



- Semi-Detached Home
- Popular Location to the East of York
- Three Bedrooms
- Large South-Facing Garden
- Refurbishment Project
- No Onward Chain



[Directions](#)



Floor Plan

36 Wherside Avenue

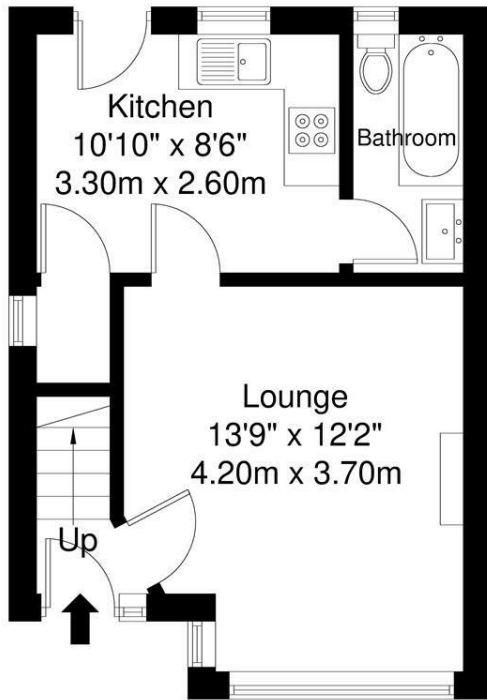

GROUND FLOOR
30.6 sq m / 329 sq ft

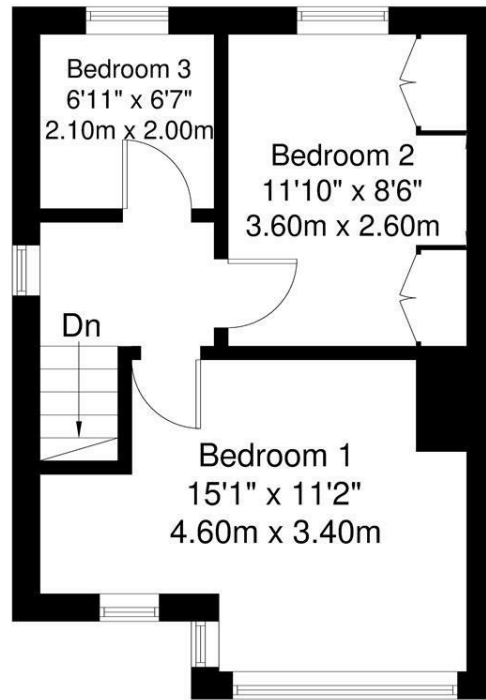

FIRST FLOOR
30.6 sq m / 329 sq ft

APPROXIMATE GROSS INTERNAL AREA = 61.2 sq m / 658 sq ft

Whilst every attempt has been made to ensure the accuracy of the floorplan contained here, measurements of doors, windows, rooms and any other items are approximate and no responsibility is taken for any error, omission or mis-statement. This plan is for illustrative purposes only and should be used as such by any prospective purchaser. The services, systems and appliances shown have not been tested and no guarantee as to their operability or efficiency can be given.

These particulars, whilst believed to be accurate are set out as a general outline only for guidance and do not constitute any part of an offer or contract. Intending purchasers should not rely on them as statements of representation of fact, but must satisfy themselves by inspection or otherwise as to their accuracy. No person in this firm's employment has the authority to make or give any representation or warranty in respect of the property.

3 High Petergate, York, YO1 7EN
Tel: 01904 653564 Email: naish@naishproperty.co.uk www.naishproperty.co.uk

Energy Efficiency Rating		Current	Potential
Very energy efficient - lower running costs			
(92 plus) A			
(81-91) B			
(69-80) C			77
(55-68) D		55	
(39-54) E			
(21-38) F			
(1-20) G			
Not energy efficient - higher running costs			
England & Wales		EU Directive 2002/91/EC	