



SYMONDS + GREENHAM

Estate and Letting Agents

14 Pinfold, Brough, HU15 2EZ
£210,000

THIS PROPERTY HAS SOLD AHEAD OF THE MARKET, THANKS TO THE POWER OF OUR SOCIAL MEDIA MARKETING AND STRONG BUYER DEMAND.

If you're thinking of selling and would like a free, no-obligation valuation, contact us on 01482 444 200 or email sales@symondsandgreenham.com.

Follow us on Instagram and Facebook @symonds_and_greenham to see how we can help your property stand out and sell faster.

CENTRAL HEATING

The property has the benefit of gas central heating (not tested).

DISCLAIMER

Symonds + Greenham do their utmost to ensure all the details advertised are correct however any viewer or potential buyer are advised to conduct their own survey prior to making an offer.

DOUBLE GLAZING

The property has the benefit of double glazing.

FLOOR PLAN DISCLAIMER

The measurements detailed on the floor plan are the maximum possible measurement for the length and width of the respective room, which can potentially be a measurement into an alcove, wardrobe or cupboard.

TENURE

Symonds + Greenham have been informed that this property is Freehold.

VIEWINGS

Please contact Symonds + Greenham on 01482 444200 to arrange a viewing on this property.

Ground Floor

Approx. 38.2 sq. metres (410.7 sq. feet)

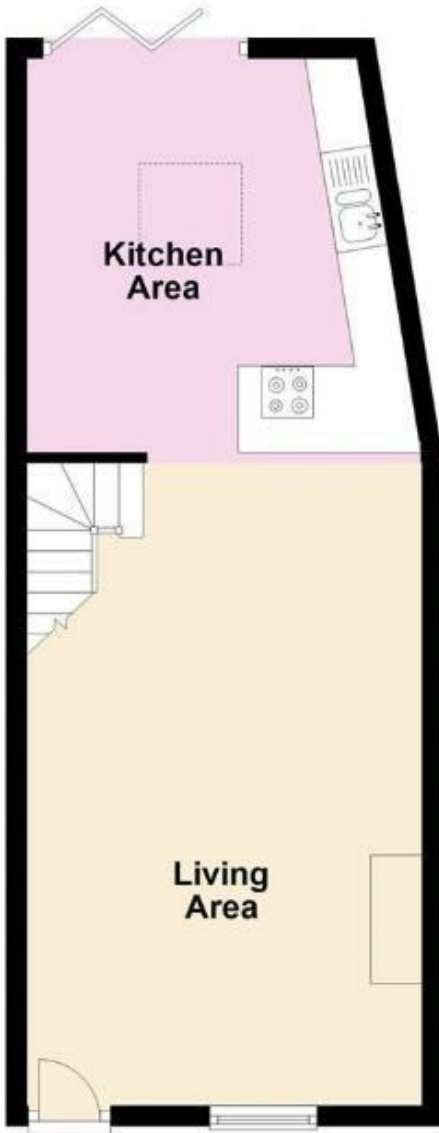

First Floor

Approx. 23.7 sq. metres (255.2 sq. feet)



Total area: approx. 61.9 sq. metres (665.8 sq. feet)

Energy Efficiency Rating	
Current	Potential
	86
63	

Environmental Impact (CO ₂) Rating	
Current	Potential

