

# School Green

East Leake, Loughborough, LE12 6LG

John   
German





# School Green

East Leake, Loughborough, LE12 6LG

Offers in excess of £400,000

**A beautifully spacious and naturally light character cottage, which has been refurbished throughout by the current owners, situated in a highly sought after central location, with an excellent size private and low maintenance rear garden, single garage and driveway.**

This wonderful home would make an ideal purchase for professional couples, families or downsizers. The property is located within half a mile of the village centre where a wide variety of shops and amenities can be found including doctor's surgery, dental practice, chemist, opticians and library. There is also a Co-Op supermarket, bakery, as well as several coffee shops, pubs and eateries. Primary and Secondary Schools are also well provisioned in the village.

Nearby conurbations of Loughborough (4m), Nottingham (8m), Derby (13m) and Leicester (13m) are easily accessible by car and regular bus service. Main line rail services are available from East Midlands Parkway (4m) and Loughborough (4m). East Midlands Airport is approximately 20 minutes away by car and while commuter access to the M1 and A46 is excellent.

Accommodation comprises; three bedrooms (two ground floor), first floor bathroom, ground floor shower room, living room, open plan kitchen/dining/family room with open fire, and conservatory.

Externally, the rear garden is of good size, very private and low maintenance, predominantly paved with mature borders and summerhouse. The single garage is accessed internally, via rear personnel door or by the ample driveway which provides parking for around two vehicles, with a shared access allowing for next door.

**Tenure:** Freehold (purchasers are advised to satisfy themselves as to the tenure via their legal representative).

**Please note:** It is quite common for some properties to have a Ring doorbell and internal recording devices. Where covenants are listed on the Land Registry Title, the buyer(s) is liable for their own investigations, via an appropriate legal professional.

**Property construction:** Standard

**Parking:** Single garage and drive

**Electricity supply:** Mains

**Water supply:** Mains

**Sewerage:** Mains

**Heating:** Mains gas

(Purchasers are advised to satisfy themselves as to their suitability).

**Broadband type:** Fibre - See Ofcom link for speed: <https://checker.ofcom.org.uk/>

**Mobile signal/coverage:** See Ofcom link <https://checker.ofcom.org.uk/>

**Local Authority/Tax Band:** Rushcliffe Borough Council / Tax Band E

**Useful Websites:** [www.gov.uk/government/organisations/environment-agency](http://www.gov.uk/government/organisations/environment-agency)

**Our Ref:** JGA/15042026

The property information provided by John German Estate Agents Ltd is based on enquiries made of the vendor and from information available in the public domain. If there is any point on which you require further clarification, please contact the office and we will be pleased to check the information for you, particularly if contemplating travelling some distance to view the property. Please note if your enquiry is of a legal or structural nature, we advise you to seek advice from a qualified professional in their relevant field.

We are required by law to comply fully with The Money Laundering Regulations 2017 and as such need to complete AML ID verification and proof / source of funds checks on all buyers and, where relevant, cash donors once an offer is accepted on a property. We use the Checkboard app to complete the necessary checks, this is not a credit check and therefore will have no effect on your credit history. With effect from 1<sup>st</sup> March 2025 a non-refundable compliance fee of £30.00 inc. VAT per buyer / donor will be required to be paid in advance when an offer is agreed and prior to a sales memorandum being issued.





John German



John German



John German



John German

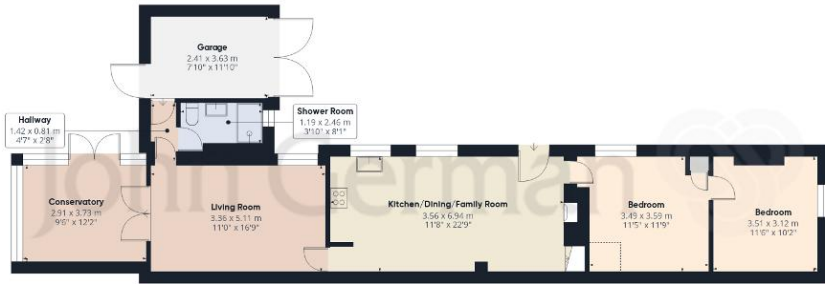

Ground Floor Building 1

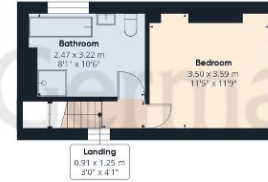

Floor 1 Building 1



Ground Floor Building 2

**Approximate total area<sup>(1)</sup>**

119.7 m<sup>2</sup>

1287 ft<sup>2</sup>

**Reduced headroom**

0.8 m<sup>2</sup>

9 ft<sup>2</sup>

(1) Excluding balconies and terraces

Reduced headroom

..... Below 1.5 m/5 ft

Calculations reference the RICS IPMS 3C standard. Measurements are approximate and not to scale. This floor plan is intended for illustration only.

GIRAFFE360



### Agents' Notes

These particulars do not constitute an offer or a contract neither do they form part of an offer or contract. The vendor does not make or give and Messrs. John German nor any person employed has any authority to make or give any representation or warranty, written or oral, in relation to this property. Whilst we endeavour to make our sales details accurate and reliable, if there is any point which is of particular importance to you, please contact the office and we will be pleased to check the information for you, particularly if contemplating travelling some distance to view the property. None of the services or appliances to the property have been tested and any prospective purchasers should satisfy themselves as to their adequacy prior to committing themselves to purchase.

### Referral Fees

**Mortgage Services** - We routinely refer all clients to APR Money Limited. It is your decision whether you choose to deal with APR Money Limited. In making that decision, you should know that we receive on average £60 per referral from APR Money Limited.

**Conveyancing Services** - If we refer clients to recommended conveyancers, it is your decision whether you choose to deal with this conveyancer. In making that decision, you should know that we receive on average £150 per referral.

**Survey Services** - If we refer clients to recommended surveyors, it is your decision whether you choose to deal with this surveyor. In making that decision, you should know that we receive up to £90 per referral.

Score	Energy rating	Current	Potential
92+	A		
81-91	B		
69-80	C		76 C
55-68	D	56 D	
39-54	E		
21-38	F		
1-20	G		



John German

75 Main Street, East Leake, Loughborough, Leicestershire, LE12 6PS

01509 856006

eastleake@johngerman.co.uk

Ashbourne | Ashby de la Zouch | Barton under Needwood  
Burton upon Trent | Derby | East Leake | Lichfield  
Loughborough | Stafford | Uttoxeter

JohnGerman.co.uk Sales and Lettings Agent



