



Princes Road, SW19

£2,300 PCM

A newly refurbished penthouse apartment. There are two double bedrooms, an open plan living room with direct access to a private roof terrace.

The property is located on a residential road in the centre of Wimbledon. The overground train station is within a short walk along as the numerous shops, restaurant's and coffee shops.

Features

- Two Double Bedrooms
- Newly Refurbished
- Central Wimbledon
- Penthouse
- Roof Terrace
- Open Plan

Princes Road, London, SW19

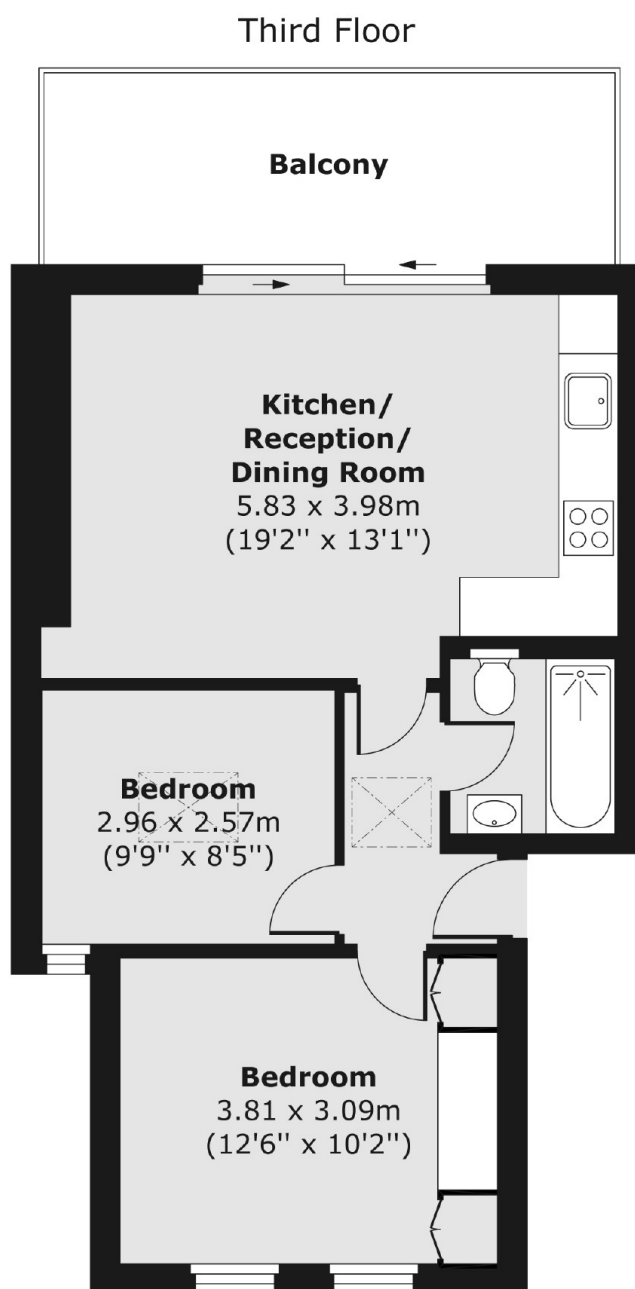

Total area (approx.) 48.50 sq. m (522 sq. ft)
Balcony area (approx.) 11.19 sq. m (120 sq. ft)