



## Copleston Road, SE15

£500,000

A charming one double bedroom ground floor flat on the sought after Copleston Road, complete with its own private entrance and a beautifully maintained east-facing garden.

Copleston Road is a tree lined sought-after street that enjoys an ideal location between East Dulwich and Peckham, both a short walk away and offering an array of independent shops, bars and restaurants. East Dulwich Station provides onward links to London Bridge with Peckham Rye station providing frequent overground connections to Clapham Junction.

### Features

- One Double Bedroom
- Private East Facing Garden
- Sought After Road
- Excellent Transport Links
- Victorian Conversion
- Private Entrance



## Copleston Road, SE15

To the front of the property, the reception room features a bay window, further enhanced by high ceilings and a characterful fireplace. The generously sized double bedroom benefits from built-in storage and a large window with shutters, drawing in excellent natural light from the side return. The fully fitted kitchen/dining room provides ample space for both cooking and entertaining. To the rear, a stylish and contemporary bathroom is complemented by a highly useful utility room, offering additional storage and functionality. From here, there is direct access to the delightful private garden. This tranquil outdoor space enjoys an easterly aspect and is thoughtfully landscaped with mature planting and established shrubbery, along with a decked seating area perfect for al fresco dining.



# Copleston Road, London, SE15

## Ground Floor

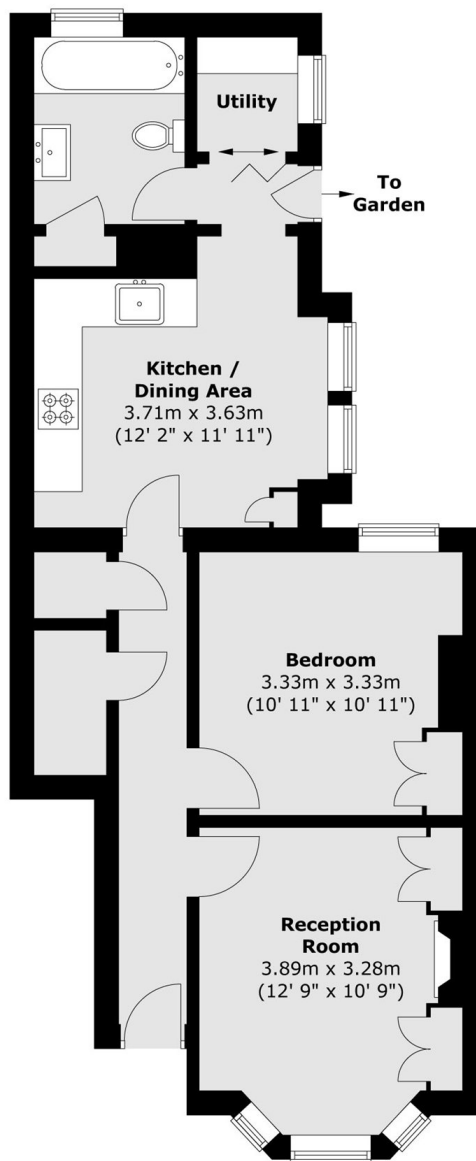

Total area (approx.) : 55.4 sq. m (596 sq. ft)