

ALLDAY
& MILLER



Cavendish Avenue, Ruislip, HA4 6QH
£475,000

 3  1  1  C



Cavendish Avenue, Ruislip, HA4 6QH

£475,000

- Mid Terrace Family Home
- Spacious Reception / Dining Room
- Family Bathroom
- Large Rear Garden
- Catchment Area For Excellent Schools
- Three Bedrooms
- Off Street Parking
- Garage
- Potential To Extend (STPP)
- Walking Distance To South Ruislip Station

Description

This spacious and well proportioned three bedroom home offers versatile accommodation arranged over two floors.

The home briefly comprises a generous reception/dining room and fitted kitchen, providing ample space for everyday living.

To the first floor are three bedrooms together with a family bathroom.

Externally, the property benefits from parking to the front and a large private rear garden, ideal for outdoor enjoyment and entertaining.

Situation

Situated in a convenient residential location on Cavendish Avenue, Ruislip, this well-positioned home is within close proximity to South Ruislip Station, offering Central Line and Chiltern Railways services with direct links into Central London and surrounding areas. The property is ideally located near Bourne Primary School, Queensmead School and Ruislip High School, being among the closest local schools to the property. South Ruislip Retail Park, featuring a range of supermarkets, shops, restaurants and leisure facilities, is also nearby, while excellent transport connections via the A40 and local bus routes provide easy access to neighbouring town centres and beyond.



Floor Plans

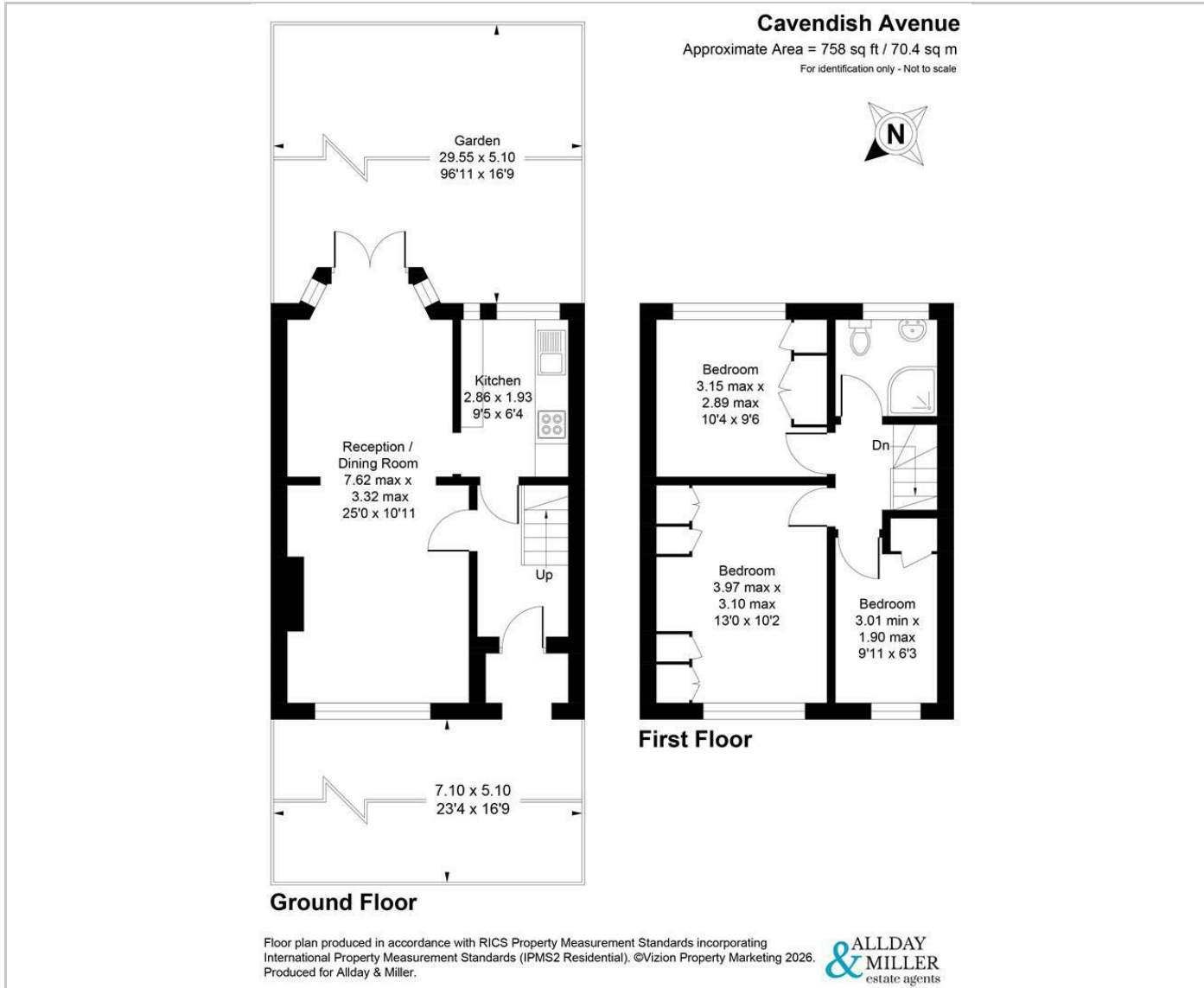

Area Map

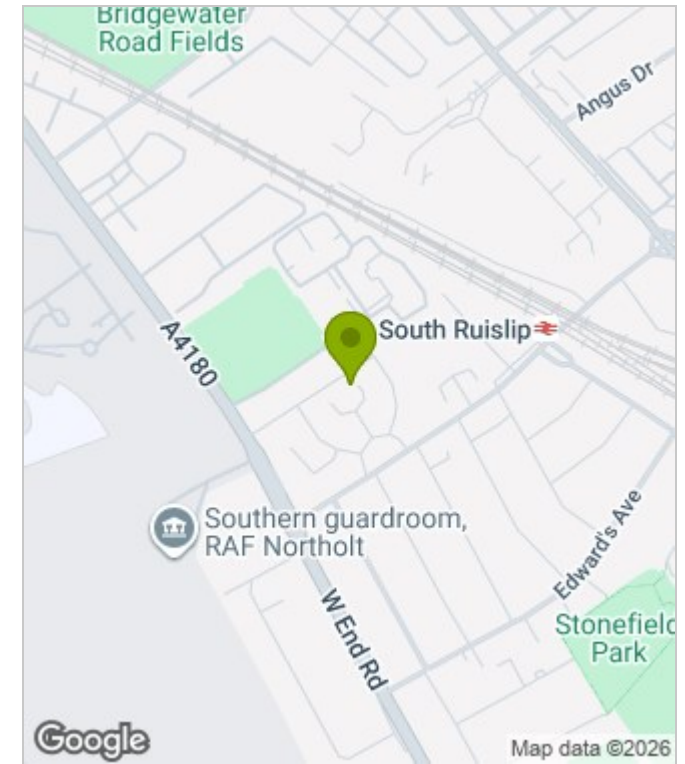

Energy Performance Graph

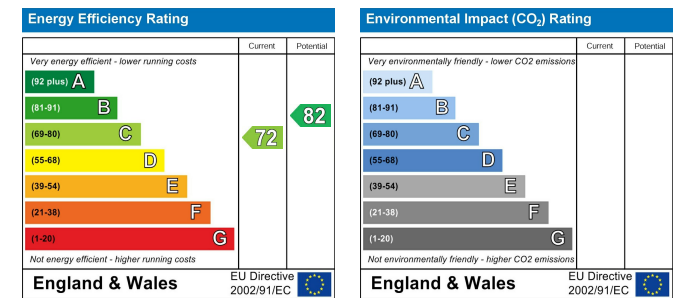

These particulars, whilst believed to be accurate are set out as a general outline only for guidance and do not constitute any part of an offer or contract. Intending purchasers should not rely on them as statements of representation of fact, but must satisfy themselves by inspection or otherwise as to their accuracy. No person in this firm's employment has the authority to make or give any representation or warranty in respect of the property.