



**Connells**

**Bowmans Green  
WATFORD**





### Property Description

Beautifully presented three-bedroom terraced home, decorated throughout to a high standard and offering generous living space. The property features an entrance hallway, cloakroom, a spacious through lounge leading to a dedicated dining area, and a bright conservatory. The modern kitchen is fully fitted with worktops and units on all sides, providing ample storage and practical workspace. Upstairs, the property offers three well-proportioned bedrooms, including a particularly spacious third bedroom, and a family bathroom accessed from the landing. To the rear there is a delightful, large garden with a patio area and a well-maintained lawn—ideal for outdoor dining and family use. The home is perfectly positioned for Stanborough Primary and Senior Schools, and the highly sought-after Parmiter's School.

#### Entrance Hall

#### Cloakroom

#### Lounge

11' x 22' 5" ( 3.35m x 6.83m )

#### Kitchen

8' 8" x 12' 11" ( 2.64m x 3.94m )

#### Conservatory



## First Floor Landing

### Bedroom 1

11' x 14' max ( 3.35m x 4.27m max )

### Bedroom 2

11' 3" max x 10' 9" ( 3.43m max x 3.28m )

### Bedroom 3

10' x 9' 8" max ( 3.05m x 2.95m max )

## Bathroom

## Outside

## Front Garden

## Rear Garden













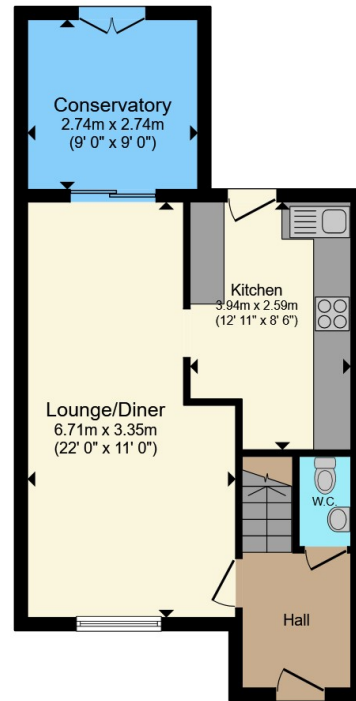

**Ground Floor**

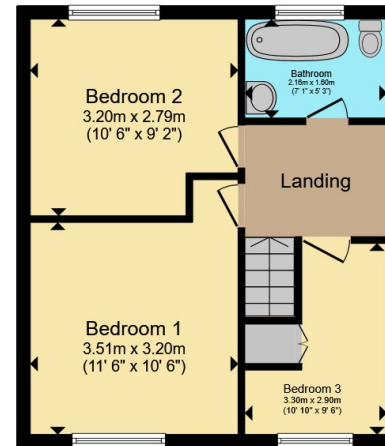

**First Floor**

This floor plan is for illustrative purposes only. It is not drawn to scale. Any measurements, floor areas (including any total floor area), openings and orientation are approximate. No details are guaranteed, they cannot be relied upon for any purpose and they do not form part of any agreement. No liability is taken for any error, omission or misstatement. A party must rely upon its own inspection(s). Powered by [www.propertybox.io](http://www.propertybox.io)

**Connells**

To view this property please contact Connells on

**T 01923 674504**  
**E [leavesden@connells.co.uk](mailto:leavesden@connells.co.uk)**

1 Cunningham Way Leavesden  
Abbots Langley WD25 7NG

EPC Rating: C Council Tax  
Band: C

Tenure: Freehold

**view this property online [connells.co.uk/Property/LEA103542](http://connells.co.uk/Property/LEA103542)**



1. MONEY LAUNDERING REGULATIONS Intending purchasers will be asked to produce identification documentation at a later stage and we would ask for your co-operation in order that there will be no delay in agreeing the sale. 2. These particulars do not constitute part or all of an offer or contract. 3. The measurements indicated are supplied for guidance only and as such must be considered incorrect. Potential buyers are advised to recheck measurements before committing to any expense. 4. We have not tested any apparatus, equipment, fixtures, fittings or services and it is in the buyers interest to check the working condition of any appliances.

Connells Residential is registered in England and Wales under company number 1489613, Registered Office is Cumbria House, 16-20 Hockliffe Street, Leighton Buzzard, Bedfordshire, LU7 1GN. VAT Registration Number is 500 2481 05.

**See all our properties at [www.connells.co.uk](http://www.connells.co.uk) | [www.rightmove.co.uk](http://www.rightmove.co.uk) | [www.zoopla.co.uk](http://www.zoopla.co.uk)**

Property Ref: LEA103542 - 0011