



## 10 Nightingale Walk, Stevenage, SG2 0QE

**£340,000**

Located in Chells Stevenage, is this two double bedroom end of terrace home, with off road parking for two cars.

Step inside a welcoming entrance hall with solid wooden flooring underfoot, and cupboard storage for coats, bags and shoes. The lounge is a bright and flooded with natural light from the French doors which lead out to the garden. At the rooms centre is a feature fireplace, perfect for cosy nights when the seasons change.

The kitchen is modern and bright with stone worktops and upstands, a stainless-steel splashback and a gas range oven, as well as space for a fridge freezer, dishwasher, washing machine and tumble dryer.

Upstairs are two double bedrooms both benefitting from built in wardrobes. The four-piece family bathroom has a contemporary style and features a vanity sink with storage, bath and a walk-in shower



## Floor Plan

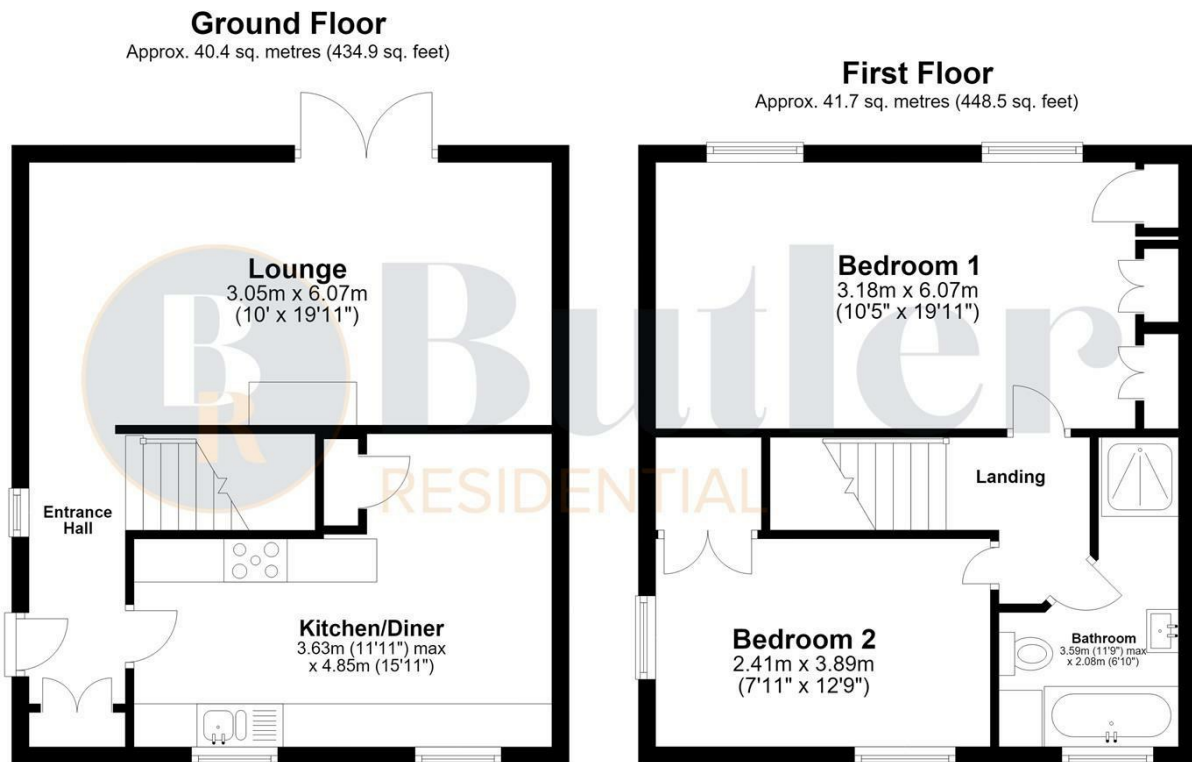

Total area: approx. 82.1 sq. metres (883.4 sq. feet)

## Area Map

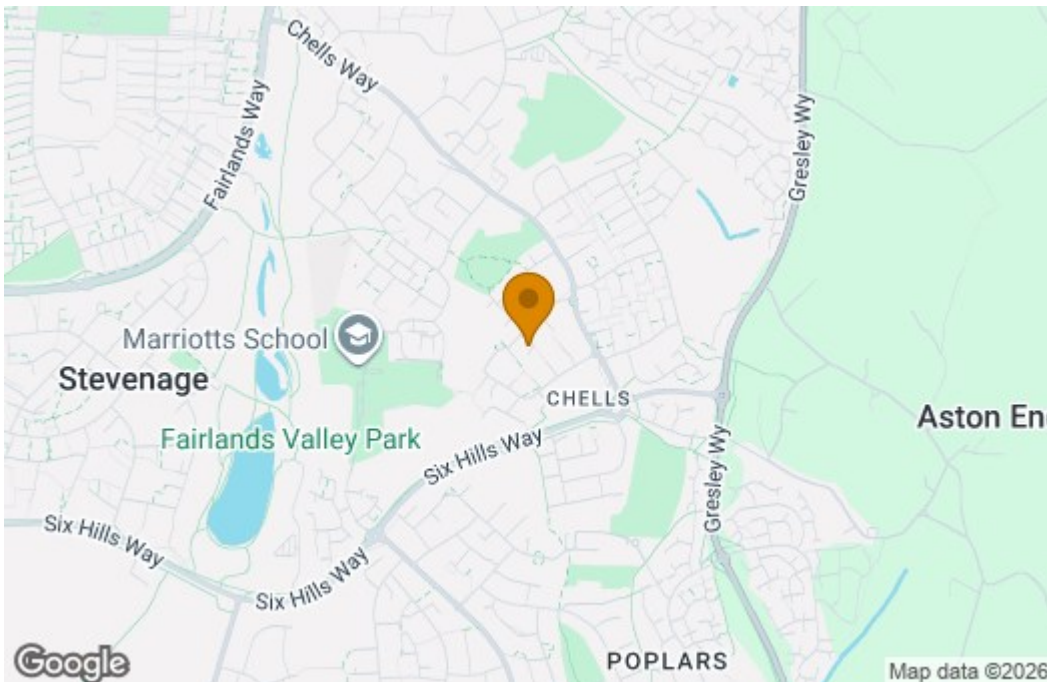

## Energy Efficiency Graph

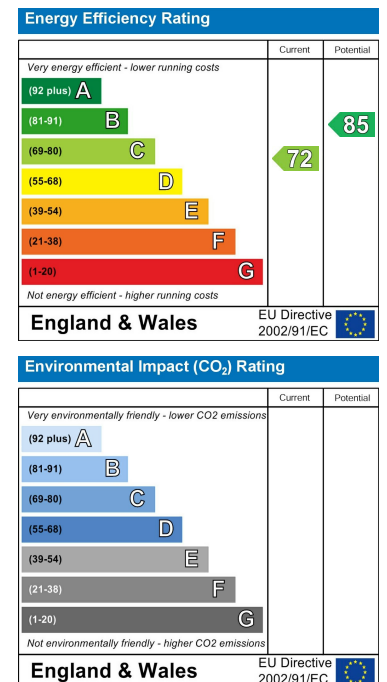

These particulars, whilst believed to be accurate are set out as a general outline only for guidance and do not constitute any part of an offer or contract. Intending purchasers should not rely on them as statements of representation of fact, but must satisfy themselves by inspection or otherwise as to their accuracy. No person in this firm's employment has the authority to make or give any representation or warranty in respect of the property.

**Address:** Suite 2, First Floor, Unit B, Balbir House Norton Green Road, Stevenage, SG1 2LP

**Tel:** 01438 584400

**Email:** hello@butlerresidential.co.uk