



SUTHERLAND AVENUE, W9

£1,075,000

An exceptionally spacious two double bedroom garden flat set on one of Maida Vale's most sought-after roads, extending to approximately 956 sq ft.

Period conversion
Two bedrooms
Excellent condition

Extended to rear
Two bathrooms
Private entrance

STEP INSIDE SUTHERLAND AVENUE

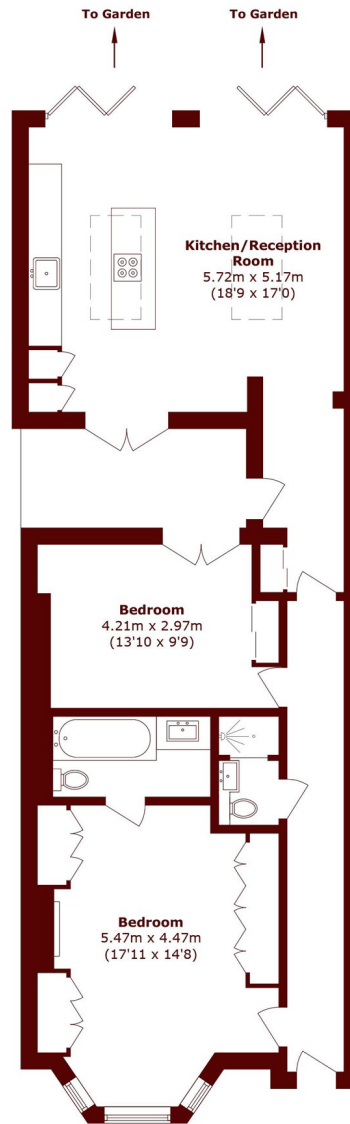

Lower Ground Floor

Total area (approx.): 88.9 sq. m (956.9 sq. ft)

Little Venice
020 7993 3050

Energy Rating: We aim to make our particulars both accurate and reliable. However, they are not guaranteed; nor do they form part of an offer or contract. If you require clarification on any points then please contact us, especially if you're traveling some distance to view. Please note that appliances and heating systems have not been tested and therefore no warranties can be given as to their good working order

MARSH &
PARSONS