



# Northside Wandsworth Common

Battersea, SW18

£2,150 per month  
(£496.15 per week)

Benefitting from two double bedrooms, this property is ideal for couples or professional sharers and further benefits from off-street parking (garage).



# Northside Wandsworth Common

## Battersea, SW18

- Well-proportioned two bedroom property
- Wood floors throughout the living spaces
- Two spacious double bedrooms
- Family bathroom with white three piece suite
- Bright and generous living room
- Separate modern kitchen with integrated appliances and ample storage
- Communal garden to the rear
- Garage for parking



Chestertons has the pleasure of presenting a well-proportioned two bedroom property to the rental market a stone's throw from Wandsworth Common.

Boasting wood floors in the living spaces the property comprises two spacious double bedrooms, a family bathroom with white three piece suite, a bright and generous living room, and a separate modern kitchen with integrated appliances and ample storage. The property also benefits from a communal garden to the rear.

North Side Wandsworth Common is within close proximity to Wandsworth Common and an abundance of bars, restaurants, cafes

**Minimum Term:** 12 months  
**Deposit Required:** £0.00  
**Local Authority:**  
**Council Tax Band:** D  
**EPC Rating:** D  
**Furnished**

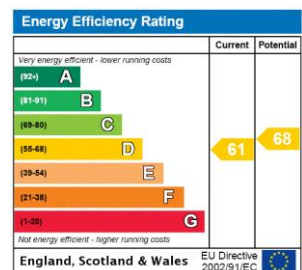

### Chestertons Wandsworth Town Lettings

47 East Hill  
 London  
 SW18 2QE  
 wandsworthlettingsusers@chestertons.co.uk  
 02081047540  
 chestertons.co.uk

Additional tenant charges apply (fees apply to non-AST tenancies only)  
 Tenancy Agreement Fee: £300  
 References per Tenant/Guarantor: £60  
 Inventory check (approx. £100 – £250 inc. VAT)  
 chestertons.co.uk/property-to-rent/applicable-fees

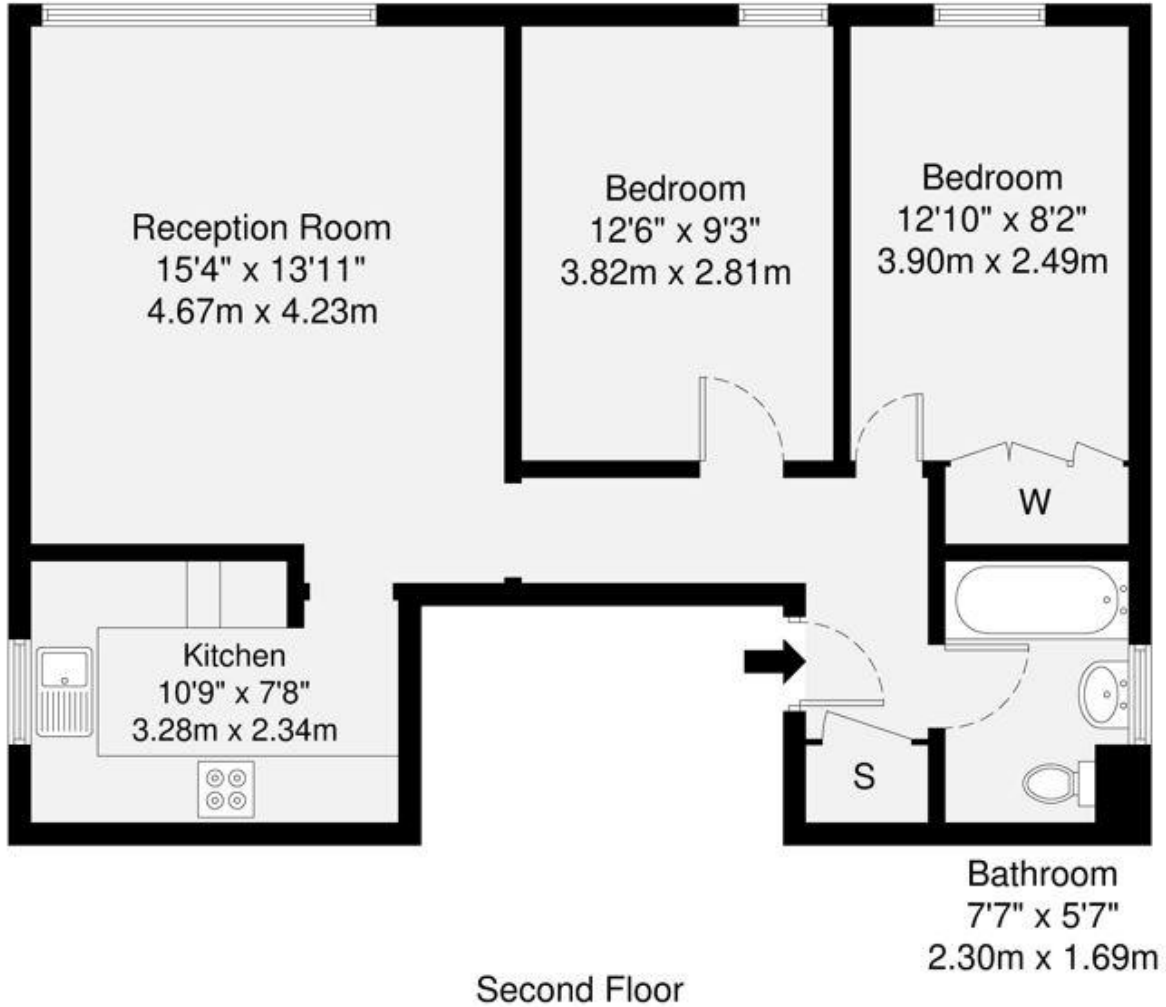

**GROSS INTERNAL AREA (GIA)**  
The footprint of the property  
62.6 sq m / 674 sq ft

**TOTAL STORAGE SPACE**  
Storage and wardrobe total area  
1.9 sq m / 20 sq ft

**EXTERNAL FEATURES**  
Garden, Balcony, Terrace, Verandah etc.  
0.0 sq m / 0.0 sq ft

**RESTRICTED HEAD HEIGHT**  
Limited use areas under 1.5m  
0.0 sq m / 0.0 sq ft

Disclaimer : Floorplan measurements are approximate and are for illustrative purposes only. While we do not doubt the floorplan accuracy and completeness, you or your advisors should conduct a careful, independent investigation of the property in respect of monetary valuation.

Maison  
VUE

