



Granville Road, NW2

£395,000

The property offers two double bedrooms, including a principal with en-suite, a family bathroom, and a fitted kitchen. The reception room features a Juliet balcony and the property includes gated allocated parking.

Groewood House is ideally positioned close to Golders Green Station, providing excellent transport links via the Northern Line. A wide selection of shops, cafés, restaurants, and local amenities can be found along Golders Green Road, with nearby parks and open green spaces also within easy reach.

Features

- Two Double Bedrooms
- Two Bathrooms
- Fitted Kitchen
- Allocated Parking
- Juliet Balcony
- Lift Access

Granville Road, London, NW2

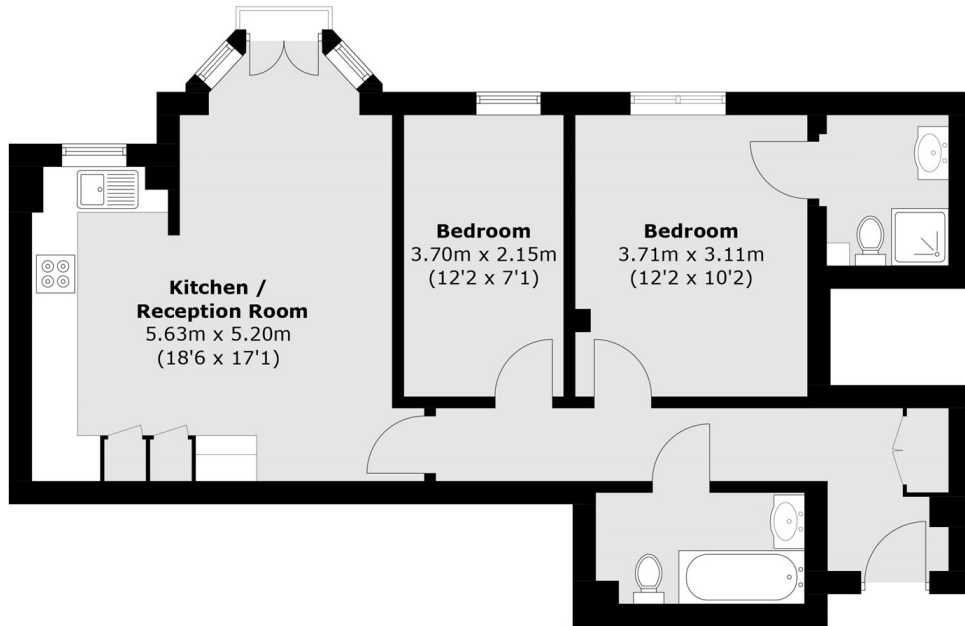

Total area (approx.): 61.4 sq. m (660.9 sq. ft)