

Canons Court, Stonegrove, Edgware, HA8

£300,000

2 1 1



A Two Double Bedroom First Floor Apartment, in the heart of Central Edgware within walking distance to local transport links/shops.

Accommodation comprises Two Double Bedrooms, Reception Room, Separate Kitchen and a Family Bathroom.

Features include a long lease of 146 years, off street parking (non-allocated) and communal gardens.

Ideal first time purchase, or buy to let investment.

Call Benjamin Stevens now to view!

Key Features

- Two Double Bedrooms
- Great Location
- Long lease of 146 years
- Separate Kitchen
- First Floor
- Walking distance to shops/transport
- Communal Gardens
- Ideal first time purchase or buy to let investment

FIRST FLOOR
527 sq.ft. (49.0 sq.m.) approx.

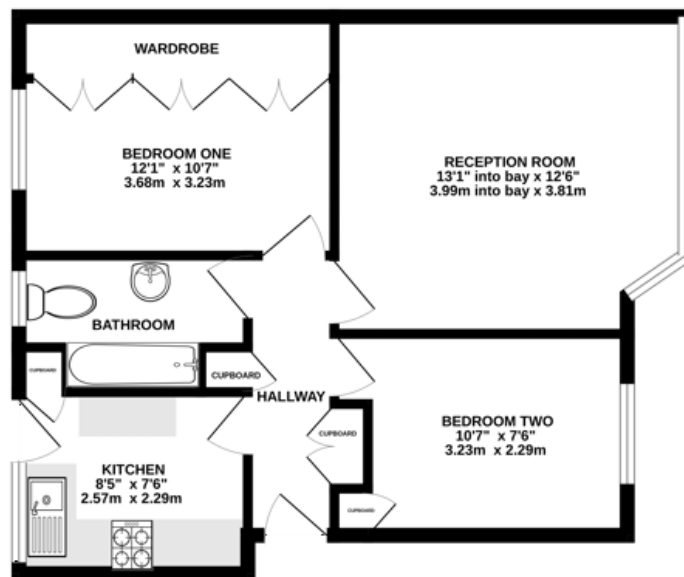

TOTAL FLOOR AREA: 527 sq.ft. (49.0 sq.m.) approx.
While every attempt has been made to ensure the accuracy of the floorplan, Benjamin Stevens, its agents and any other persons involved in the preparation of this floorplan do not accept any responsibility for any errors, omissions or misstatements. This plan is for illustrative purposes only and should be used as a guide only for prospective purchasers. The services, systems and appliances shown have not been tested and no guarantee is given as to their quality or efficiency and no guarantee is given as to their condition.