



Unit C Black Horse Street  
Bolton, BL1 1SX

**£630 PCM**

## Unit C Black Horse Street

, Bolton, BL1 1SX

Prime Commercial Units To Let – Heart of Bolton Town Centre

An exceptional opportunity to establish your business within one of Bolton's most exciting regeneration developments.

A range of high-quality ground floor commercial units are available, offering flexible space from 50 sq m to 171 sq m, ideal for a variety of retail, leisure, office, and service-based occupiers (subject to the necessary consents).

Perfectly positioned in the heart of Bolton town centre, the development enjoys a prominent location directly opposite Cheadle Gardens, close to Elizabeth Park and Bolton Market, while sitting adjacent to Bolton Town Hall and Le Mans Crescent.

The units are offered in a shell and core condition, with connections to electricity, water, and drainage in place, and are ready for tenant fit-out.

Contact us directly to secure a viewing.

### Bolton Town Centre

Bolton Town Centre is the main commercial and civic hub of Bolton, offering a mix of historic and modern buildings, shops, and leisure facilities. It is currently undergoing regeneration to improve public spaces, attract investment, and create a more vibrant town centre.

### Neighbourhood

The Neighbourhood development in Bolton is a vibrant new town-centre neighbourhood transforming a former bus station site into modern urban living. It offers over 200 stylish new homes, a mix of apartments and houses, plus convenient retail space and



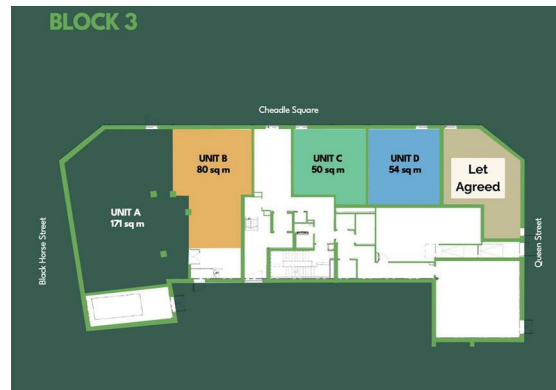

attractive public areas. Designed for contemporary lifestyles, it brings walkable, well-connected living right into the heart of Bolton's regeneration.

- Ground floor commercial units
- Flexible lease terms available
- Prominent town centre location
- Opposite Elizabeth Park and Bolton Market
- Adjacent to Bolton Town Hall and Le Mans Crescent
- Situated within a thriving mixed-use development
- Excellent opportunity for retail, hospitality, office and service businesses
- Strong pedestrian footfall and excellent transport links

## Viewing

Please contact our Reside Bolton Office on 01204 914 808 if you wish to arrange a viewing appointment for this property or require further information.

These particulars, whilst believed to be accurate are set out as a general outline only for guidance and do not constitute any part of an offer or contract. Intending purchasers should not rely on them as statements of representation of fact, but must satisfy themselves by inspection or otherwise as to their accuracy. No person in this firm's employment has the authority to make or give any representation or warranty in respect of the property.

Le Mans Place Barn Street, Bolton, BL1 1DJ

Tel: 01204 914 808 Email: [hello@residebolton.com](mailto:hello@residebolton.com) [www.residebolton.com](http://www.residebolton.com)