



HODSONS



ASKING PRICE

£250,000

Milton Road

Wakefield, WF2 8AD



PROPERTY SUMMARY

An well presented three bedroom semi-detached home, positioned on a popular modern development. Offering well-balanced accommodation, a stylish interior and a pleasant enclosed rear garden, the property is ready to move straight into and would suit a range of buyers. Offered for sale with no onward chain.

3



2



1









Approx Gross Internal Area
79 sq m / 850 sq ft

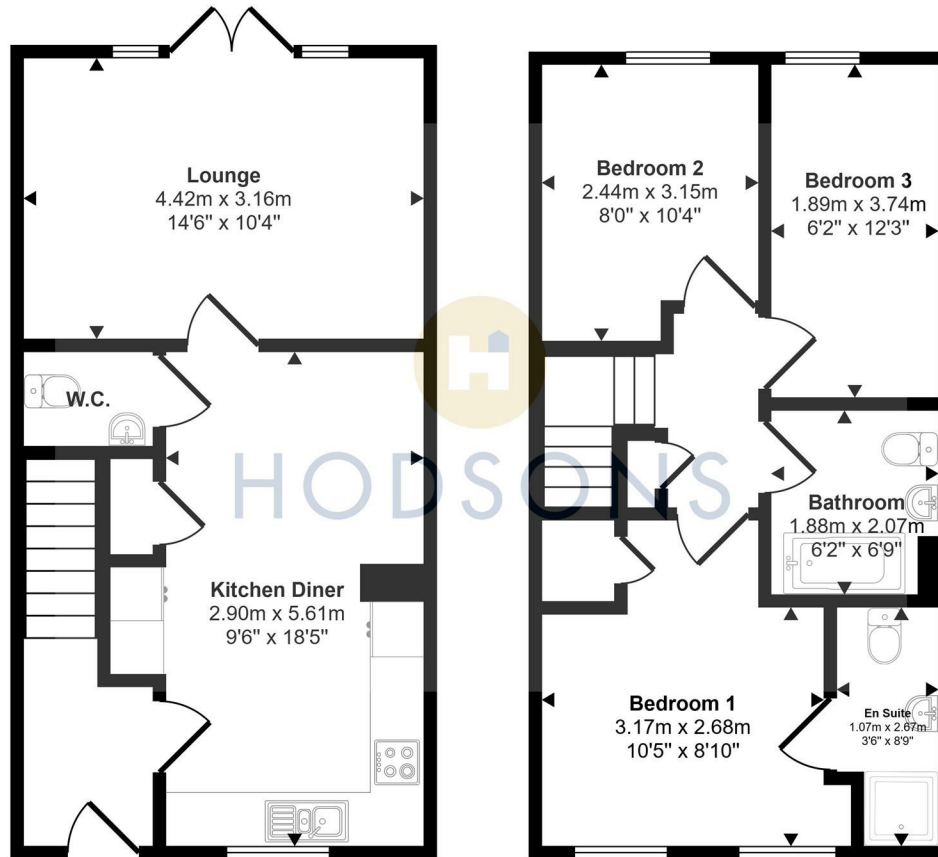

Ground Floor
Approx 40 sq m / 428 sq ft

First Floor
Approx 39 sq m / 423 sq ft

This floorplan is only for illustrative purposes and is not to scale. Measurements of rooms, doors, windows, and any items are approximate and no responsibility is taken for any error, omission or mis-statement. Icons of items such as bathroom suites are representations only and may not look like the real items. Made with Made Snappy 360.

LOCAL AUTHORITY

TENURE
Freehold

COUNCIL TAX BAND
C

VIEWINGS
By prior appointment only

Energy Efficiency Rating		Current	Potential
Very energy efficient - lower running costs			
(92 plus) A			95
(81-91) B		83	
(69-80) C			
(55-68) D			
(39-54) E			
(21-38) F			
(1-20) G			
Not energy efficient - higher running costs			
England & Wales		EU Directive 2002/91/EC	

Agents Note: Whilst every care has been taken to prepare these particulars, they are for guidance purposes only. All measurements are approximate and are for general guidance purposes only and whilst every care has been taken to ensure their accuracy, they should not be relied upon and potential buyers/tenants are advised to recheck the measurements



OFFICE ADDRESS

37-39 George Street
Wakefield
West Yorkshire
WF1 1LX

OFFICE DETAILS

01924 200544
wakefield@hodsonsproperty.co.uk
www.hodsonsproperty.co.uk