



## Streatham Hill, SW2

£385,000

A bright and well-presented two bedroom top floor apartment set within the sought after Art Deco development of Wavertree Court. Occupying the top floor, the apartment benefits from no upstairs neighbours and enjoys an abundance of natural light throughout. Positioned within the rear block of the development, away from the road, it offers a remarkably peaceful setting. The property is also being offered chain free.

Wavertree Court is renowned for its attractive Art Deco architecture, beautifully maintained communal gardens and feature fountains. Residents enjoy easy access to an excellent selection of cafés, restaurants, bars, supermarkets and everyday amenities, all within walking distance. Streatham Hill station is a short walk away, providing direct links into Central London, while excellent bus connections serve Brixton, Balham, Clapham and beyond. Tooting Common and Brockwell Park are also within easy reach.

### Features

- Two Bedrooms
- Good Condition
- Chain Free
- Communal Gardens
- Communal heating and hot water included in Service Charge

# Streatham Hill, London, SW2

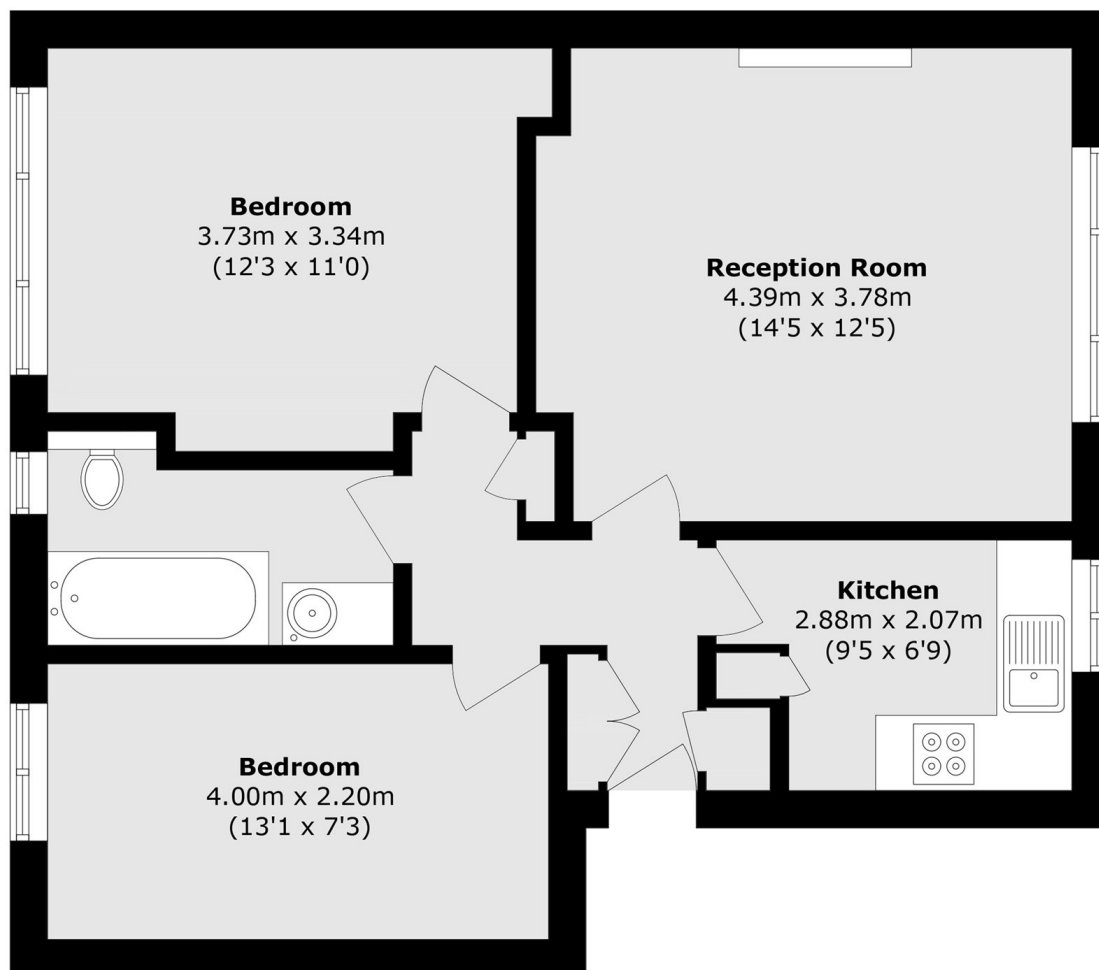

Total area (approx.): 53.2 sq. m (572.6 sq. ft)