



**28 PINE VIEW ROAD, VERWOOD, DORSET, BH31 6LQ**

**01722 238711**

**BAXTERS**  
PROPERTY & LAND AGENTS





## **28 PINE VIEW ROAD, VERWOOD, DORSET BH31 6LQ**

### **PRICE GUIDE: £370,000**

Here we have a smart modern detached bungalow situated on the edge of the popular Dorset country town of Verwood. The property has the benefit of a two car private drive, a large detached garage with workshop and attached store/utility and a large private sunny garden. Pine View Road is well placed for access to all local amenities and Crane Valley Golf Club.

Truly deceptive in appearance, 28 Pine View Road offers spacious accommodation composed of a reception hall, a single generous living room with fireplace and an adjoining double glazed conservatory, good size kitchen, two double bedrooms and a family bathroom.





The property is fully double glazed and centrally heated via a mains gas fired boiler to radiators.

To the front of the bungalow is an open plan garden, private drive and parking. There is a much larger than average detached garage accessible via a covered side entrance. The rear garden is of an excellent size, extremely well maintained, private and south facing.

28 Pine View Road is available for sale with no onward chain.

LOCATON: The country town of Verwood is located near the new forest border and surrounded by forest and heathland. There are a number of amenities available in Verwood including a selection of pubs, takeaways and restaurants. There are also 2 doctors surgeries. Leisure facilities include cinema, theatre, golf course and excellent fishing facilities. More comprehensive shopping and leisure facilities can be found in and around Bournemouth which is approximately 14 miles away to the south. The cathedral city of Salisbury is about 20 miles to the north.

DIRECTIONS: From Ringwood, proceed north west along the B3081 (Verwood Road) for approximately 5 miles. Continue into Verwood still following the B3081 which becomes Ringwood Road. Follow the road through the town along Station Road and the turning left into Pine View Road will be found the left hand side shortly before the Albion Inn which is on your right. Number 28 will be found after a short distance on the right hand side.

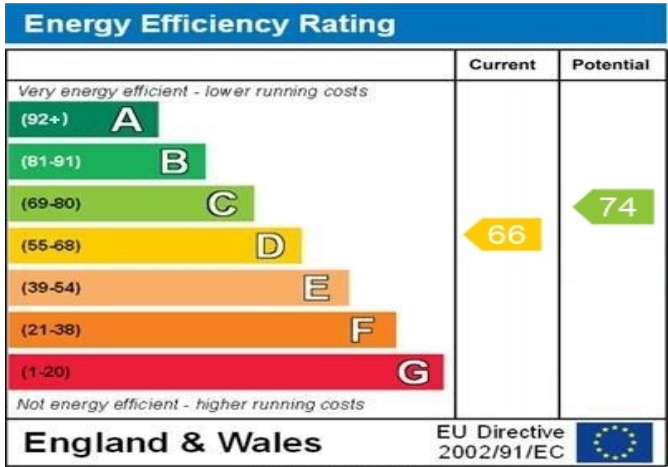

28 Pine View Road  
Verwood BH31 6LQ  
Approximate Gross Internal Area  
1100 sq ft - 102 sq m

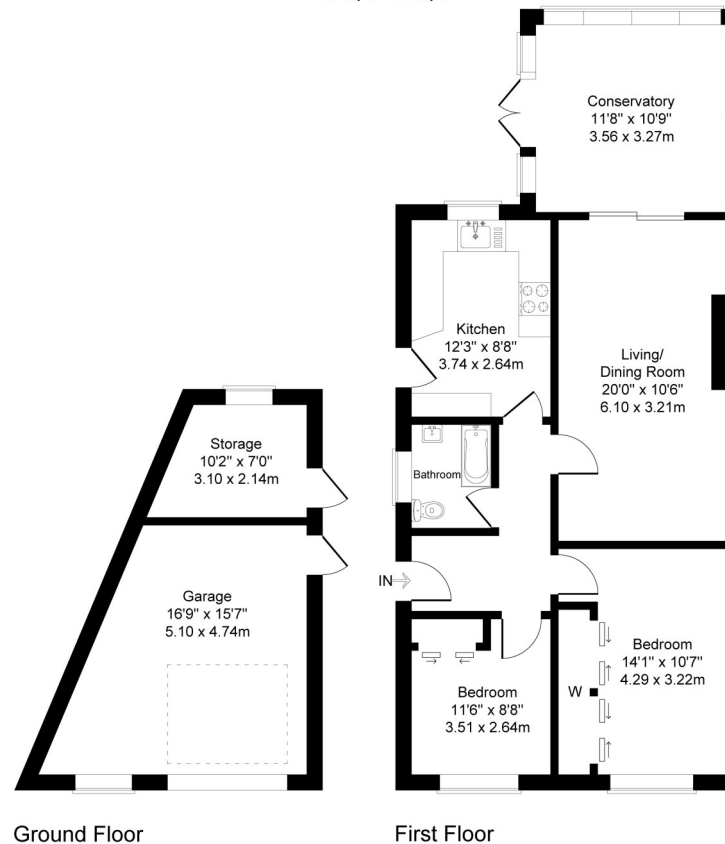

Illustration for identification purposes only, measurements are approximate, not to scale.

**TENURE AND SERVICES:** Tenure: Freehold. Local Authority: Dorset Council. Council Tax Band D - £2,565.39 for year 2025/2026. All mains services connected. Mains Drainage. Gas Central Heating. Fully double glazed.

**DECLARATION:** For clarification, we wish to inform prospective purchasers that we have prepared these particulars as a general guide. We have not carried out a detailed survey nor tested the services, appliances and specific fittings. Room sizes should not be relied upon for carpets and furnishings. The particulars do not constitute or form part of an offer or contract nor may they be regarded as representations. All interested parties must themselves verify their accuracy. Ref: 10817.