



Latimer Road

NORTH KENSINGTON W10



Latimer Road

NORTH KENSINGTON W10

A stunning flat to let with a large open plan reception room and loft style feel. The property boasts high ceilings and solid oak flooring in the reception room and has been furnished in a contemporary style.

Latimer Road situated in North Kensington W10, is well located for local shops and is within walking distance to White City Underground Station on the Central line. Westfield Shopping Centre is also within close proximity offering a cinema complex, excellent shopping and a wide array of restaurants.

LONG LET: £350 PER WEEK (FEES APPLY)
FURNISHED
LOCAL AUTHORITY: ROYAL BOROUGH OF
KENSINGTON AND CHELSEA
ENERGY RATING: F

OFFERS SUBJECT TO CONTRACT AND REFERENCES.

BEDROOM, BATHROOM, RECEPTION ROOM, KITCHEN.

CONSUMER PROTECTION FROM UNFAIR TRADING REGULATIONS 2008. THIS BROCHURE AND THE DESCRIPTIONS AND MEASUREMENTS HEREIN DO NOT CONSTITUTE REPRESENTATION AND WHILST EVERY EFFORT HAS BEEN MADE TO ENSURE ACCURACY, THIS CANNOT BE GUARANTEED.

NOTTING HILL LETTINGS

T 020 7221 5388

205 WESTBOURNE GROVE, LONDON W11 2SB

E PC@BECTIVE.CO.UK

WWW.BECTIVE.CO.UK

Approximate Gross Internal Area :- 54 sq m / 581 sq ft

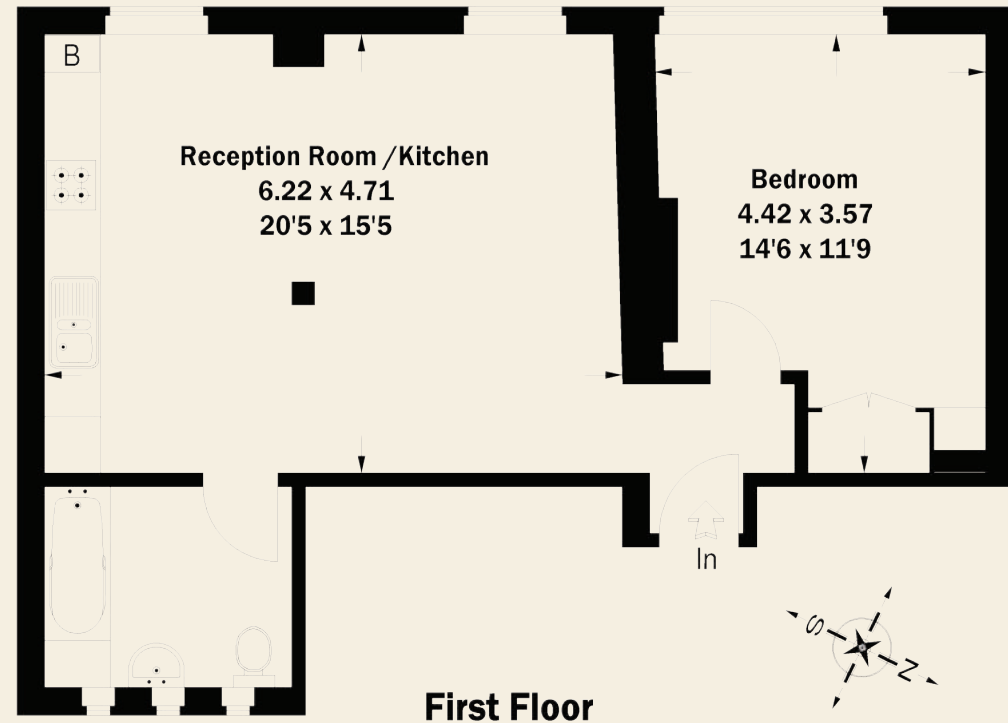

First Floor

BECTIVE
- LESLIE MARSH -