



EARL'S COURT SQUARE, SW5

£950,000

Share of Freehold
Two Double Bedrooms
West Facing
Private Garden Square
Low Service Charge
Circa 850SqFt

@marshandparsons
marshandparsons.co.uk

MARSH &
PARSONS



ABOUT THE PROPERTY

An exceptional, laterally arranged two-bedroom triple aspect apartment, positioned on the third floor of this beautiful stuccoed-conversion on this much-admired garden square. The apartment offers just under 850SqFt of well-presented accommodation boasting a usable square layout with bright and expansive rooms. The reception room is larger-than-average, and dual aspect, with space for dining. There's a separate kitchen and both bedrooms are well proportioned doubles with built-in storage to the master.



STEP INSIDE EARL'S COURT SQUARE

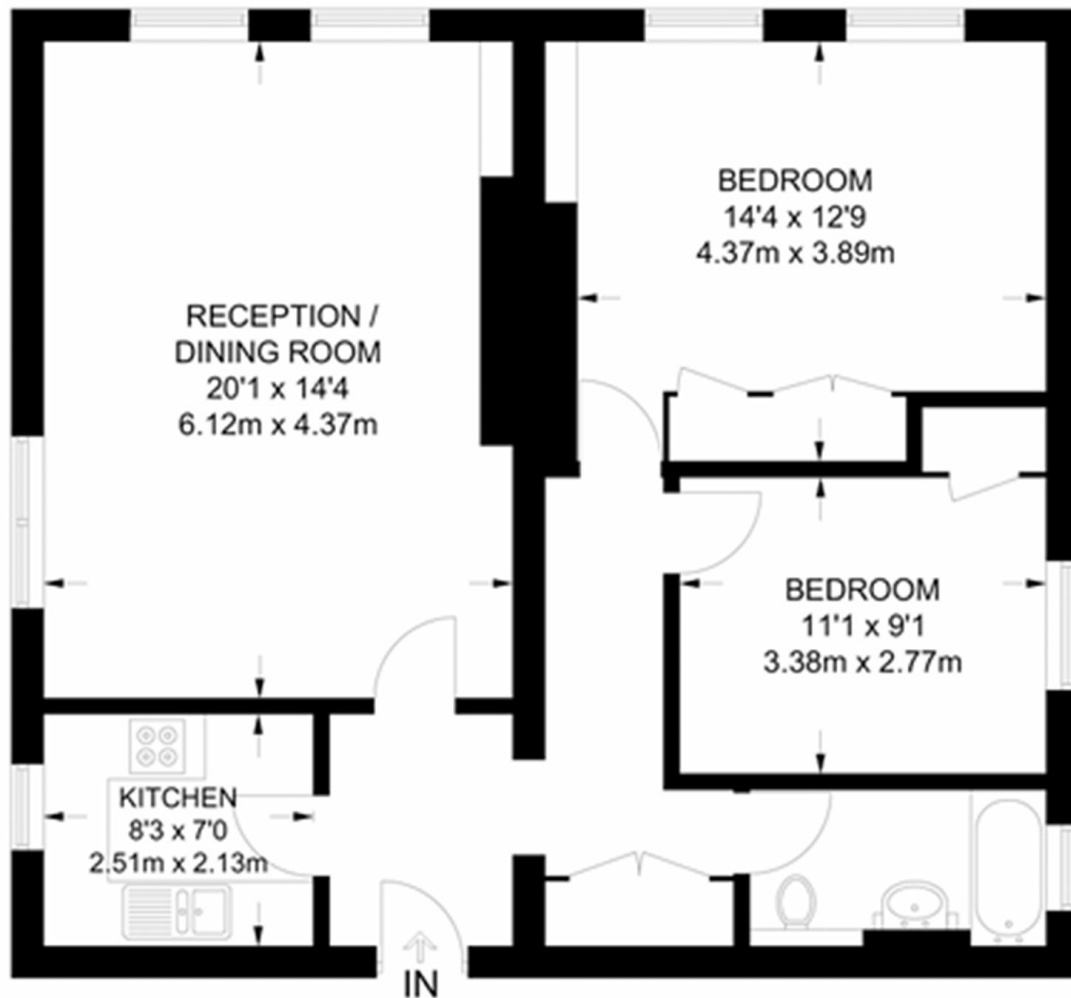

THIRD FLOOR

APPROXIMATE GROSS INTERNAL AREA
842 SQ FT / 78.2 SQ M

This plan has been drawn for illustrative and identification purposes only.

Earls Court
020 7590 0800

Energy Rating: We aim to make our particulars both accurate and reliable. However, they are not guaranteed; nor do they form part of an offer or contract. If you require clarification on any points then please contact us, especially if you're traveling some distance to view. Please note that appliances and heating systems have not been tested and therefore no warranties can be given as to their good working order

MARSH &
PARSONS