



Vanilla & Sesame Court

Curlew Street, SE1

Asking Price £500,000

Stylish One-Bedroom Warehouse Apartment in the Heart of Shad Thames

CHESTERTONS



Vanilla & Sesame Court

Curlew Street, SE1

- Stylish one-bedroom warehouse apartment
- Spacious double bedroom
- Modern kitchen and bathroom
- Bright, airy living room
- Secure entry with lift
- Dedicated caretaker on-site
- Allocated parking space included
- Prime Shad Thames location



This beautifully presented one-bedroom Warehouse apartment offers the perfect combination of modern living and historic character, making it an ideal Pied-à-Terre or investment opportunity in one of London's most sought-after locations. Situated within the prestigious Vanilla and Sesame Court development, the apartment benefits from a spacious double bedroom with built-in wardrobes, a contemporary bathroom, and a stylish kitchen finished to a high standard. The bright and airy living room provides an inviting space to relax or entertain, flooded with natural light. Residents enjoy secure entry, lift access, and the support of a dedicated caretaker, adding both convenience and peace of mind. Additionally, the apartment comes with an allocated parking space — a valuable asset in this central London location.

Set just moments from the River Thames, Shad Thames is known for its vibrant atmosphere, combining historic charm with a dynamic social scene. The neighbourhood boasts an array of world-class restaurants, trendy bars, and cosy cafés, all within easy walking distance. You'll be close to key landmarks such as London Bridge Station, Bermondsey Street, Maltby Street Market, St Katharine Docks, and Borough Market. With excellent transport links nearby, this apartment offers superb access to everything London has to offer, whether you're seeking a peaceful riverside retreat or a stylish base from which to explore the city's rich culture.

Tenure: Share of Freehold 973 years 5 months
Service Charge: £5200 pa
Ground Rent: £0
Local Authority: London Borough of Southwark
Council Tax Band: E

Score	Energy rating	Current	Potential
92+	A		
81-91	B		
69-80	C	79 C	82 B
55-68	D		
39-54	E		
21-38	F		
1-20	G		

Chestertons Tower Bridge Sales

220 Tower Bridge Road
Tower Bridge
London
SE1 2UP
towerbridge@chestertons.co.uk
020 7357 7999
chestertons.co.uk

Vanilla & Sesame Court,
Curlew Street, SE1

○ - Ceiling Height

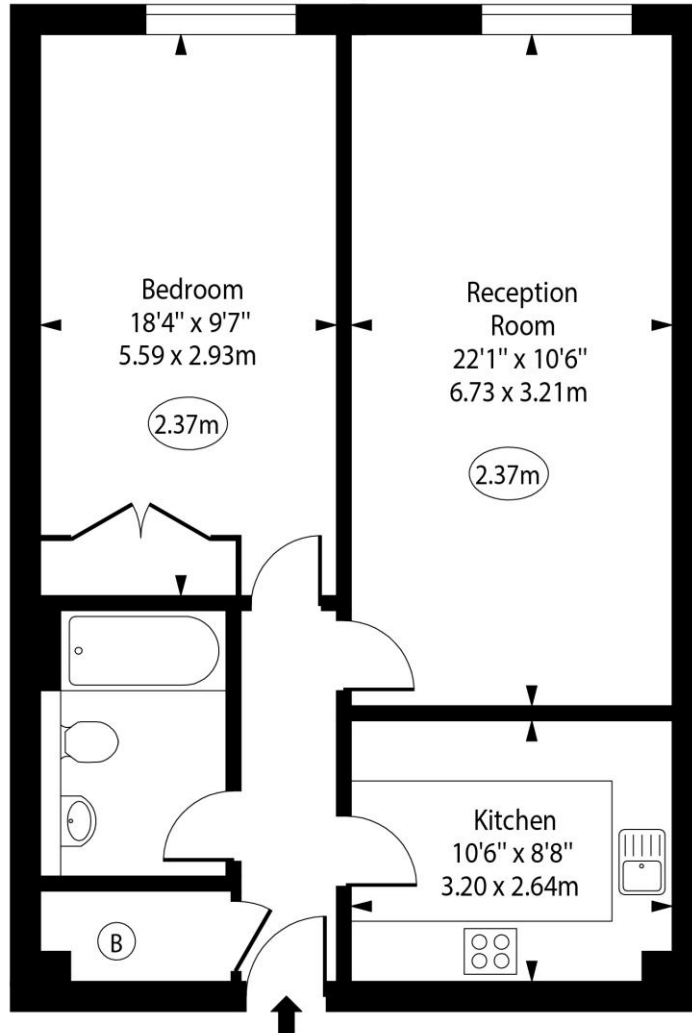

Fifth Floor

Approx Gross Internal Area 640 Sq Ft - 59.45 Sq M

Every attempt has been made to ensure the accuracy of the floor plan shown.
However, all measurements, fixtures, fittings, and data shown are approximate interpretations and
for illustrative purposes only.

Measured according to the RICS IPMS 2. Not To Scale.

www.goldlens.co.uk

Ref. No. 027915J

