

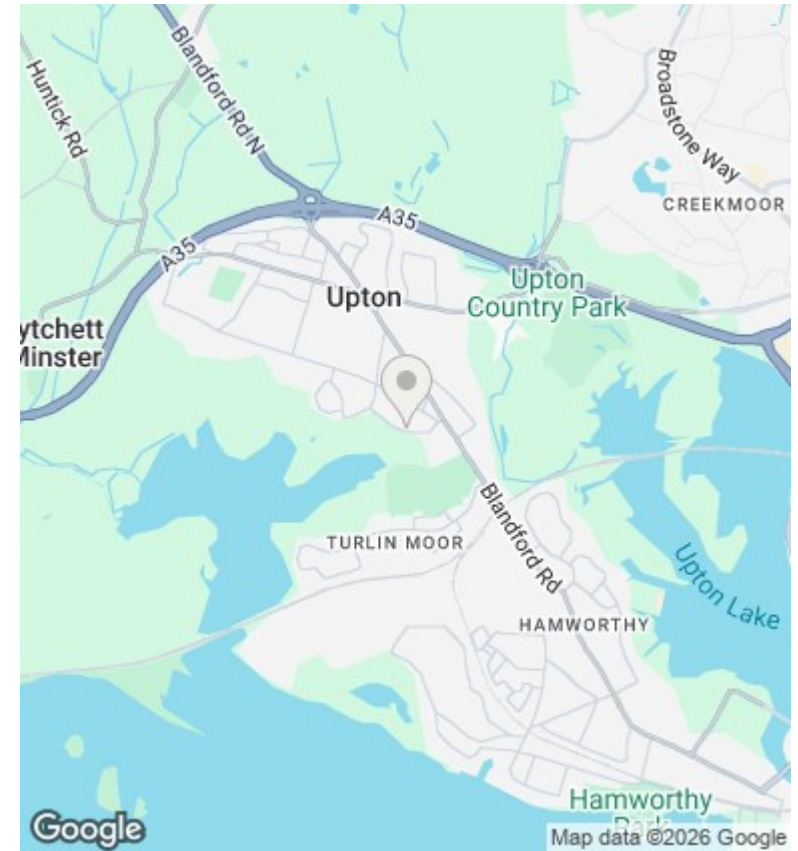

24 Tree Hamlets, Upton, Poole, BH16 5SA

£1,250 PCM

- Three Bedrooms
- South Facing Terrace
- Sought After Location
- Viewing Encouraged!
- First Floor Maisonette
- UPVC Double Glazing/GCH
- Private Entrance
- Lounge/Dining Room
- Parking Available
- Available End of May

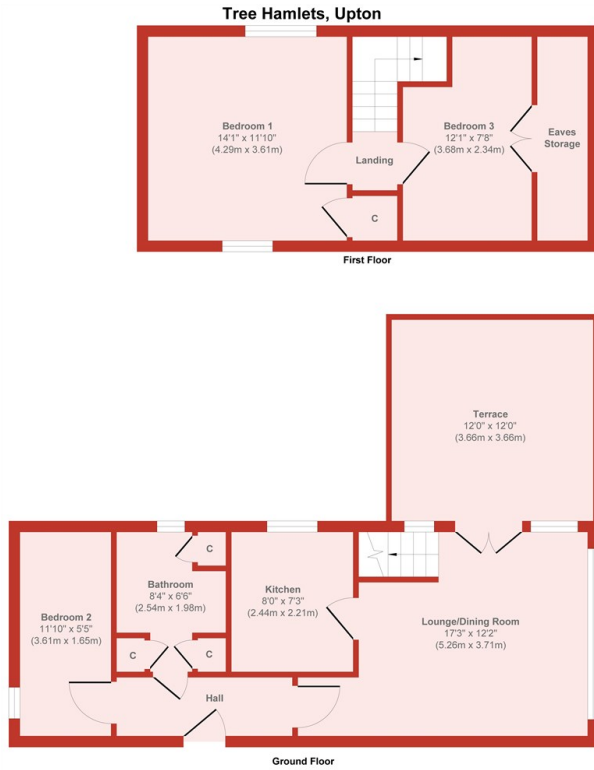

Directions

Viewings

Viewings by arrangement only. Call 01202 622101 to make an appointment.

Council Tax Band

EPC Rating:

Energy Efficiency Rating		
	Current	Potential
<i>Very energy efficient - lower running costs</i>		
(92 plus) A		
(81-91) B		
(69-80) C		
(55-68) D		
(39-54) E		
(21-38) F		
(1-20) G		
<i>Not energy efficient - higher running costs</i>		
England & Wales	EU Directive 2002/91/EC	