



IVOR COURT, NW1

£750,000

Two double bedrooms

South facing views

Lift

Porter

Long lease

Energy rating: e

@marshandparsons
marshandparsons.co.uk

MARSH &
PARSONS



ABOUT THE PROPERTY

A well-presented two double bedroom apartment located on the seventh floor (w/lift) of this highly sought after portered period block in Marylebone.

Ivor Court has just undergone a full refurbishment in its communal parts and is located moments from the wide-open spaces of Regents Park. Transport links can be found at Baker Street Underground Station (Hammersmith & City, Bakerloo, Jubilee, Circle and Metropolitan, Zone 1) which is under a five-minute walk away as well as underground and overland services from Marylebone Station (Bakerloo Line, Zone 1 & National Rail Services).



STEP INSIDE IVOR COURT

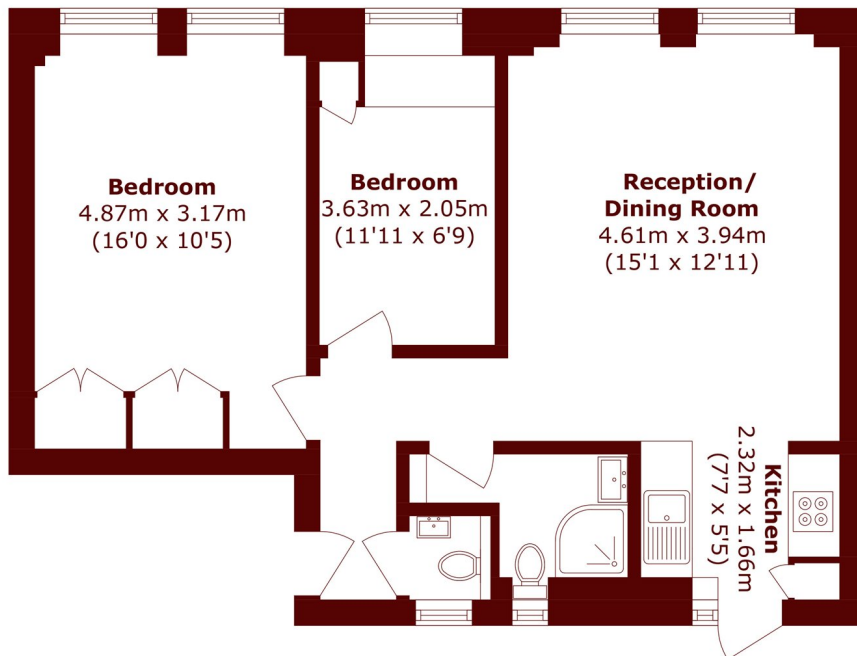

Seventh Floor

Total area (approx.): 56.1 sq. m (603.9 sq. ft)

Marylebone & Mayfair
020 7935 1775

Energy Rating: E We aim to make our particulars both accurate and reliable. However, they are not guaranteed; nor do they form part of an offer or contract. If you require clarification on any points then please contact us, especially if you're traveling some distance to view. Please note that appliances and heating systems have not been tested and therefore no warranties can be given as to their good working order

MARSH &
PARSONS