

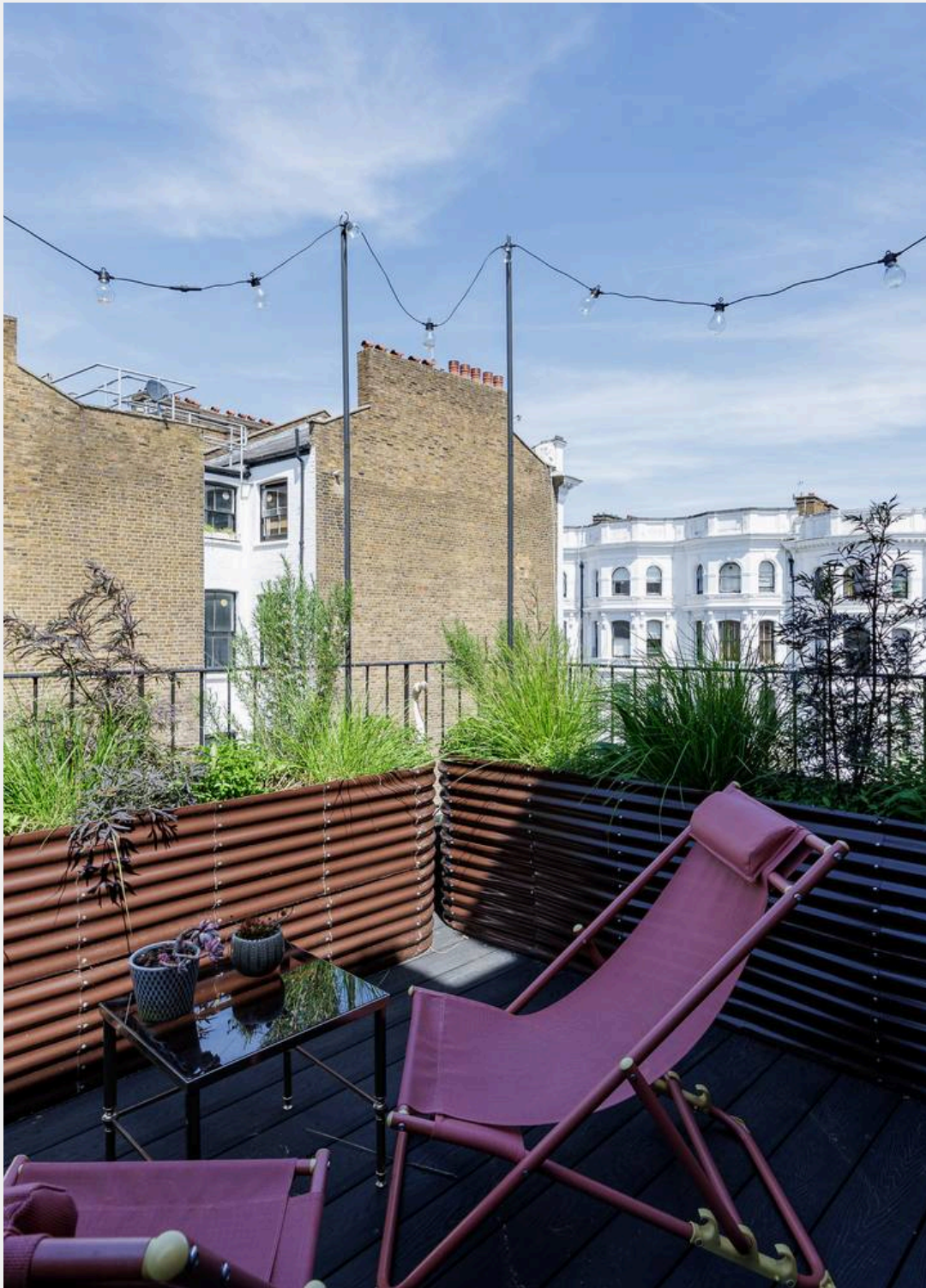

Powis Square

W11

£925,000



Powis Square

A bright two bedroom flat with a roof terrace and stunning views to the front and rear, moments from All Saints Road, Westbourne Grove and Portobello.

The flat has been comprehensively refurbished throughout by the current owner. The kitchen is open-plan to the living room with two large windows facing south across Powis Square. Moving to the rear is the bathroom and two bedrooms. One leads out on to a large roof terrace with plenty of entertaining space and views of the historic Tabernacle.

Powis Square is set around the green open spaces of the square. It is excellently located moments from all the areas most in demand cafes, shops and restaurants.

Powis Square

Council Tax band: E

Tenure: Share of Freehold

- Bright and refurbished flat
- Two bedrooms
- Roof terrace with views of the Tabernacle
- Open plan kitchen living room with south facing views across Powis Square





Powis Square, W11

Approximate Gross Internal Area 50 sq m / 536 sq ft

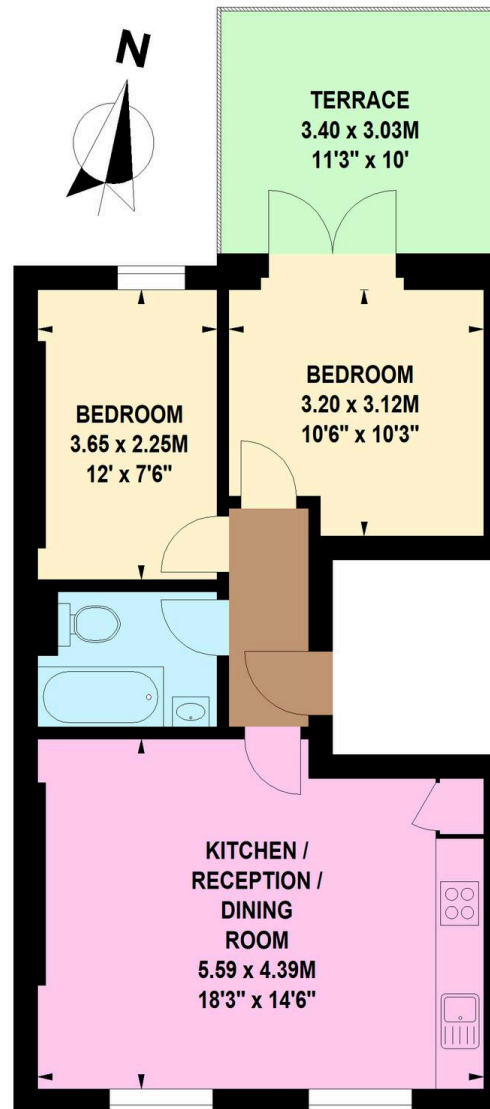

Fourth Floor

Floor Plan produced for Michael Graham by Mays Floorplans © . Tel 020 3397 4594

Illustration for identification purposes only, not to scale

All measurements are maximum, and include wardrobes and window bays where applicable



Rigby & Marchant

115 Westbourne Studios 242 Acklam Road, London - W10 5JJ

020 7221 7210

chris@rigbyandmarchant.co.uk

www.rigbyandmarchant.co.uk/

R&M