

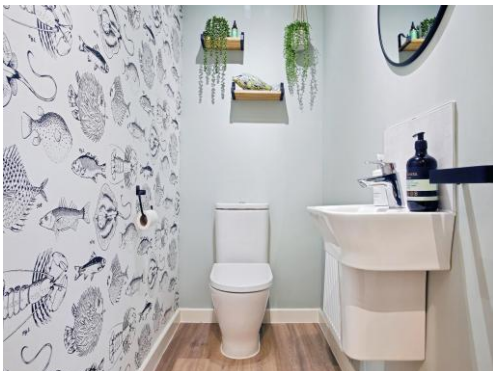

**Connells**

Hancock Drive  
Amesbury Salisbury





## Property Description

A high specification and superbly presented Bloor built town house featuring a whole top floor master suite, stylish kitchen/ dining room and good size garden plus driveway for two cars. The property is located minutes from the A303 and Salisbury.

### Entrance Hall

Stairs to first floor landing, door to lounge.

### Cloakroom

Comprising a WC and wash hand basin.

### Lounge

Built in cupboard, front aspect.

### Kitchen/ Dining Room

Comprising a single drainer sink unit with mixer tap. stylish range of wall and base units with work surfaces over, built in double oven, inset hob unit with hood over, Integrated dishwasher and fridge/freezer, downlighter spots, rear aspect with French doors to garden.

### Utility Area

Wall and base unit with work surface over and space for washing machine, door to cloakroom.

### First Floor Landing

Stairs to whole top floor master suite, built in cupboard,

### Bedroom Two

Rear aspect.

### Bedroom Three

Front aspect.

### Bathroom

Comprising a panel enclosed bath with pedestal wash hand basin, WC and heated towel rail.

### Second Floor Master Suite

### Master Landing

### Master Bedroom

Front aspect.

### Ensuite

Comprising a double shower cubicle with wash hand basin and WC, heated towel rail, Velux style window.

## Outside

## Rear Garden

Laid to lawn with patio and gated side access.

## Double Length Driveway

For two cars.











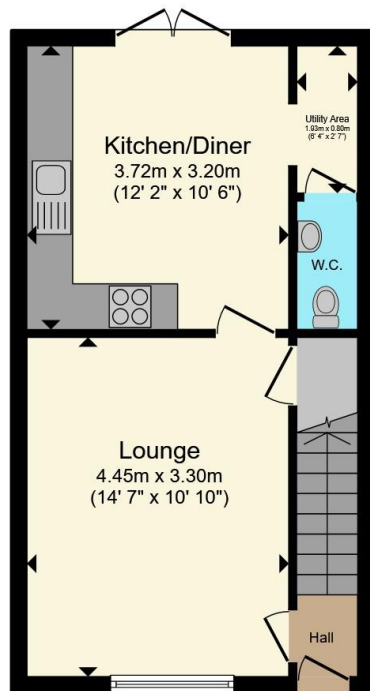

**Ground Floor**

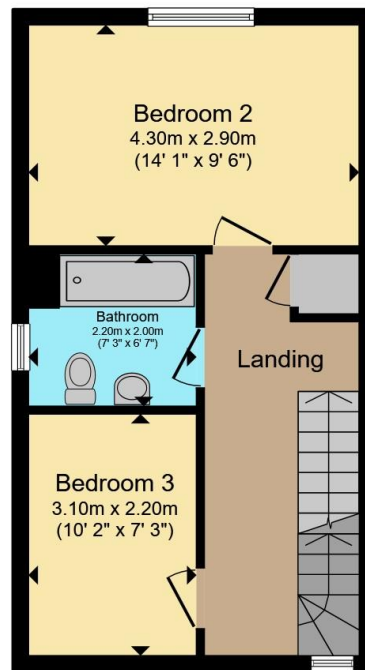

**First Floor**

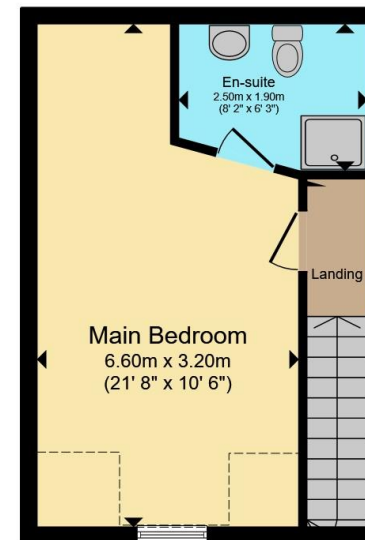

**Second Floor**

Total floor area 100.2 m<sup>2</sup> (1,078 sq.ft.) approx

This floor plan is for illustrative purposes only. It is not drawn to scale. Any measurements, floor areas (including any total floor area), openings and orientation are approximate. No details are guaranteed, they cannot be relied upon for any purpose and they do not form part of any agreement. No liability is taken for any error, omission or misstatement. A party must rely upon its own inspection(s). Powered by [www.propertybox.io](http://www.propertybox.io)

**Connells**

To view this property please contact Connells on

**T 01980 622 662**  
**E [amesbury@connells.co.uk](mailto:amesbury@connells.co.uk)**

Unit 3 23 Salisbury Street AMESBURY  
SALISBURY SP4 7AW

EPC Rating: B Council Tax  
Band: D

Tenure: Freehold

**view this property online [connells.co.uk/Property/ABY308566](http://connells.co.uk/Property/ABY308566)**



1. MONEY LAUNDERING REGULATIONS Intending purchasers will be asked to produce identification documentation at a later stage and we would ask for your co-operation in order that there will be no delay in agreeing the sale. 2. These particulars do not constitute part or all of an offer or contract. 3. The measurements indicated are supplied for guidance only and as such must be considered incorrect. Potential buyers are advised to recheck measurements before committing to any expense. 4. We have not tested any apparatus, equipment, fixtures, fittings or services and it is in the buyers interest to check the working condition of any appliances.

Connells Residential is registered in England and Wales under company number 1489613, Registered Office is Cumbria House, 16-20 Hockliffe Street, Leighton Buzzard, Bedfordshire, LU7 1GN. VAT Registration Number is 500 2481 05.

**See all our properties at [www.connells.co.uk](http://www.connells.co.uk) | [www.rightmove.co.uk](http://www.rightmove.co.uk) | [www.zoopla.co.uk](http://www.zoopla.co.uk)**

Property Ref: ABY308566 - 0004