



Property Features

- Luxury Detached Home
- Private Gated Entrance
- High Specification Throughout
- 3 Double Bedrooms (All With En-Suites)
- 3 Reception Rooms
- Kitchen/Dining/Family Room
- Good School Catchment
- Ground Floor Underfloor Heating
- Integral Garage and Private Gardens
- Unfurnished

Full Description

Introducing a stunning development of just 3 individually designed Detached Homes located in the sought-after Buckinghamshire village of Whitchurch, Aylesbury.

As you step through the front door, you are welcomed into a spacious and welcoming hallway which leads you to a beautifully designed kitchen/dining/family room. The kitchen has a contemporary design and is fully equipped with high-quality integrated appliances and quartz worktops, while the family area is ideal for spending valuable time with family and friends and the dining room is ideal for entertaining. Additionally, there is a double aspect living room which offers plenty of natural light and has double doors leading on to the rear patio and private garden, creating a serene ambience.

Furthermore, this property comprises of a well-designed home office, which is perfect for those who work from home, and a generous cloakroom located on the ground floor. The kitchen also benefits from a utility room, offering ample storage space and an additional sink.

Upstairs, you will discover three spacious double bedrooms, all of which have their own private ensuite shower rooms, providing comfort and privacy with the principal bedroom benefitting from fitted wardrobes. The contemporary design of the bedrooms and bathrooms is sure to impress.

Externally, the property boasts a private garden and large patio that are perfect for entertaining guests or simply enjoying a peaceful evening outdoors. To the front, there is parking space for two cars and an integral garage, providing additional parking.

In terms of schooling, there are a number of excellent schools in the area, including Whitchurch Combined School, and Aylesbury Grammar School which is a selective boy's school. For transport links, the Aylesbury train station is approximately three miles away, providing easy access to nearby towns such as Oxford, London and Milton Keynes. Moreover, the property is conveniently located close to the A41 and M25, making it easy to travel to the surrounding areas.

Whitchurch offers several noteworthy attractions such as St Johns church, The White Swan public house (1600's) and The Firs, a secret location used to make weapons in WW2, known as Winston Churchills toyshop. Whitchurch also has a minimarket, post office, beauty salon and hairdressers. Nearby town, Aylesbury, offers an excellent range of shops including a Marks & Spencer, Waitrose and a number of quality independent restaurants and retailers. Overall, this detached house in Appleyard Close, Whitchurch, Aylesbury is an exceptional property that offers luxury, space and comfort. This property is ideal for those who appreciate quality and a well-designed home in a desirable location.





1 Appleyard Close, Whitchurch

Approx. Total Area: 2072.01 ft²192.50 m²

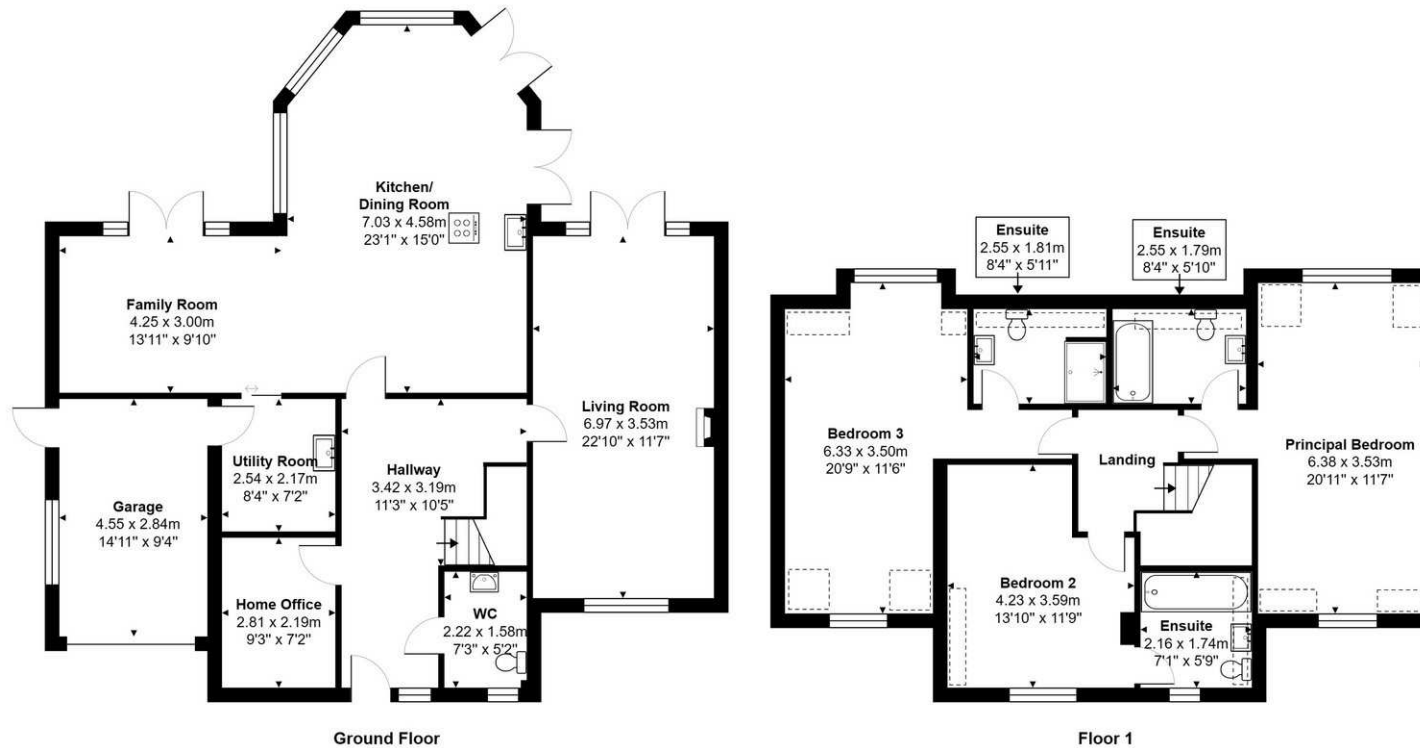

Whilst every attempt has been made to ensure the accuracy of the floorplans contained here, measurements of doors, windows and rooms are approximate and no responsibility is taken for any error, omission or mis-statement. These plans are for representation purposes only.

Kingshills Estate Agents
C1C Comet Studios
Amersham
Buckinghamshire
HP7 0PX

01494 939868
hello@kingshills.co.uk
kingshills.co.uk

Agents Note: Whilst every care has been taken to prepare these particulars, they are for guidance purposes only. All measurements are for general guidance purposes only and whilst every care has been taken to ensure accuracy, they should not be relied upon and potential buyers/tenants are advised to recheck the measurements