



**Connells**

Cicero Crescent  
Fairfields Milton Keynes



## Property Description

This beautifully maintained and thoughtfully updated three-bedroom mid-terrace home offers modern living in a prime family-friendly location.

The property boasts well-proportioned and contemporary accommodation throughout, creating a bright and welcoming atmosphere ideal for both everyday living and entertaining. The spacious layout is complemented by a private rear garden, perfect for outdoor dining and relaxation.

Positioned within an excellent school catchment area, this home is perfectly suited to families, while also benefiting from convenient access to Central Milton Keynes, the A5, and the M1—making it ideal for commuters.

The ground floor opens with a bright and inviting entrance hall, leading through to an impressive open-plan kitchen dining space. This area is fitted with contemporary units, generous work surfaces, and integrated appliances, creating a sleek yet practical environment ideal for both everyday living and hosting. In addition, the ground floor has a convenient cloakroom and study to the front of the property.

To the first floor is a bright and airy Living room, along with a well proportioned bedroom and family Shower. The 2nd floor offers two further double bedrooms and family bathroom.

Externally, the home benefits from a private rear garden and allocated parking for 3 vehicles.

A fantastic opportunity to acquire a modern, move-in-ready home in one of Milton Keynes' most sought-after locations.

## Entrance Hall

Doors to ground floor accommodation and stairs rising to first floor.

## Cloakroom

WC, Sink .

## Study

Window to front aspect.

## Kitchen / Dining

Patio doors to garden. Range of wall and base units. Built in appliances.

## 1st Floor

## Living Room

Window to front aspect.

## Bedroom 1

Well proportioned bedroom with window to rear aspect.

### **Shower Room**

WC, Sink and Shower.

### **2nd Floor**

#### **Bedroom 2**

Window to front aspect.

#### **Bedroom 3**

Sky Light Windows.

### **Family Bathroom**

Bath with overhead shower, Wc and sink.

### **Garden**

Mainly laid to lawn with patio area, Rear gated access.

### **Parking**

Allocated parking.







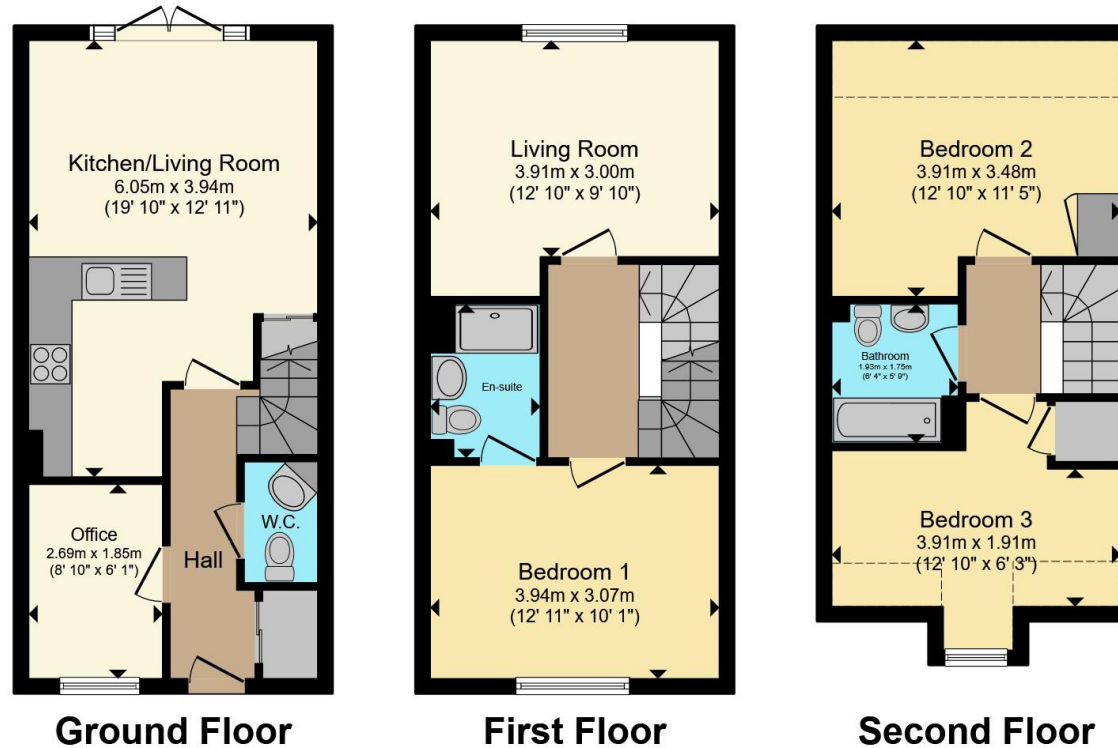

Total floor area 102.6 m<sup>2</sup> (1,105 sq.ft.) approx

This floor plan is for illustrative purposes only. It is not drawn to scale. Any measurements, floor areas (including any total floor area), openings and orientation are approximate. No details are guaranteed, they cannot be relied upon for any purpose and they do not form part of any agreement. No liability is taken for any error, omission or misstatement. A party must rely upon its own inspection(s). Powered by [www.propertybox.io](http://www.propertybox.io)

**Connells**

To view this property please contact Connells on

**T 01908 563 993**  
**E [stonystratford@connells.co.uk](mailto:stonystratford@connells.co.uk)**

82 High Street Stony Stratford  
 MILTON KEYNES MK11 1AH

EPC Rating: B Council Tax  
 Band: D

Tenure: Freehold

**view this property online [connells.co.uk/Property/SSD307823](http://connells.co.uk/Property/SSD307823)**



1. MONEY LAUNDERING REGULATIONS Intending purchasers will be asked to produce identification documentation at a later stage and we would ask for your co-operation in order that there will be no delay in agreeing the sale. 2. These particulars do not constitute part or all of an offer or contract. 3. The measurements indicated are supplied for guidance only and as such must be considered incorrect. Potential buyers are advised to recheck measurements before committing to any expense. 4. We have not tested any apparatus, equipment, fixtures, fittings or services and it is in the buyers interest to check the working condition of any appliances.

Connells Residential is registered in England and Wales under company number 1489613, Registered Office is Cumbria House, 16-20 Hockliffe Street, Leighton Buzzard, Bedfordshire, LU7 1GN. VAT Registration Number is 500 2481 05.

**See all our properties at [www.connells.co.uk](http://www.connells.co.uk) | [www.rightmove.co.uk](http://www.rightmove.co.uk) | [www.zoopla.co.uk](http://www.zoopla.co.uk)**

Property Ref: SSD307823 - 0004