



Family home close to Purley station

exclusive to

**SAUNDERS**

[richardsaunders.co.uk](http://richardsaunders.co.uk)

# Purley CR8

Purley high street 1.4 miles  
London by rail 40 minutes  
M25 (Junction 6) 6.5 miles

All times and distances are approximate

This immaculately kept five bedroom end of terrace family home comes to market having been recently refurbished. The property is situated on a quiet road close to central Purley and within short walk of Purley Station, which is a commuters dream.

To Let £1,900 pcm





Available March | Five Bedrooms |  
 Unfurnished | Recently Refurbished | Walking  
 Distance To Purley Station | Gas Central  
 Heating | On Road Parking | Rear Enclosed  
 Garden | Double Glazing | Spacious Living |

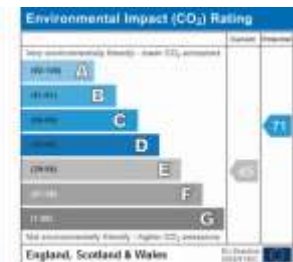

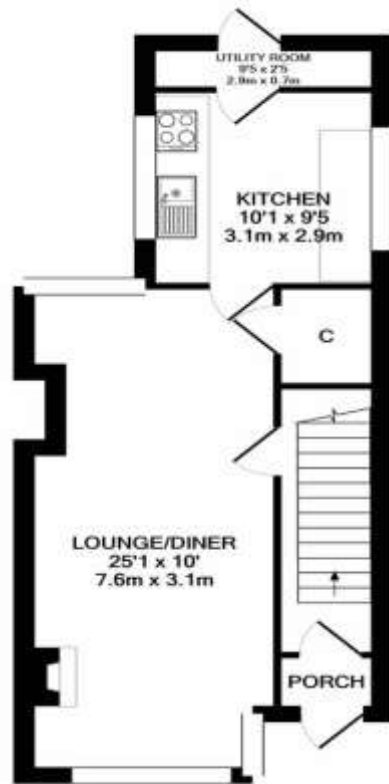

GROUND FLOOR  
APPROX. FLOOR  
AREA 451 SQ.FT.  
(41.9 SQ.M.)



1ST FLOOR  
APPROX. FLOOR  
AREA 412 SQ.FT.  
(38.3 SQ.M.)



2ND FLOOR  
APPROX. FLOOR  
AREA 321 SQ.FT.  
(29.9 SQ.M.)

TOTAL APPROX. FLOOR AREA 1185 SQ.FT. (110.1 SQ.M.)  
Made with Metropix ©2020

discover more at [richardsaunders.co.uk](http://richardsaunders.co.uk)



IMPORTANT NOTICE TO TENANTS: We endeavour to make our lettings particulars accurate and reliable, however, they do not constitute or form part of an offer or any contract and none is to be relied upon as statements of representation or fact. The services, systems and appliances listed in this specification have not been tested by us and no guarantees as to their operating ability or efficiency are given. All measurements have been taken as guide to prospective buyers only, and are not precise. If you require clarification or further information on any points, please contact us, especially if you are travelling some distance to view.

Viewing  
Please call us to arrange  
a viewing appointment

1 Waterhouse Lane  
Kingswood  
01737 360000

2 High Street  
Banstead  
01737 363333

Residential Lettings  
All Areas  
01737 370700

**SAUNDERS**

[richardsaunders.co.uk](http://richardsaunders.co.uk)