



**The Cottage, 2 Court Close, Maidenhead SL6 2DL**



**welcome to**

**The Cottage, 2 Court Close, Maidenhead**

Nestled within a quiet and sought-after cul-de-sac, a charming three-bedroom detached home that perfectly balances character, comfort and convenience. From the moment you arrive, this delightful property creates a welcoming first impression, offering an ideal opportunity for families.





## Court Close, Maidenhead, SL6

Approximate Area = 1238 sq ft / 115 sq m

Garage = 149 sq ft / 13.8 sq m

Outbuilding = 28 sq ft / 2.6 sq m

Total = 1415 sq ft / 131.4 sq m

For identification only - Not to scale

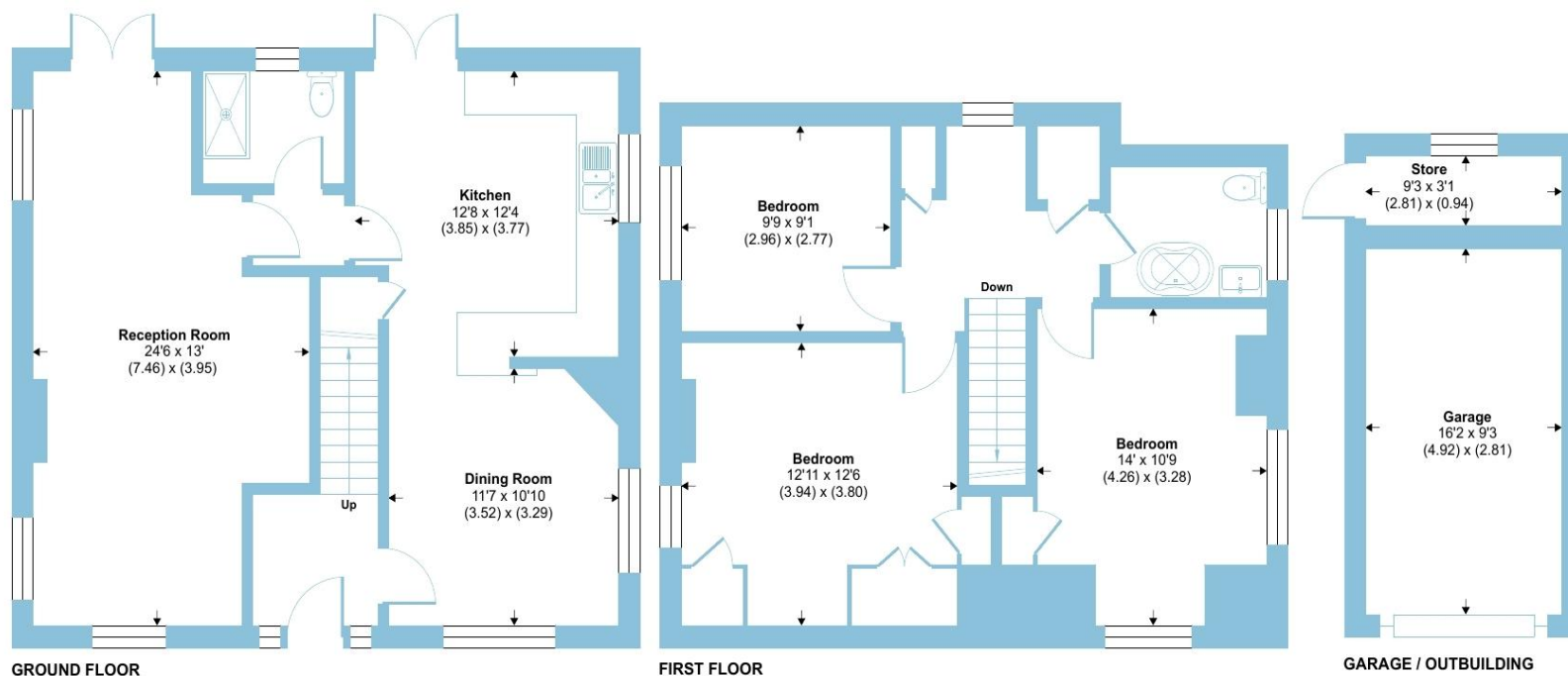

Floor plan produced in accordance with RICS Property Measurement 2nd Edition, Incorporating International Property Measurement Standards (IPMS2 Residential). © nchecom 2025. Produced for Barnard Marcus. REF: 1387686



The accommodation is well-proportioned and thoughtfully arranged, providing a flexible layout that suits modern living. The ground floor offers a warm and inviting atmosphere, with living spaces that lend themselves equally well to everyday family life and entertaining. Natural light flows through the home, enhancing the sense of space and creating a bright, airy feel throughout.

Upstairs, three well-sized bedrooms provide comfortable and versatile accommodation, whether for family members, guests or a home office. The layout allows for privacy and practicality, making the property adaptable to a variety of lifestyles. The home also offers further potential for buyers wishing to personalise or enhance the space to their own tastes, subject to the usual consents.

Externally, the property benefits from its detached position, providing a sense of privacy and independence. The surrounding outdoor space offers an excellent opportunity for relaxation, gardening or outdoor dining, while still being easy to maintain. The quiet setting of Court Close makes this an especially attractive option for those looking to enjoy a peaceful residential environment.

Conveniently located in Maidenhead, the property is well placed for access to local amenities, schools, and transport links, including road and rail connections to nearby towns and London. Combining charm, location and potential, Court Close represents a wonderful opportunity to secure a detached home in a desirable area.

**welcome to**

## **The Cottage, 2 Court Close, Maidenhead**

- SOUGHT-AFTER CUL DE SAC
- IDEAL OPPORTUNITY FOR FAMILIES
- WELL PLACED FOR ACCESS TO LOCAL AMENITIES
- CHARMING DETACHED HOME
- THREE WELL SIZED BEDROOMS
- EASY MAINTENANCE REAR GARDEN

Tenure: Freehold EPC Rating: D

Council Tax Band: F

**£950,000**



Please note the marker reflects the  
postcode not the actual property

**check out more properties at [rogerplatt.co.uk](https://rogerplatt.co.uk)**



Property Ref:  
MHD118618 - 0001

1. MONEY LAUNDERING REGULATIONS Intending purchasers will be asked to produce identification documentation at a later stage and we would ask for your co-operation in order that there is no delay in agreeing the sale. 2. These particulars do not constitute part or all of an offer or contract. 3. The measurements indicated are supplied for guidance only and as such must be considered incorrect. Potential buyers are advised to recheck measurements before committing to any expense. 4. We have not tested any apparatus, equipment, fixtures or services and it is in the buyers interest to check the working condition of any appliances. 5. Where an EPC, or a Home Report (Scotland only) is held for this property, it is available for inspection at the branch by appointment. If you require a printed version of a Home Report, you will need to pay a reasonable production charge reflecting printing and other costs. 6. We are not able to offer an opinion either written or verbal on the content of these reports and this must be obtained from your legal representative. 7. Whilst we take care in preparing these reports, a buyer should ensure that his/her legal representative confirms as soon as possible all matters relating to title including the extent and boundaries of the property and other important matters before exchange of contracts.

Roger Platt is a trading name of Sequence (UK) Limited which is registered in England and Wales under company number 4268443, Registered Office is Cumbria House, 16-20 Hockliffe Street, Leighton Buzzard, Bedfordshire, LU7 1GN. VAT Registration Number is 500 2481 05.

roger platt



**01628 773333**



**Maidenhead@rogerplatt.co.uk**



**25-29 Queen Street, MAIDENHEAD, Berkshire,  
SL6 1NB**



**[rogerplatt.co.uk](https://rogerplatt.co.uk)**