

Croft Close, Thirsk YO7 2DA

£525,000

Stephensons
estate agents & chartered surveyors



A beautifully presented 4 bedroom detached village home featuring extended ground floor living accommodation, en-suite shower room to the principal bedroom, double garage and an idyllic rear garden.

Tenure: Freehold
 Services/Utilities: Electricity, Water and Sewerage are understood to be connected
 Broadband: Up to 1600 Mbps* download speed
 EPC Rating: D - 62
 Council Tax: E - North Yorkshire Council
 Current Planning Permission: No current valid planning permissions

*Download speeds vary by broadband providers so please check with them before purchasing.



A reception hall with cloakroom/wc leads off into a 21'62" (6.45m) long dual aspect living room with contemporary log burning fire and access through into a formal dining area and a stunning architect designed garden room added in 2020 that features oak flooring with underfloor heating, remote control blinds and 2 sliding doors allowing access out into the beautifully landscaped rear garden.

The original 1990's 15'5" (4.70m) long kitchen/breakfast room provides generous storage, extensive worktop space and an integrated double oven and touch control hob complemented by a useful utility room leading off.

The first floor landing leads off into a principal bedroom with fitted wardrobes, rural glimpses and en-suite shower room, 3 further bedrooms (all with rural glimpses, 1 with a built-in wardrobe and 1 currently used as a study with fitted office furniture) and a house bathroom.

Other internal features of note include double glazing and an oil fired central heating system.

The pretty front garden provides a low maintenance area and a block paved double width driveway provides parking and access into a double garage with both light and power connected.

The beautifully landscaped rear garden enjoys a high degree of privacy and features a sculptured lawn, paved seating area, potting shed and well stocked flower and shrub bed borders complemented by glimpses of the White Horse.

AGENTS NOTE

Imagery Disclaimer: Some photographs and videos within these sales particulars may have been digitally enhanced or edited for marketing purposes. They are intended to provide a general representation of the property and should not be relied upon as an exact depiction.

DON'T MISS OUT ON YOUR NEXT HOME

Last year, our social media content reached over 6.7 million views. By following Stephensons, you'll get exclusive video content, pre-market property teasers, off-market opportunities and early access to new listings before they appear online. Follow us today and stay one step ahead of other house hunters. Simply search @stephensons1871 on your favourite social media platform and start exploring.

Croft Close, Carlton Husthwaite, York, YO7 2DA

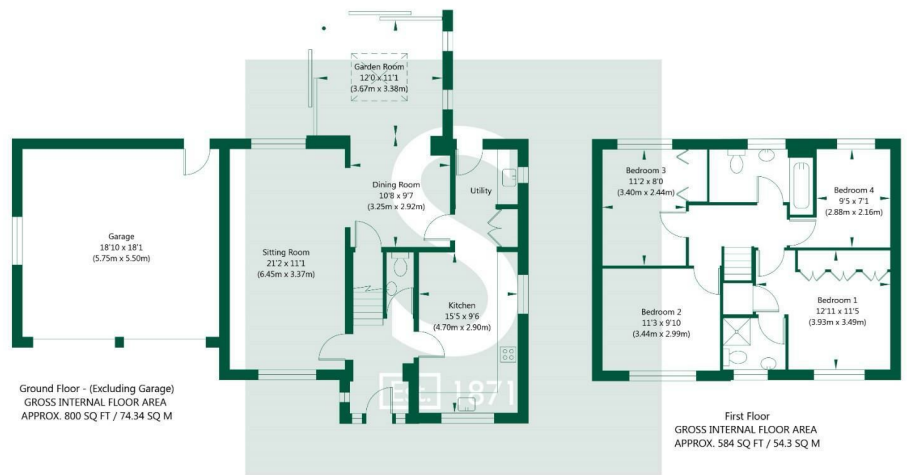

NOT TO SCALE - FOR ILLUSTRATIVE PURPOSES ONLY
 APPROXIMATE GROSS INTERNAL FLOOR AREA 1384 SQ FT / 128.64 SQ M - (Excluding Garage)
 All measurements and fixtures including doors and windows are approximate and should be independently verified.
 www.exposurepropertymarketing.com © 2024



Partners:

- J F Stephenson MA (Cantab) FRICS FAAV
- I E Reynolds BSc (Est Man) FRICS
- R E F Stephenson BSc (Est Man) MRICS FAAV
- N J C Kay BA (Hons) pg. dip MRICS
- O J Newby FNAEA
- J E Reynolds BA (Hons) MRICS
- R L Cordingley BSc FRICS FAAV
- J C Drewniak BA (Hons)
- E G Newby MRICS
- T Brooks MNAEA

York: 01904 625533
 Boroughbridge: 01423 324324
 Easingwold: 01347 821145
 Selby: 01757 706707
 Haxby: 01904 809900

Associate Partners:

- N Lawrence
- I Jarvis MNAEA