



4 Brows Lane

Formby, L37 3HZ

Offers in the region of £725,000



4 Brows Lane

Formby, L37 3HZ

Offers in the region of £725,000

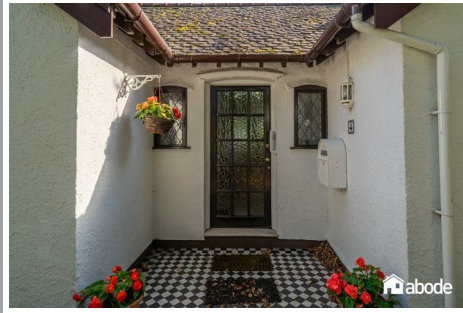

GROUND FLOOR 154.71 sq. m.
(1665.32 sq. ft.)

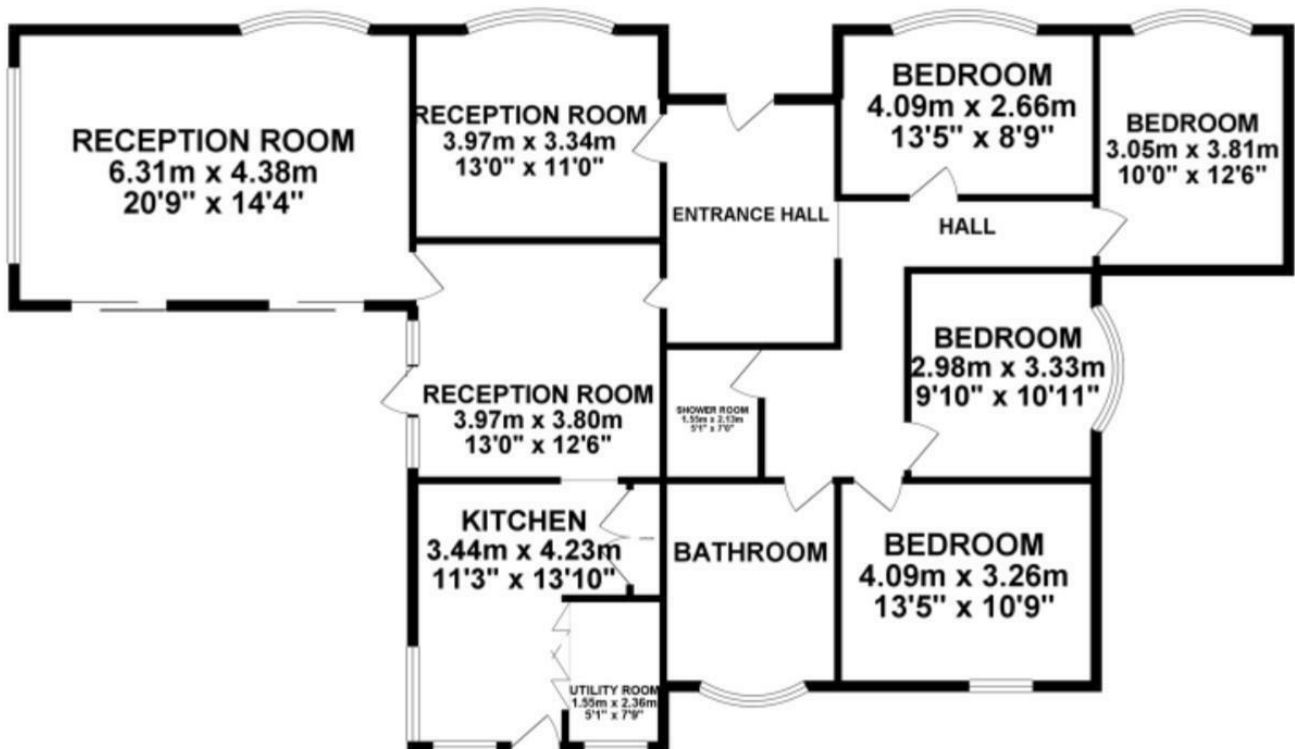

TOTAL FLOOR AREA : 154.71 sq. m. (1665.32 sq. ft.) approx.

Whilst every attempt has been made to ensure the accuracy of the floorplan contained here, measurements of doors, windows, rooms and any other items are approximate and no responsibility is taken for any error, omission or mis-statement. This plan is for illustrative purposes only and should be used as such by any prospective purchaser. The services, systems and appliances shown have not been tested and no guarantee as to their operability or efficiency can be given.
Made with Metropix ©2025

Tel: 01704827402



A map of the Little Altcar area in Merseyside, UK. The map shows a residential area with streets including Harrington Rd, Formby, Duke St, Church Rd, and Formby Bypass. A blue location pin is placed on Duke St, near the intersection with Formby. A black circular icon with a white 'M' is located on Duke St, just south of the pin. The map is labeled 'Little Altcar' in the bottom right. The Google logo is in the bottom left, and 'Map data ©2020' is in the bottom right.

- Abode Group (NW) company registration number 108862013