

The logo for Melvyn Danes Estate Agents is a yellow oval with a green border. Inside the oval, the word "melvyn" is written in a small, green, sans-serif font. Below it, the word "Danes" is written in a large, bold, green, sans-serif font. Underneath "Danes", the words "ESTATE AGENTS" are written in a smaller, green, sans-serif font.

melvyn
Danes
ESTATE AGENTS

A photograph of a two-story red brick house with a gabled roof and a chimney. The house has several white-framed windows, some with blinds. A paved path leads from the foreground to the house. The lawn is green with some fallen leaves. To the right, another brick house is partially visible.

Featherstone Crescent
Shirley
£895 Per Month

Description



Accommodation



BROADBAND: We understand that the standard broadband download speed at the property is around 12 Mbps, however please note that results will vary depending on the time a speed test is carried out. The estimated fastest download speed currently achievable for the property post code area is around 1800 Mbps. Data taken from checker.ofcom.org.uk on 02/03/2026. Actual service availability at the property or speeds received may be different.

MOBILE: Please refer to checker.ofcom.org.uk for mobile coverage at the property. This can vary depending on the network provider and other factors that can affect the local mobile reception and actual services available may be different depending on the particular circumstances, precise location and network outages.

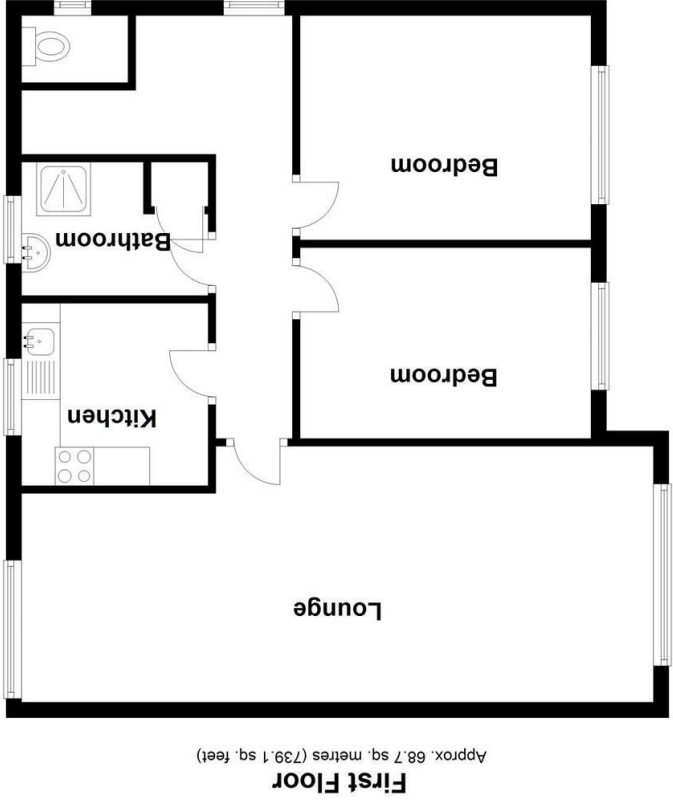
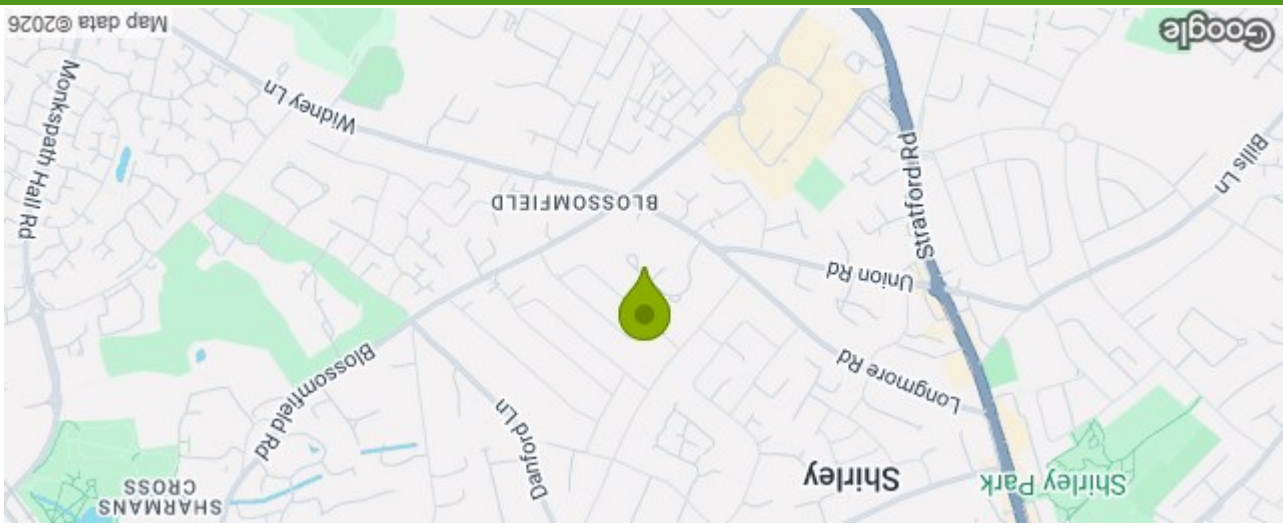

Total area: approx. 68.7 sq. metres (739.1 sq. feet)

**78 Featherstone Crescent Shirley Solihull B90 3RU
Council Tax Band: B**

Energy Efficiency Rating	
Potential	76
Current	75
Very energy efficient - lower running costs A (92 plus) B (81-91) C (69-80) D (55-68) E (39-54) F (21-38) G (1-20) Not energy efficient - higher running costs	
EU Directive 2002/91/EC England & Wales	

Please note that all measurements and floor plans are approximate and quoted for general guidance only and whilst every attempt has been made to ensure accuracy, they must not be relied on and do not form part of any contract.