



Bedstone Way, Farcet Peterborough  
**£350,000 Freehold**

**Sharman  
Quinney**

# Key Features



- Modern Detached Family Home
- Set Back from Main Road
- Four Bedrooms + En-Suite Shower Room
- Two Reception Rooms + Downstairs Cloakroom
- Kitchen/Breakfast Room + Utility Room

Great opportunity to purchase this Very Well Presented Modern Detached Family Home, benefits from being set back from the main road making and fronting onto an Open Green Area, good access to local bus route and schools, in brief the accommodation comprises of Entrance Hall with stairs to the first-floor landing, doors giving access to the Lounge, Separate Dining Room, Kitchen/Breakfast Room which has a range of fitted base and eye level units, cupboards and drawers, worktop space with a one and a quarter single drainer sink unit, plumbing for a dish washer, built-in gas hob, electric oven, extractor hood over, built-in fridge/freezer, French doors to the rear garden, door to the Utility Room which has a fitted worktop space, plumbing for a washing machine, space for a tumble dryer, door to the rear garden and a door to the Two Piece



Downstairs Cloakroom, Upstairs First Floor Landing has doors to Bedroom 1 which has fitted wardrobes with sliding doors, door to the Three Piece En-Suite Shower Room, Bedrooms 2,3 and 4 have front views over the open green area, Family Bathroom is with a three piece suite, Outside driveway provides Off Road Parking and leads to the Single Garage which has a courtesy door to the Enclosed Rear Garden which is laid mainly to lawn and a paved patio seating area.

Entrance Hall:  
Separate Lounge:  
Separate Dining Room:  
Kitchen/Breakfast Room:  
Utility Room:  
Downstairs Bathroom:  
First Floor Landing:  
Bedroom 1:  
En-Suite Shower Room:  
Bedroom 2:  
Bedroom 3:  
Bedroom 4:  
Family Bathroom:  
Single Garage:

All measurements are listed on the floor plan.



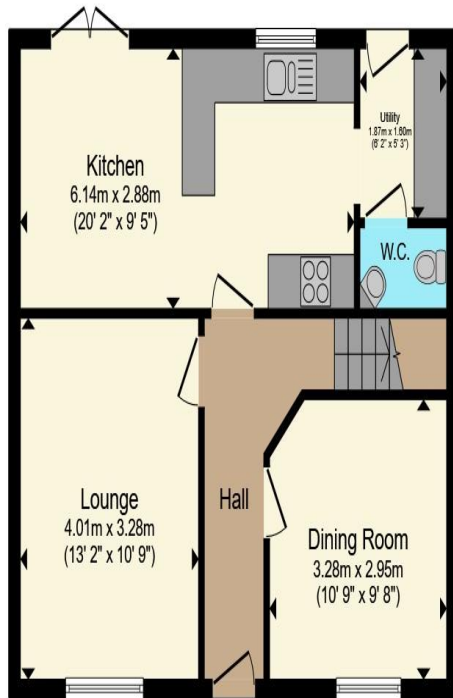

**Ground Floor**

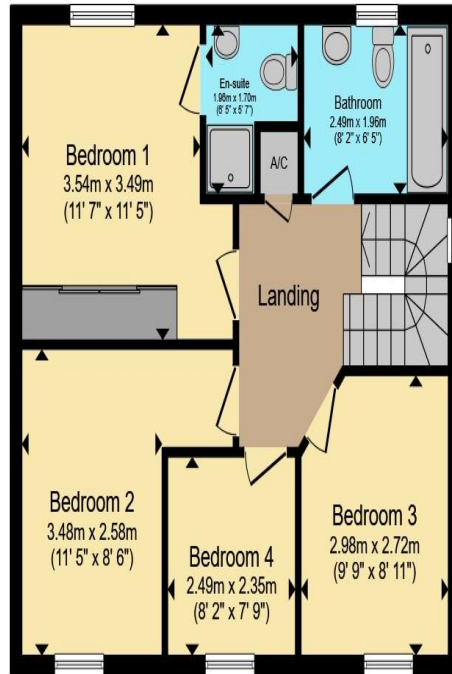

**First Floor**

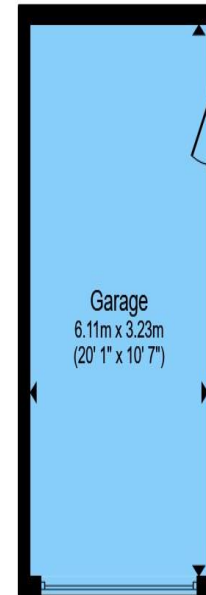

**Garage**

Total floor area 129.5 m<sup>2</sup> (1,394 sq.ft.) approx

This floor plan is for illustrative purposes only. It is not drawn to scale. Any measurements, floor areas (including any total floor area), openings and orientation are approximate. No details are guaranteed, they cannot be relied upon for any purpose and they do not form part of any agreement. No liability is taken for any error, omission or misstatement. A party must rely upon its own inspection(s). Powered by [www.propertybox.io](http://www.propertybox.io)

**Sharman  
Quinney**

To view this property call Sharman Quinney on:  
**01733 245400**

# Selling your property?

Contact us to arrange a **FREE** home valuation.

 01733 245400

 Unit 19 Maltings Square, Broadway Shopping Centre, Yaxley, Cambridgeshire, PE7 3EW

 yaxley@sharmanquinney.co.uk

 [www.sharmanquinney.co.uk](http://www.sharmanquinney.co.uk)



 SCAN ME



Sharman Quinney Holdings Limited is registered in England and Wales under company number 4174227, Registered Office is Cumbria House, 16-20 Hockliffe Street, Leighton Buzzard, Bedfordshire, LU7 1GN. VAT Registration Number is 500 2481 05.

1: These particulars do not constitute part or all of an offer or contract. 2: The measurements indicated are supplied for guidance only and as such must be considered incorrect. 3: Potential buyers are advised to recheck the measurements before committing to any expense. 4: Sharman Quinney has not tested any apparatus, equipment, fixtures, fittings or services and it is the buyers interests to check the working condition of any appliances. 5: Sharman Quinney has not sought to verify the legal title of the property and buyers must obtain verification from their legal representative. 6: Intending purchasers will be asked to produce identification documentation at a later stage and we would ask your co-operation in order that there will be no delay in agreeing the sale. Ref: YAX203654 - 0001

