



jordan fishwick

27 Lynwood Victoria Road, SK9 5HN
Guide Price £139,950



Victoria Road Wilmslow SK9 5HN

Guide Price £139,950



Jordan Fishwick are pleased to offer this beautifully presented second floor apartment, located in the heart of Wilmslow. This retirement (Over 60's) apartment offers excellent accommodation for those wanting to be a stone's throw away from local amenities including a range of shops, general services and restaurants. Lynwood is linked via a glass atrium to its sister building Beechfield and the combined developments have two communal lounges, a communal lift and a range of organized activities. The development also offers well maintained communal garden spaces and on-site laundry facilities. The apartment itself, comprises a private entrance hallway with ample storage, contemporary shower room and generous sized main bedroom with feature window. Furthermore, the beautifully presented kitchen offers modern style wall and base mounted units, complimentary worktops and a handful of integrated appliances. Adjoining to the kitchen, the living / dining room offers an excellent socialising space and is complemented by a further feature window, offering a unique nook. Viewings Essential.



- Over 60's Apartment
- Beautiful Communal Areas
- Central Wilmslow Location
- Lift Access
- Modernised Apartment
- Shower Room
- Contemporary Kitchen



Energy Efficiency Rating		
	Current	Potential
Very energy efficient - lower running costs		
(92 plus) A		
(81-91) B		
(69-80) C	76	78
(55-68) D		
(39-54) E		
(21-38) F		
(1-20) G		
Not energy efficient - higher running costs		
England & Wales	EU Directive 2002/91/EC 	



GROUND FLOOR

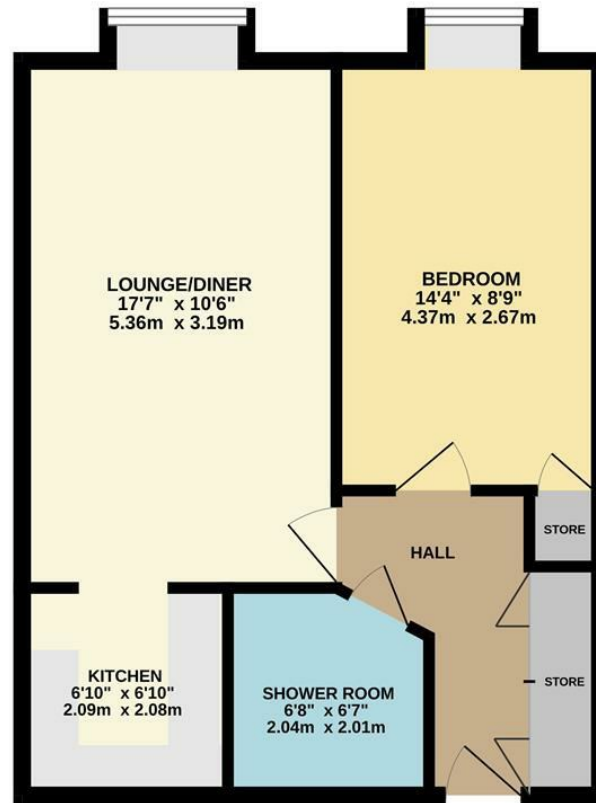

Measurements are approximate. Not to scale. Illustrative purposes only.
Made with Metropix ©2025



These particulars are believed to be accurate but they are not guaranteed and do not form a contract. Neither Jordan Fishwick nor the vendor or lessor accept any responsibility in respect of these particulars, which are not intended to be statements or representations of fact and any intending purchaser or lessee must satisfy himself by inspection or otherwise as to the correctness of each of the statements contained in these particulars. Any floorplans on this brochure are for illustrative purposes only and are not necessarily to scale.

Offices at: Chorlton, Didsbury, Disley, Hale, Glossop, Macclesfield, Manchester Deansgate, Manchester Whitworth Street, New Mills, Sale, Wilmslow and Withington

36-38 Alderley Road, Wilmslow SK91JX
01625 532000

wilmslow@jordanfishwick.co.uk
www.jordanfishwick.co.uk