

Towers Wills

Town & Country

📞 01935 577 032 | 01460 298 530 | ✉ info@towerswills.co.uk



22, Gainsborough Way, Yeovil, Somerset BA21 5XT

Offers Over £180,000

Towers Wills welcome to the market Gainsborough Way, a beautifully presented two-bedroom end-terrace home in a popular Yeovil location, ideal for first-time buyers or investors. Offering a porch, open-plan lounge diner, modern fitted kitchen, two double bedrooms and a contemporary modern shower room. Outside benefits from parking for three vehicles and an enclosed rear garden with patio. A smart, turn key condition home with excellent appeal.

Accommodation:

Positioned within a popular residential area of Yeovil, Gainsborough Way is a beautifully presented two-bedroom end-terrace home offering stylish, low-maintenance living — perfect for first-time buyers stepping onto the ladder or investors seeking a buy-to-let opportunity.

The property welcomes you via a useful entrance porch, opening into a bright and spacious open-plan lounge diner — an ideal social space for relaxing evenings or entertaining friends. The modern kitchen is thoughtfully designed and fitted with a comprehensive range of wall, base and drawer units, work surfaces with inset stainless steel sink/drainers, integrated electric oven and hob with cooker hood over, and tiling to splash-prone areas. Plumbing for a washing machine and dishwasher, space for a fridge/freezer and tumble dryer, tiled flooring, and a double glazed door leading directly onto the rear garden.

Upstairs, the property continues to impress with two well-proportioned double bedrooms and a contemporary shower room comprising a shower cubicle, wash hand basin, WC, heated towel rail, extractor fan and part tiling — finished in a modern style.

Outside:

Externally, the home offers excellent convenience. The front garden area has been laid to resin surfacing. Allocated parking for three vehicles — a rare and valuable feature for a property of this type. To the rear, the enclosed garden is predominantly laid to lawn with a patio area perfect for outdoor dining, along with gated side access, creating a safe and private space to enjoy.

A superb combination of presentation, practicality and parking — this is a ready-to-move-into home in a sought-after Yeovil location.

Key Features

- Well Presented Throughout
- Two Double Bedrooms
- End of Terrace
- Off Road Parking for Three Vehicles
- Enclosed Rear Garden

Contact Us

Towers Wills Estate Agents - Yeovil

114, Hendford Hill
Yeovil

Somerset
BA202RF

T: 01935 577032

E: info@towerswills.co.uk

Energy Efficiency

Score	Energy rating	Current	Potential
92+	A		
81-91	B		86 B
69-80	C		
55-68	D	66 D	
39-54	E		
21-38	F		
1-20	G		



Floor Plan

GROUND FLOOR

1ST FLOOR

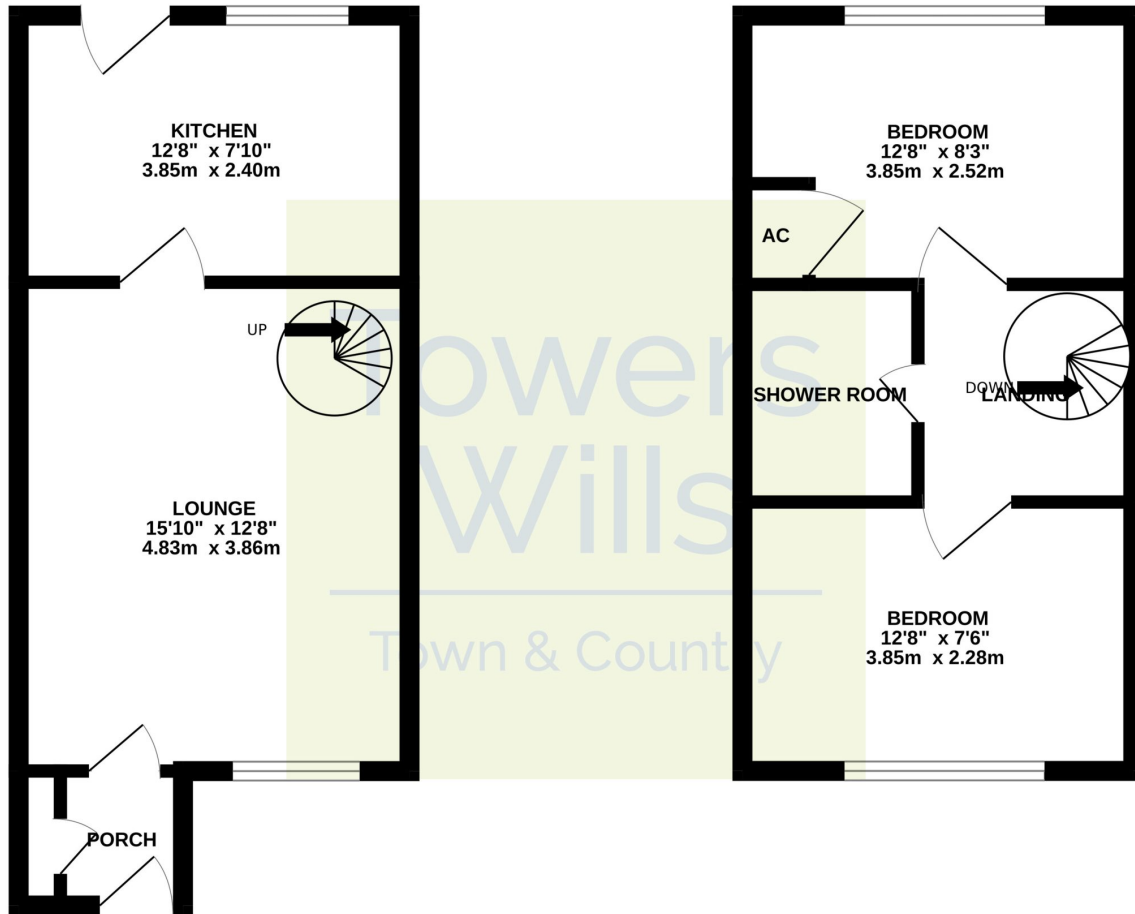

Whilst every attempt has been made to ensure the accuracy of the floorplan contained here, measurements of doors, windows, rooms and any other items are approximate and no responsibility is taken for any error, omission or mis-statement. This plan is for illustrative purposes only and should be used as such by any prospective purchaser. The services, systems and appliances shown have not been tested and no guarantee as to their operability or efficiency can be given.
Made with Metropix ©2026

Please Note No tests have been undertaken of any of the services and any intending purchasers should satisfy themselves in this regard. Towers Wills Ltd for themselves and for the vendor of this property whose agents they are, give notice that, (i) these particulars do not constitute any part of an offer or contract, (ii) all statements contained within these particulars are made without responsibility on the part of Towers Wills or the vendor, (iii) whilst made in good faith, none of the statements contained within these particulars are to be relied upon as a statement of representation or fact, (iv) any intending purchaser must satisfy him/herself by inspection or otherwise as to the correctness of each of the statements contained within these particulars, (v) the vendor does not make or give either Towers Wills or any person in their employment any authority to make or give representation or warranty whatsoever in relation to this property.

Photographs / Floor Plans Photographs are reproduced for general information and it must not be inferred that any item is included for sale with this property. Please note floor plans are not to scale and are for identification purposes only. The photographs used in these particulars may have been taken with the use of a wide angle lens. If you have any queries as to the size of the accommodation or plot, please address these with the agent prior to making an appointment to view

Towers Wills

The White House, 114 Hendford Hill, Yeovil BA20 2RF

Yeovil 01935 577032 / South Petherton 01460 298530

info@towerswills.co.uk | www.towerswills.co.uk