



Cardross Street W6



# Cardross Street W6

**1 BEDROOM FLAT  
CLOSE TO RAVENSCOURT PARK  
NEAR TRANSPORT  
PRIVATE GARDEN  
FITTED KITCHEN  
EPC BAND C  
AVAILABLE 24TH JUNE  
COUNCIL TAX BAND D**

A lovely, large ground floor 1 bedroom flat with a double bedroom area leading into the reception, family bathroom and kitchen/dining room leading onto the big private garden. The flat is well located for Ravenscourt Park and Hammersmith. Unfurnished, available 24th June.

**£519 PER WEEK**

**SUBJECT TO CONTRACT**





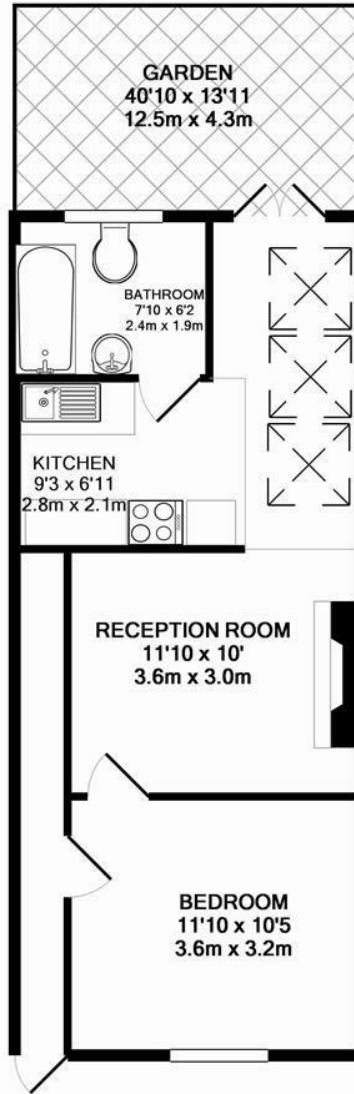

GROUND FLOOR FLAT, 15 CARDROSS STREET, LONDON W6 0DP  
TOTAL APPROX. FLOOR AREA 472 SQ.FT. (43.8 SQ.M.)

Whilst every attempt has been made to ensure the accuracy of the floor plan contained here, measurements of doors, windows, rooms and any other items are approximate and no responsibility is taken for any error, omission, or mis-statement. This plan is for illustrative purposes only and should be used as such by any prospective purchaser. The services, systems and appliances shown have not been tested and no guarantee as to their operability or efficiency can be given  
Made with Metropix ©2010