



TAVISTOCK ROAD, W11

£2,700 per month

One bedroom
Eat-in kitchen
High ceilings
Close to Westbourne Park
Raised Ground Floor
Washer Dryer

@marshandparsons
marshandparsons.co.uk

MARSH &
PARSONS



ABOUT THE PROPERTY

A newly renovated raised ground floor one bedroom property situated in a charming Victorian conversion in the heart of Notting Hill. Featuring high ceilings throughout, the property offers a generous reception room with a bay window at the front, creating an inviting and light-filled living space. To the rear, a bright eat-in kitchen provides the perfect setting for meals and entertaining. A peaceful double bedroom is accompanied by a sleek, modern bathroom, completing this elegant home.

Westbourne Park Underground station on the Circle and Hammersmith & City lines is just around the corner and Ladbrooke Grove, Westbourne Grove and Portobello Road



STEP INSIDE TAVISTOCK ROAD

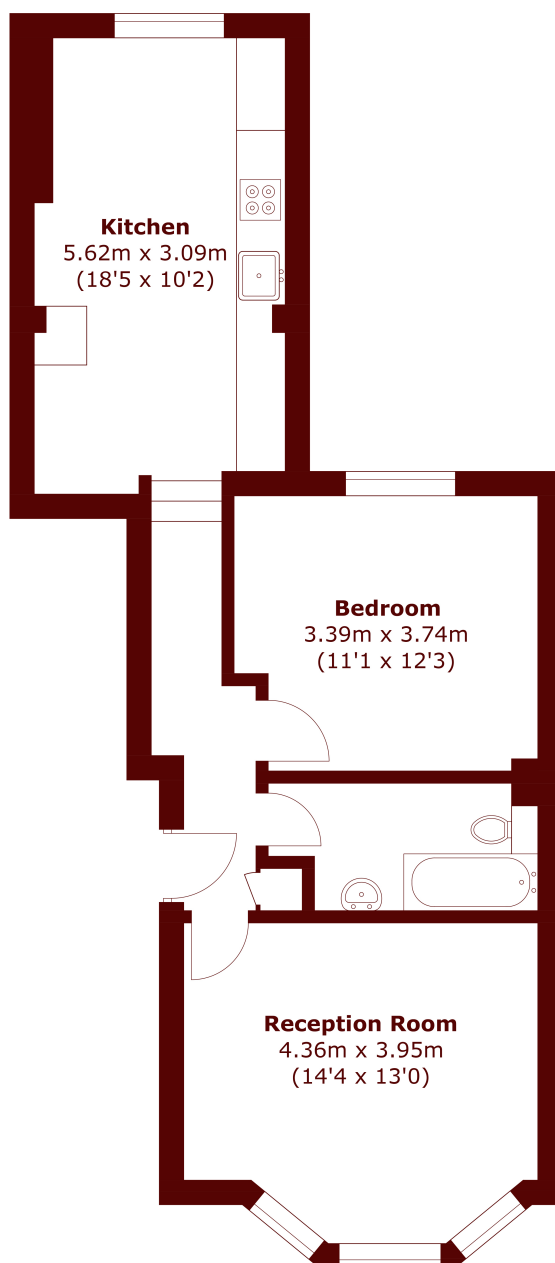

Total area (approx.): 56.4 sq. m (606.6 sq. ft)

North Kensington
020 7871 5050

Energy Rating: C We aim to make our particulars both accurate and reliable. However, they are not guaranteed; nor do they form part of an offer or contract. If you require clarification on any points then please contact us, especially if you're traveling some distance to view. Please note that appliances and heating systems have not been tested and therefore no warranties can be given as to their good working order

MARSH &
PARSONS