



Camden Road, NW1

£325,000



- No Onward Chain
- Share of Freehold

- One Bedroom
- Fitted Kitchen

- Lift Assisted
- Close to Camden Market

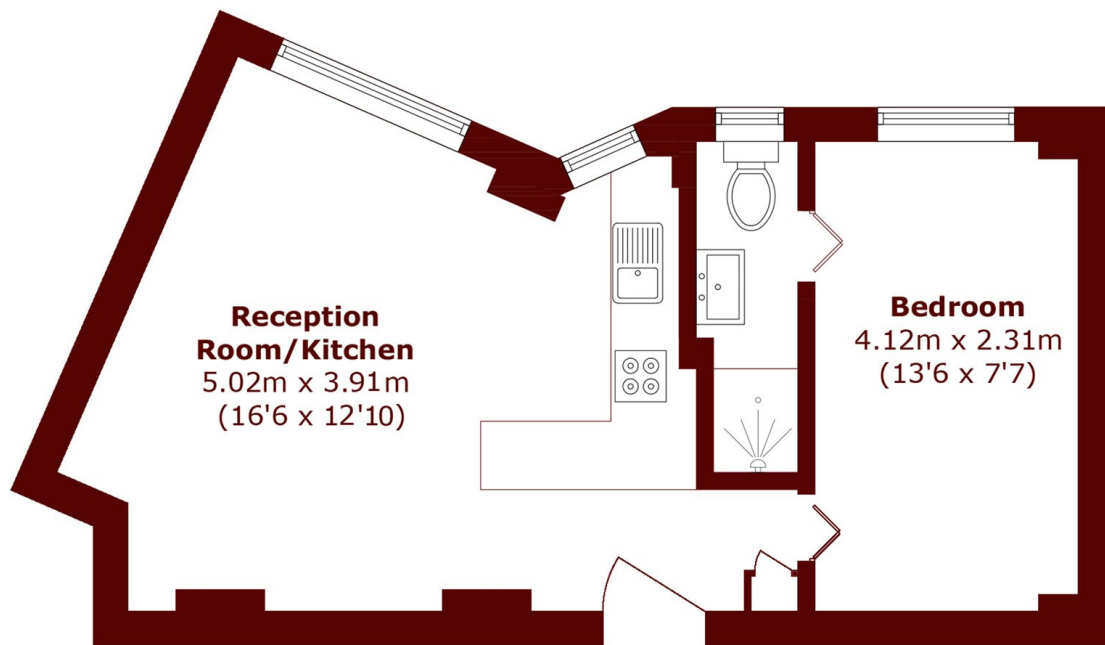

Total area (approx.): 34.6 sq. m (372.4 sq. ft)

Marsh & Parsons Camden

27 Parkway, London, NW1
7PN
020 7244 2200