



Aries Lane, Sherford Plymouth PL9 8FD

welcome to

Aries Lane, Sherford Plymouth

WOW! Fox and sons are pleased to present this exceptional 5 DOUBLE BEDROOM, MODERN, 3 storey, SEMI-DETACHED, townhouse in SHERFORD, PLYMOUTH. This is a MUST VIEW, so call today to book your slot!



Entrance Hall

As you enter this stunning property, you are met with a wide and open hallway. With access to the study, lounge, kitchen, 2 storage cupboards, a W/C and the stairs to the first floor.

Study

14' 2" x 6' (4.32m x 1.83m)

Currently used as an office space, this room is large in length, with 3 double glazed sash windows, fitted blinds and a radiator.

Lounge

17' 2" x 11' 6" (5.23m x 3.51m)

Bright, open and a fantastic space, this lounge has sash double glazing, a radiator and french doors to the garden with fitted blinds.

Open Plan Kitchen And Dining

23' 7" x 11' 7" (7.19m x 3.53m)

With sash double glazing to the front and fitted blinds, the kitchen offers ample of storage options. Integrated fridge, freezer, dish washer, hob and cooker. Towards to rear, there is another set of french doors to the garden and access to the utility room on the left.

Utility Room

Plumbing for a washing machine and storage.

W/C

W/C, hand was basin, radiator and extractor fan.

First Floor Landing

Access to bedroom 1,2,3 and the bathroom.

Bedroom 1

15' 4" x 11' 7" (4.67m x 3.53m)

That master bedroom with an en-suite. Sash windows to the rear and a radiator.

En Suite

Frosted sash double glazing window, shower, W/C, vanity sink, radiator and extractor fan.

Bedroom 2

15' 6" x 10' 3" (4.72m x 3.12m)

A very bright room, double aspect with 3 sash double glazed windows and a radiator and fitted blinds.

Bedroom 3

12' 6" x 11' 6" (3.81m x 3.51m)

Another double aspect room with 2 sash double glazed windows with fitted blinds and a radiator.

Bathroom

The main bathroom is located on the first floor, with a bath and separate shower, vanity sink, W/C, electric socket, frosted sash double glazing and an extractor fan.

Second Floor Landing

With access to the shower room, bedroom 4 and 5.

Bedroom 4

16' 10" Max x 12' (5.13m Max x 3.66m)

A double glazed sash window and radiator. A large bedroom situated on the top floor.

Shower Room

Frosted double glazed window, shower, hand was basin, W/C and radiator.

Bedroom 5

16' x 11' (4.88m x 3.35m)

Sash double glazed window and radiator. Currently used as a storage room, this room completed the 5 double bedrooms.

Garden

A mix of patio and artificial grass, this garden is cozy and catches the sun well. This garden is also enclosed with a rear gate leading to the garage and drive.

Garage

Drive



view this property online fox-and-sons.co.uk/Property/PYP104467



welcome to

Aries Lane, Sherford Plymouth

- 5 Double Bedrooms
- Drive & Garage
- Enclosed Rear Garden
- Sherford Location
- En-Suite

Tenure: Freehold EPC Rating: B
Council Tax Band: E

guide price

£450,000



Ground Floor



First Floor

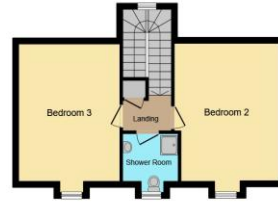

Second Floor

This floor plan is for illustrative purposes only. It is not drawn to scale. Any measurements, floor areas (including any total floor area), openings and orientation are approximate. No details are guaranteed, they cannot be relied upon for any purpose and they do not form part of any agreement. No liability is taken for any error, omission or misstatement. A party must rely upon its own inspection(s). Powered by www.foxagent.com



Please note the marker reflects the postcode not the actual property

view this property online fox-and-sons.co.uk/Property/PYP104467



Property Ref:
PYP104467 - 0008

1. MONEY LAUNDERING REGULATIONS Intending purchasers will be asked to produce identification documentation at a later stage and we would ask for your co-operation in order that there is no delay in agreeing the sale. 2. These particulars do not constitute part or all of an offer or contract. 3. The measurements indicated are supplied for guidance only and as such must be considered incorrect. Potential buyers are advised to recheck measurements before committing to any expense. 4. We have not tested any apparatus, equipment, fixtures or services and it is in the buyers interest to check the working condition of any appliances. 5. Where an EPC, or a Home Report (Scotland only) is held for this property, it is available for inspection at the branch by appointment. If you require a printed version of a Home Report, you will need to pay a reasonable production charge reflecting printing and other costs. 6. We are not able to offer an opinion either written or verbal on the content of these reports and this must be obtained from your legal representative. 7. Whilst we take care in preparing these reports, a buyer should ensure that his/her legal representative confirms as soon as possible all matters relating to title including the extent and boundaries of the property and other important matters before exchange of contracts.

fox & sons



01752 344349



plympton@fox-and-sons.co.uk



143 Ridgeway, Plympton, PLYMOUTH, Devon,
PL7 2HJ



fox-and-sons.co.uk