



## Kilburn Park Road, NW6

### £400,000

A large, modern flat in a white stucco-fronted Maida Vale conversion. Offering one double bedroom, an oversized open plan kitchen/reception with newly integrated Zanussi appliances, and a storage room, the property also benefits from a private entrance and outdoor space. Perfect for single professionals and available chain-free.

Kilburn Park Road enjoys a prime location within easy reach of Kilburn Park underground station (Bakerloo line), Kilburn High Road Overground Station (Lioness and Mildmay lines), and the amenities of Maida Vale, including Paddington Recreation Ground.

### Features

- Private Front & Rear Patio
- Laura Ashley Wooden Floors
- Private Entrance
- Chain Free
- Great Transport Links
- White-Stucco Fronted

# Kilburn Park Road, London, NW6

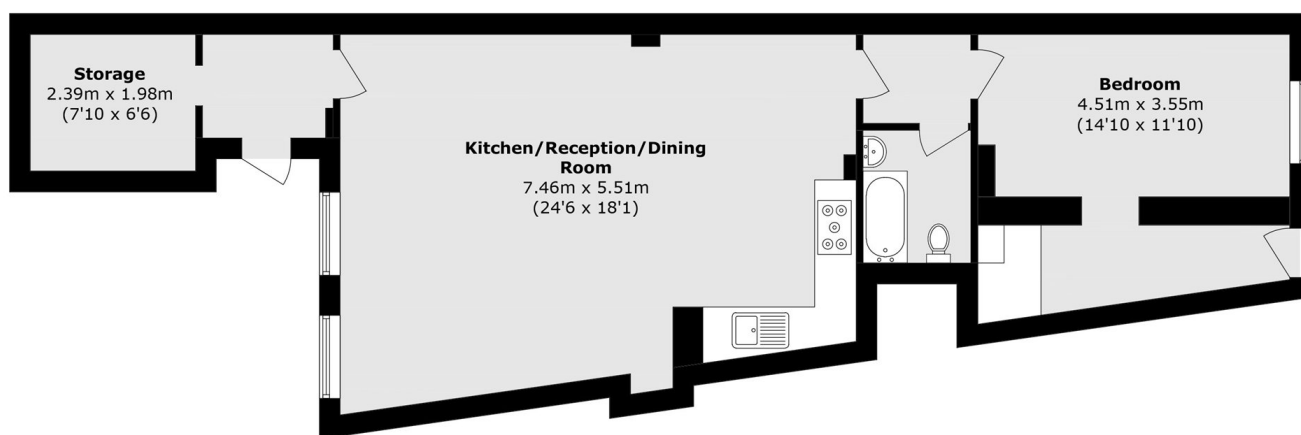

Total area (approx.): 68.0 sq. m (731.9 sq. ft)