

Mike
Dobson



1A Goosefield Rise

Garforth, Leeds, LS25 1BY

£200,000

1A Goosefield Rise

Welcome to this charming three-bedroom terraced house located on Goosefield Rise in the desirable area of Garforth, Leeds. This delightful property offers a perfect blend of modern living and traditional comfort, making it an ideal home for families or professionals alike.

As you enter, you are greeted by a spacious reception room that provides a warm and inviting atmosphere, perfect for relaxing or entertaining guests. The heart of the home is the well-appointed Kitchen/Diner, which features a convenient pantry for additional storage. This space is designed for both cooking and dining, allowing for enjoyable family meals or gatherings with friends.

The property boasts three good sized bedrooms, providing ample space for rest and relaxation. The bathroom is complemented by a separate WC, ensuring convenience for busy mornings.

Outside, the rear garden is a true highlight, featuring a lawn and a patio area, ideal for alfresco dining or simply enjoying the fresh air. There is also a gateway opening to a alley which leads to the front of the property. The front garden adds to the property's curb appeal, creating a welcoming entrance.

On-street parking is available, making it easy for you and your guests to come and go. With its modern interior and thoughtful layout, this terraced house is ready to be transformed into your new home. Don't miss the opportunity to view this lovely property in a sought-after location.





Floor Plan

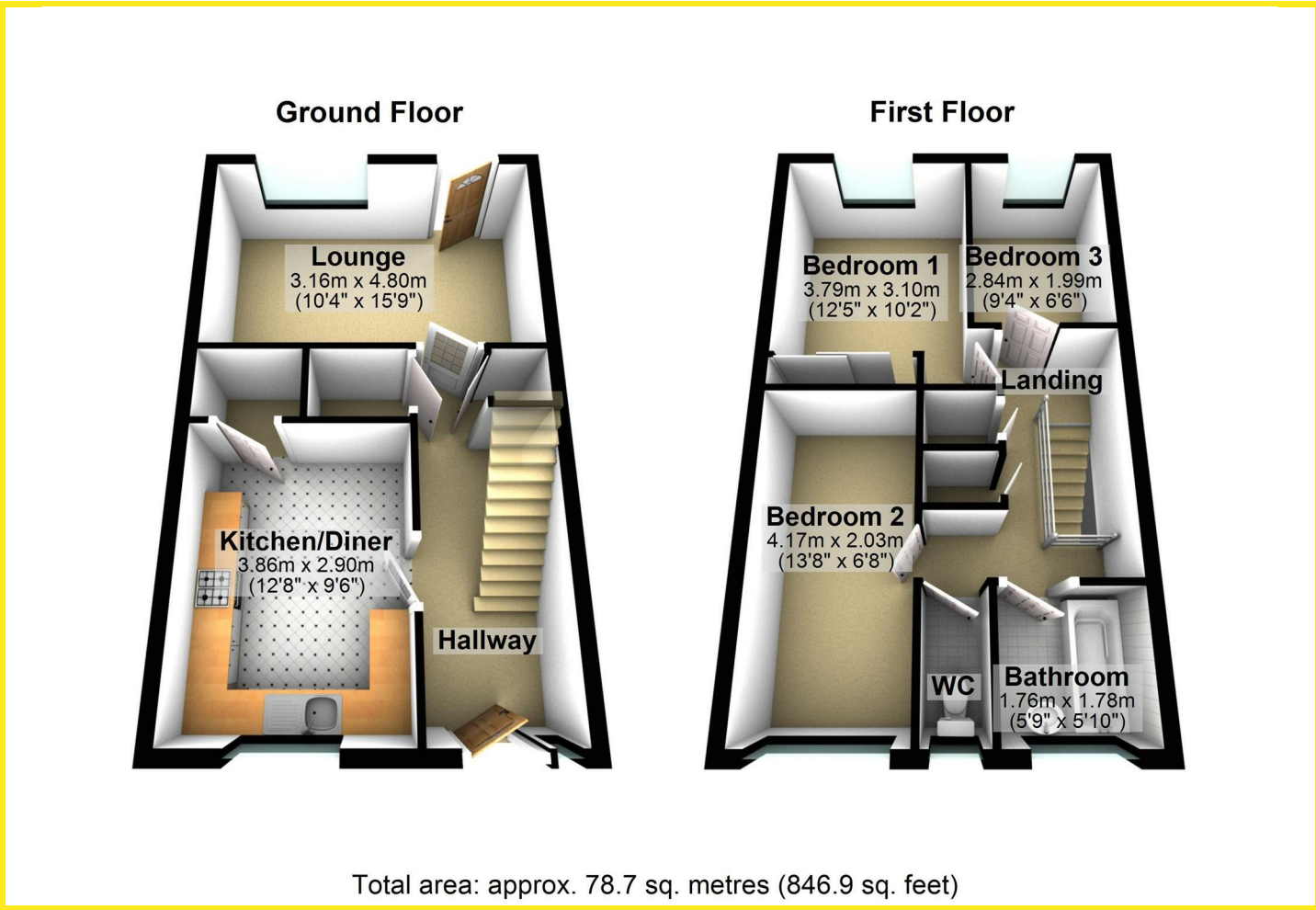

Area Map



Energy Efficiency Graph

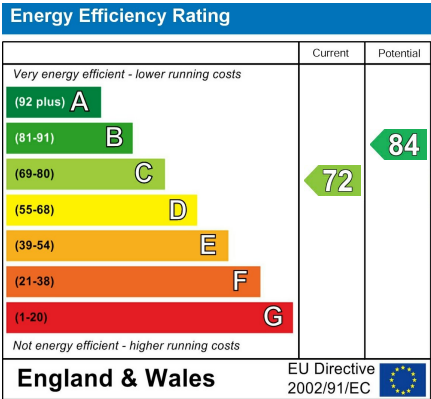

Directions