



Rosewood Terrace
Exeter EX4 6JE

for sale guide price
£220,000



Property Description

GUIDE PRICE £220,000 - £230,000

A 2 bedroom MID TERRACED HOUSE located within walking distance of EXETER CITY CENTRE, University and transport links. The home is in immaculate condition and ready to move into and is a great starter home or investment. Outside there is a courtyard garden all enclosed and a lovely tranquil space to enjoy dining in the summer evenings. The accommodation comprises:- Entrance hallway, lounge, kitchen, first floor landing, 2 bedrooms and Jack and Jill bathroom/WC.



Entrance Hall

Door to front, wall mounted radiator.

Living Room

10' 3" x 9' 7" into recess (3.12m x 2.92m into recess)

Double glazed front aspect window, brick built fireplace with gas fire.

Kitchen

13' into recess x 9' 8" (3.96m into recess x 2.95m)

Double glazed rear aspect window, double glazed rear aspect French doors, base units, wall unit housing boiler, plumbing for washing machine, plumbing for dish washer, work surfaces, stainless steel sink unit, gas cooker point with extractor over, tiling, storage cupboard, space for fridge freezer, under stairs storage, brick built feature fireplace, wall mounted radiator.

Bedroom 1

10' 10" max x 13' 1" into recess (3.30m max x 3.99m into recess)

Double glazed front aspect window, wooden flooring, storage cupboard, wall mounted radiator.

Jack And Jill Bathroom

Double glazed obscured rear aspect window, bath with shower attachment, low level toilet, wash hand basin, tiling, wooden flooring.

Bedroom 2

9' 5" x 8' 5" into recess (2.87m x 2.57m into recess)

Double glazed rear aspect window, fireplace, shelving, wall mounted radiator.

Rear Courtyard

Brick built storage, plum tree, blackcurrant bush, herbs, all enclosed.







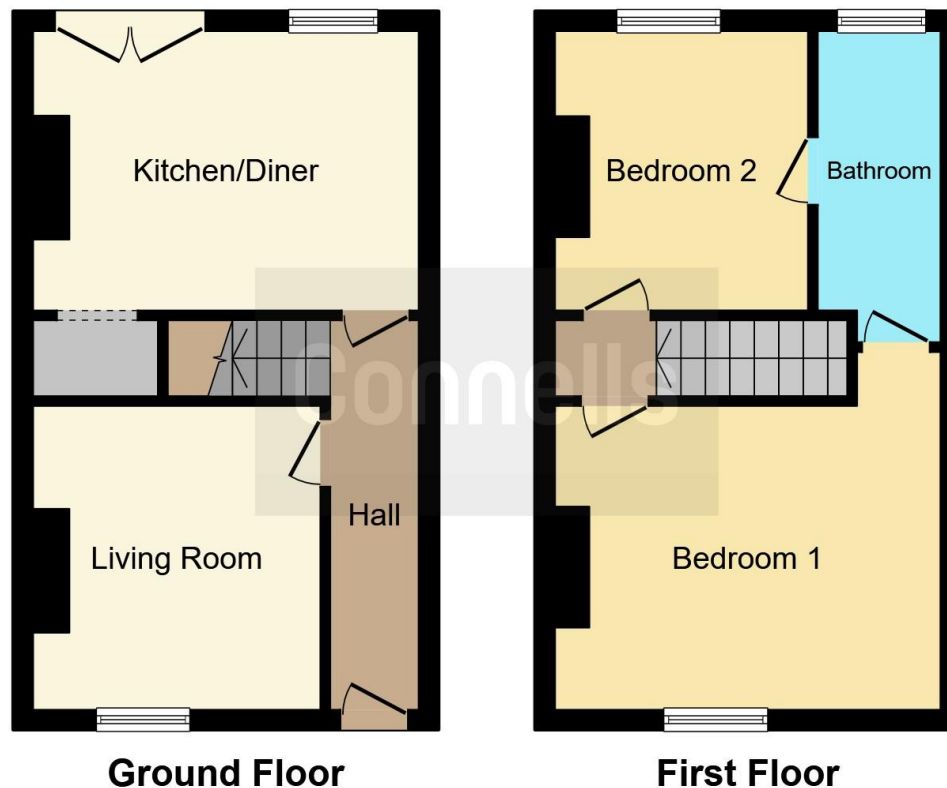

This floor plan is for illustrative purposes only. It is not drawn to scale. Any measurements, floor areas (including any total floor area), openings and orientation are approximate. No details are guaranteed, they cannot be relied upon for any purpose and they do not form part of any agreement. No liability is taken for any error, omission or misstatement. A party must rely upon its own inspection(s). Powered by www.focalagent.com

To view this property please contact Connells on

T 01392 221 331
E exeter@connells.co.uk

8-9 South Street
 EXETER EX1 1DZ

EPC Rating: C Council Tax
 Band: B

Tenure: Freehold

view this property online connells.co.uk/Property/EXR317244



1. MONEY LAUNDERING REGULATIONS Intending purchasers will be asked to produce identification documentation at a later stage and we would ask for your co-operation in order that there will be no delay in agreeing the sale. 2. These particulars do not constitute part or all of an offer or contract. 3. The measurements indicated are supplied for guidance only and as such must be considered incorrect. Potential buyers are advised to recheck measurements before committing to any expense. 4. We have not tested any apparatus, equipment, fixtures, fittings or services and it is in the buyers interest to check the working condition of any appliances.

Connells Residential is registered in England and Wales under company number 1489613, Registered Office is Cumbria House, 16-20 Hockliffe Street, Leighton Buzzard, Bedfordshire, LU7 1GN. VAT Registration Number is 500 2481 05.

See all our properties at www.connells.co.uk | www.rightmove.co.uk | www.zoopla.co.uk

Property Ref: EXR317244 - 0003