



116 Ireland Crescent, Leeds, LS16 6SZ

Price Guide £106,950



## Floor Plan

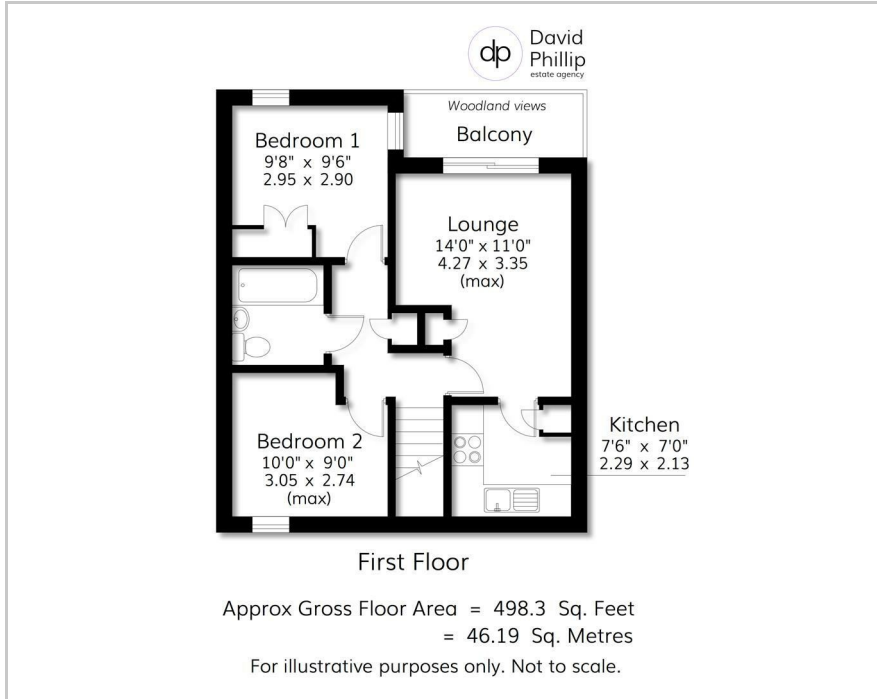

## Area Map

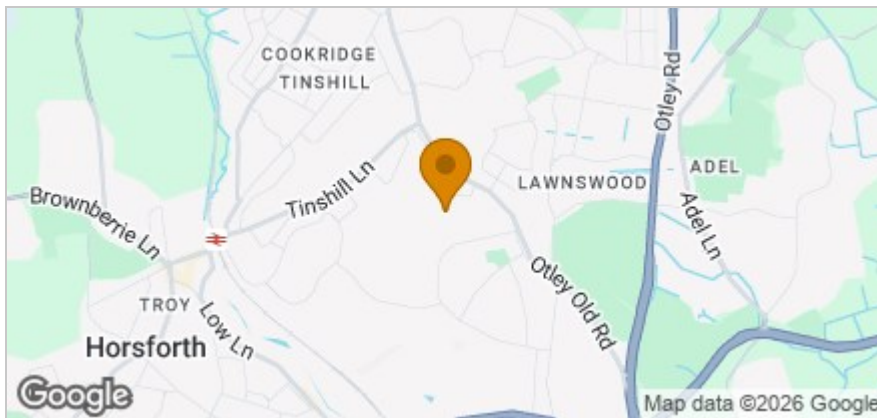

## Accommodation

- An Attractive Purpose Built First Floor Apartment
- Two Double Bedrooms and an Electric Stairlift
- Lounge incorporating Dining Area and Kitchen with Appliances
- Well Maintained Communal Gardens and On-Site Parking
- Over 60's Only with 24 Hour Care System
- Within a Quiet and Tranquil Setting Close to Amenities
- Energy Performance Certificate (EPC) Rating C
- Leeds City Council Tax Band B

## Viewing

Please contact our David Phillip Estate Agents Office on 01134 676 400 if you wish to arrange a viewing appointment for this property or require further information.

## Energy Efficiency Graph

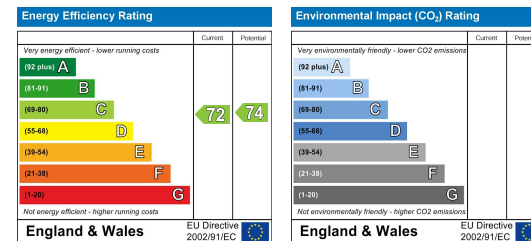

These particulars, whilst believed to be accurate are set out as a general outline only for guidance and do not constitute any part of an offer or contract. Intending purchasers should not rely on them as statements of representation of fact, but must satisfy themselves by inspection or otherwise as to their accuracy. No person in this firm's employment has the authority to make or give any representation or warranty in respect of the property.