



BRACKEN HOUSE, E3

£2,500 PER MONTH

- Three double bedrooms
- External storage cupboard
- Unfurnished
- Top floor (no lift)
- Communal garden
- Resident Parking Permits (by application)

wj.
meade

Bracken House

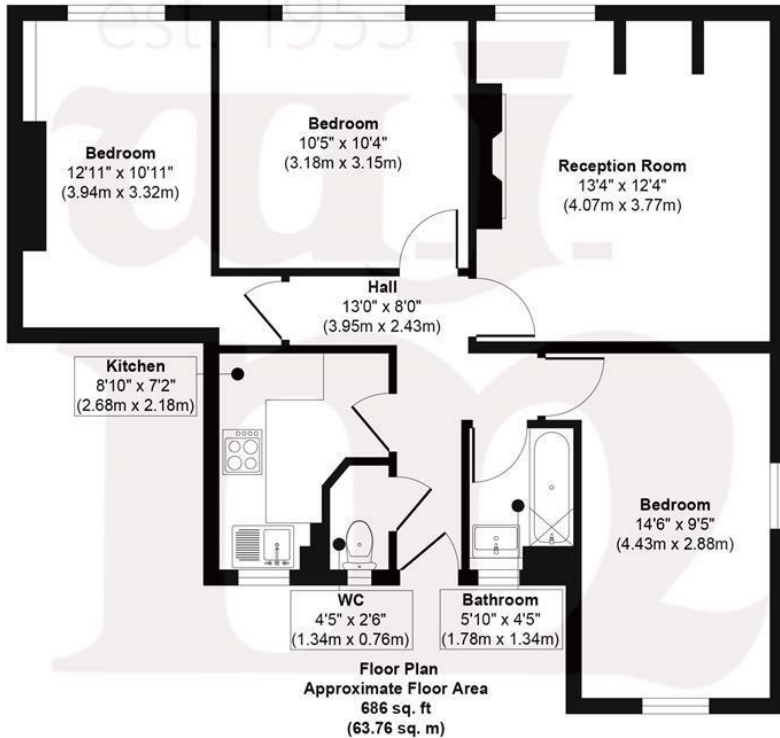

Approx. Gross Internal Floor Area 686 sq. ft / 63.76 sq. m
 Illustration for identification purposes only, measurements are approximate, not to scale.
 Produced by Elements Property



WJ Meade are pleased to offer this three bedroom flat on the top floor of a secure ex-council block. Arranged with a small galley kitchen, bathroom with separate toilet, reception room and external storage cupboard ideal for bikes. Situated in a small estate just off of Devons Road, close to the DLR station as well as bus links to Canary Wharf.

All sizes are approximate. The Agent has not tested any apparatus, equipment, fixtures and fittings, or services and so cannot verify that they are in working order or fit for the purpose. A buyer is advised to obtain verification from their Solicitors or Surveyor. Photographs are for illustration purposes only and may depict items, which are not for sale or included in the sale price. References to tenure of a property are based upon information supplied by the vendor. The agent has not had sight of the title documents, a buyer is advised to obtain verification from their solicitor. Money Laundering Regulations 2003: Intending purchasers will be asked to produce identification, documentation at a later stage and we would ask for your co-operation in order that there will be no delay in agreeing the sale.

These particulars are intended to give a fair description of the property only and are in no way guaranteed, nor do of any contract. They are issued on the express condition that all negotiations are conducted through W.J. Meade Estate Agents. All subject to contract and to being unsold.

Service charge £n/a
 Ground rent £n/a
 Reserve fund £n/a
 n/a years lease
 Council tax band B
 Current EPC Rating 53
 Tenure:

